

# INDUSTRIAL/WAREHOUSE SPACE FOR LEASE



47 ANTARES DRIVE, OTTAWA, ON



**JENNINGS**  
**REAL ESTATE**  
BROKERAGE INC.

# OFFERING SUMMARY

AVAILABILITY	SPACE USE	SIZE	NET RENT	ADDIT. RENT
Immediate	Industrial/Warehouse	Up to 41,460 SF	\$13.50 PSF	\$8.06 PSF + utilities (2025 Est.)

## PROPERTY HIGHLIGHTS

- The demising options are as follows: **8,000 SF**, **8,475 SF** and **24,985 SF**. Can be combined to **32,985 SF** or **41,460 SF**
- Conveniently located along Hunt Club Road, just minutes from the Ottawa International Airport
- Completely air-conditioned building
- Two 12' x 12' oversized grade level loading doors, with interior dock levelers
- Two regular 8' x 8' grade-level doors
- 16' clear height to underside of beam, 18' clear height to roof joist
- Building is serviced by 1000kVA transformer with a main breaker rated at 1200amps 347/600v
- Fully sprinklered building

# 47 ANTARES DRIVE







# FLOOR PLAN

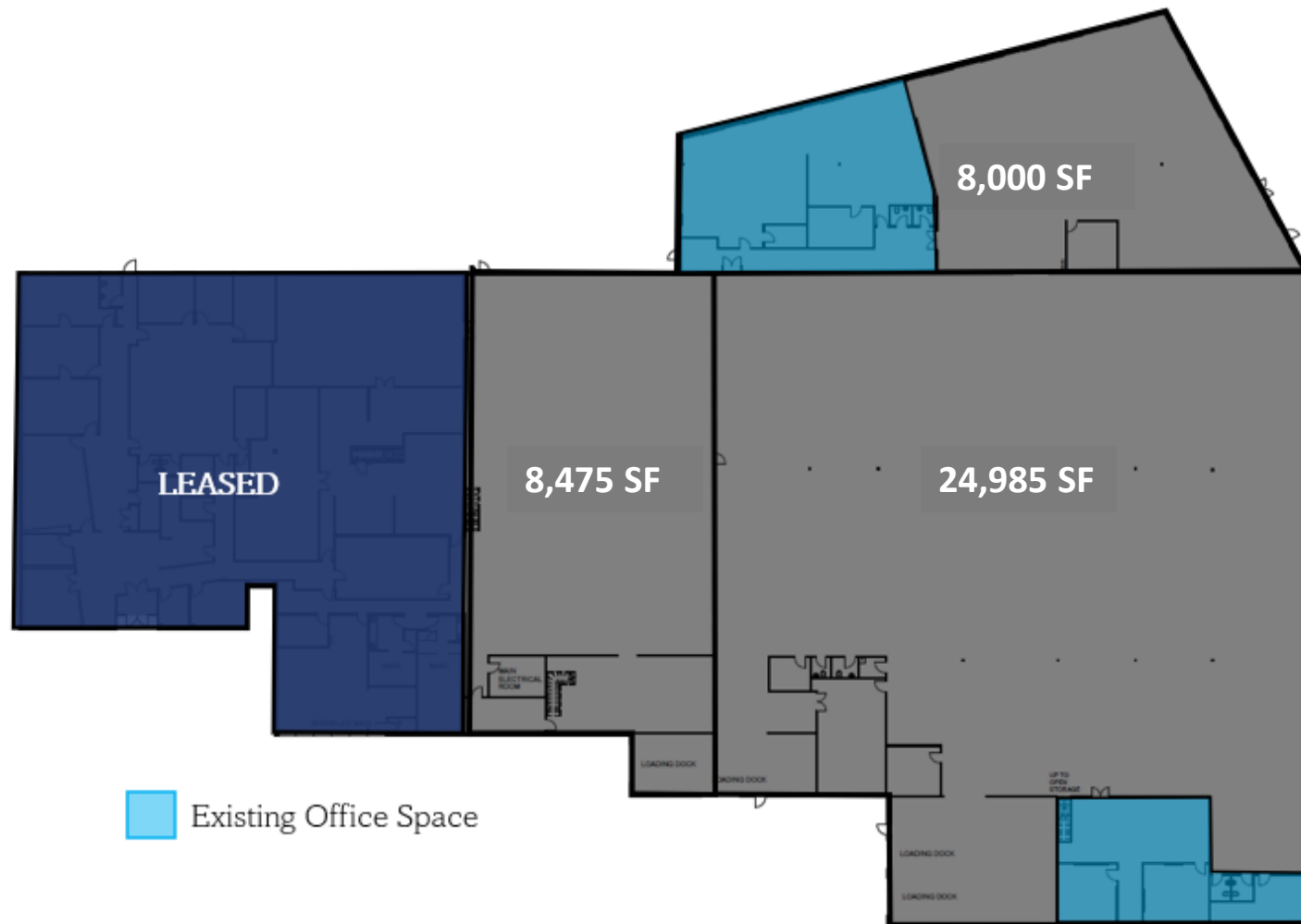

## 47 ANTARES DRIVE

# MAP

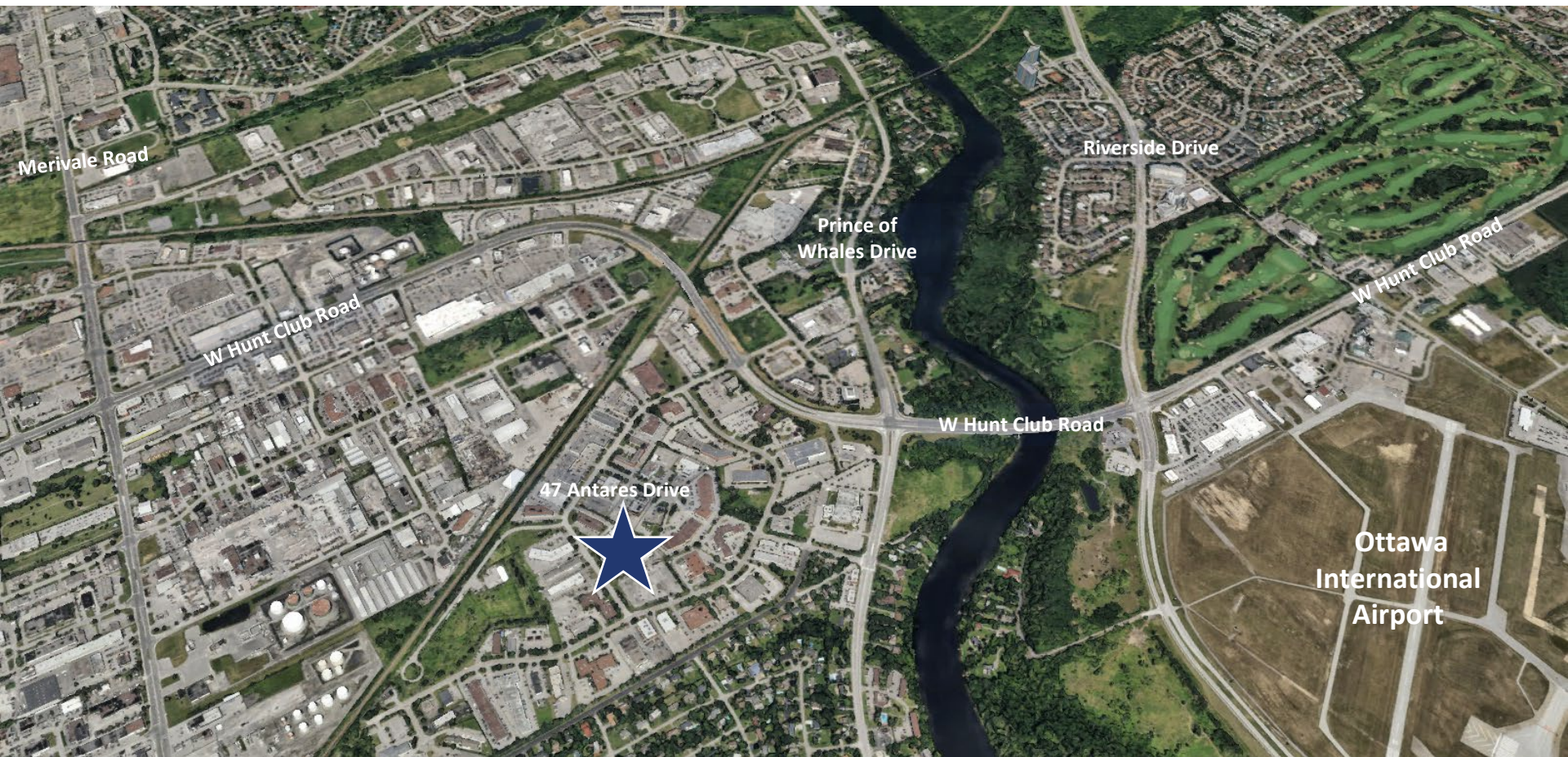

## 47 ANTARES DRIVE





Contact: Jennings Real Estate Brokerage Inc.

Andrew Eberhard | Broker of Record  
613-709-0263 | [aeberhard@jre.ca](mailto:aeberhard@jre.ca)

Iryna Loshkarova | Sales Representative  
613-413-1361 | [iloshkarova@jre.ca](mailto:iloshkarova@jre.ca)



**JENNINGS**  
**REAL ESTATE**  
BROKERAGE INC.