

NOTES

- Elevations shown hereon are based on the Trimble CRS Network, North Central Zone 4202, NAVD88 Datum.
- TBM: "X" Set on northeast side of curb inlet, northeast curb of Stemmons Freeway Access Road, 65.8 (+/-) feet northwest of the southwest corner of the subject tract.
Elevation = 556.07'
- It is my opinion that the property described hereon is not within the 100-year floodplain as scaled per the Federal Emergency Management Agency Flood Insurance Rate Map, Community-Panel No. 480195 0535 G, present Effective Date of Map, April 18, 2011, herein property lies within Zone "X" Unshaded.

Topographic Exhibit

**1802 N. Stemmons Freeway
Lot 1, Block A
Freedom Homes Addition**
an addition to the City of Lewisville,
Denton County, Texas, according
to the plat thereof recorded in
Cabinet I, Page 62, Plat Records,
Denton County, Texas.

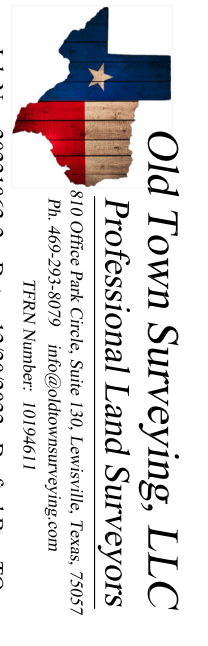

Old Town Surveying, LLC
Professional Land Surveyors
810 Office Park Circle, Suite 138, Lewisville, Texas, 75057
Ph: 469-393-8079 info@oldtownsurveying.com
TFRN Number: 10194611
Job No.: 20221062-2 Date: 12/20/2022 Drafted By: TO