

9,735 sq ft  
of office space  
available to let

**RX**  
LONDON

# Minster Building, 21 Mincing Lane, EC3

Progressive real estate.  
On every level.





Lobby

Atrium

# The building

## Description

Having been a part of the City Skyline for several decades already, The Minster Building is leading the way in carving out its own unique identity and adapting with the times. The part 5th floor provides 9,735 sq ft of new Cat A office accommodation benefitting from private terraces with views of the Shard and City tower cluster.

## Term

New lease for a term by arrangement

Rent	£62.50 per sq ft
Rates	£22.00 per sq ft
Service charge	£12.50 per sq ft

## Location

The Minster Building is located within the City’s ever-growing, iconic business district with a wide variety of amenities on its doorstep and less than a 5 minute walk from Fenchurch Street, Monument and Tower Hill stations.

## Specification

- Impressive ground floor reception with café
- Full height atrium
- 1 person per 10 sq m occupancy density
- 2.75 metre floor to ceiling height
- 200mm raised floors
- Four pipe fan coil air conditioning
- Private roof terrace on 5th floor
- 8 x 21 person passenger lifts
- 250 cycle racks, lockers and 25 showers



# Schedule of Areas

Floor	sq ft	sq m	Status
Fifth - Part	9,735	904.00	Available
Total	9,735	904.00	—



# 5th Floor Plan

9,735 sq ft / 904.0 sq m

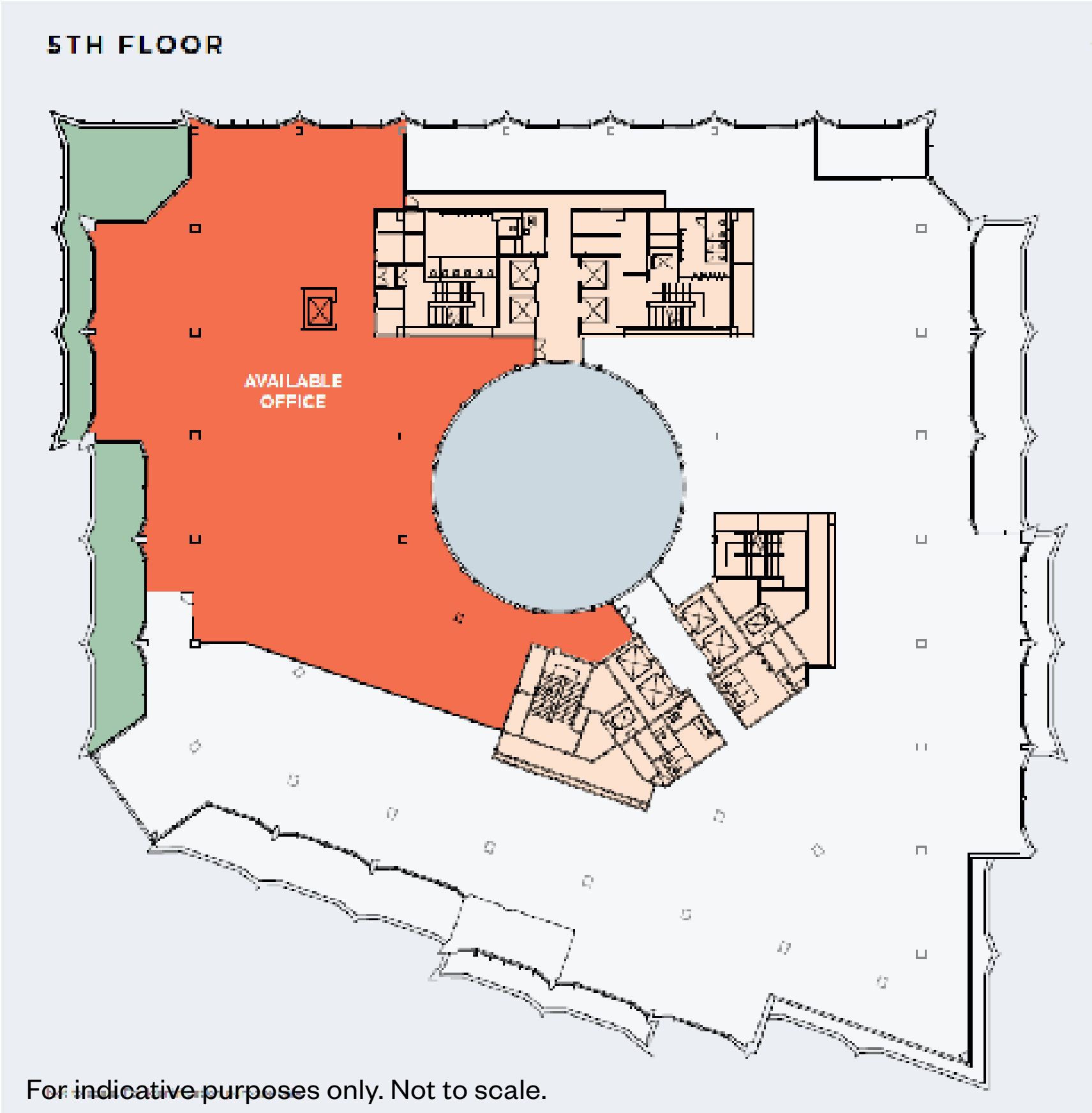



Progressive real estate.  
On every level.

@rxlondon  
info@rx.london  
[rx.london](https://rx.london)

# Contact us

05

## Helena Pryce

+44 (0)20 7096 7050  
+44 (0)7720 070 438  
[helena.pryce@rx.london](mailto:helena.pryce@rx.london)

## Dan Burn

+44 (0)20 7096 7050  
+44 (0)7515 607 011  
[dan.burn@rx.london](mailto:dan.burn@rx.london)

### Important Notice

**1. Particulars:** These particulars are not an offer or contract, nor part of one. You should not rely on statements by RX London in the particulars or by word of mouth or in writing ("information") as being factually accurate about the property, its condition or its value. Neither RX London nor any joint agent has any authority to make any representations about the property, and accordingly any information given is entirely without responsibility on the part of the agents, seller(s) or lessor(s).

**2. Photos etc:** The photographs show only certain parts of the property as they appeared at the time they were taken. Areas, measurements and distances given are approximate only.

**3. Regulations etc:** Any reference to alterations to, or use of, any part of the property does not mean that any necessary planning, building regulations or other consent has been obtained. None of the services or appliances have been tested and no warranty is given or is to be implied that they are in working order. A buyer or lessee must find out by inspection or in other ways that these matters have been properly dealt with and that all information is correct.

**4. VAT:** The VAT position relating to the property may change without notice.

RX London is a limited liability partnership registered in England with registered number 12905015. Our registered office is as follows: 33 Broadwick Street, London, Soho, W1F 0DQ