



Blankenbaker Crossings – Louisville, KY 40299

NTS is pleased to present Blankenbaker Crossings, a master-planned 500 acre Class A mixed-use business park in Louisville's East End. Regarded as a model for light industrial park development in Kentucky, Blankenbaker Crossings features a mile of interstate frontage with traffic counts over 80,000 cars per day. Last available tract is 4.89 Acres. Please see the information below

LAND FOR LEASE/SALE

- Commercial Land Site Available for Sale or Ground Lease
- Last tract remaining is 4.89 Acres
- Approximately 15 minutes to Downtown Louisville and Louisville International Airport
- Immediate Access to I-64; I-265 & I-264 within minutes
- Park-like setting for corporate office
- Immediate vicinity offering broad range of retail, hotels, restaurants



For more information or to schedule a tour, please contact:

Tony Fluhr, SIOR, CCIM

Managing Director

502.429.9820

tfluhr@ntsdevco.com

www.ntsdevelopment.com

Mark Meredith, CCIM

Director of Commercial Leasing

502.429.9827

mmeredith@ntsdevco.com

NTS



DEMOGRAPHICS

	3 Mile	5 Mile	7 Mile
Population:	53,927	135,224	268,550
Employee Population:	69,950	111,228	194,505
Households:	22,869	55,988	112,553
Average HH Income:	\$89,203	\$90,022	\$86,285
Median Age:	41.5	41.2	40.5

TRAFFIC COUNTS

Blankenbaker Pkwy & Bluegrass Pkwy:	~35,700 ADT
I-64 & Blankenbaker Pkwy:	~80,000 ADT

Source: ESRI & KTC

For more information or to schedule a tour, please contact:

Tony Fluhr, SIOR, CCIM

Managing Director
502.429.9820
tfluhr@ntsdevco.com

Mark Meredith, CCIM

Director of Commercial Leasing
502.429.9827
mmeredith@ntsdevco.com

www.ntsdevelopment.com

NTS

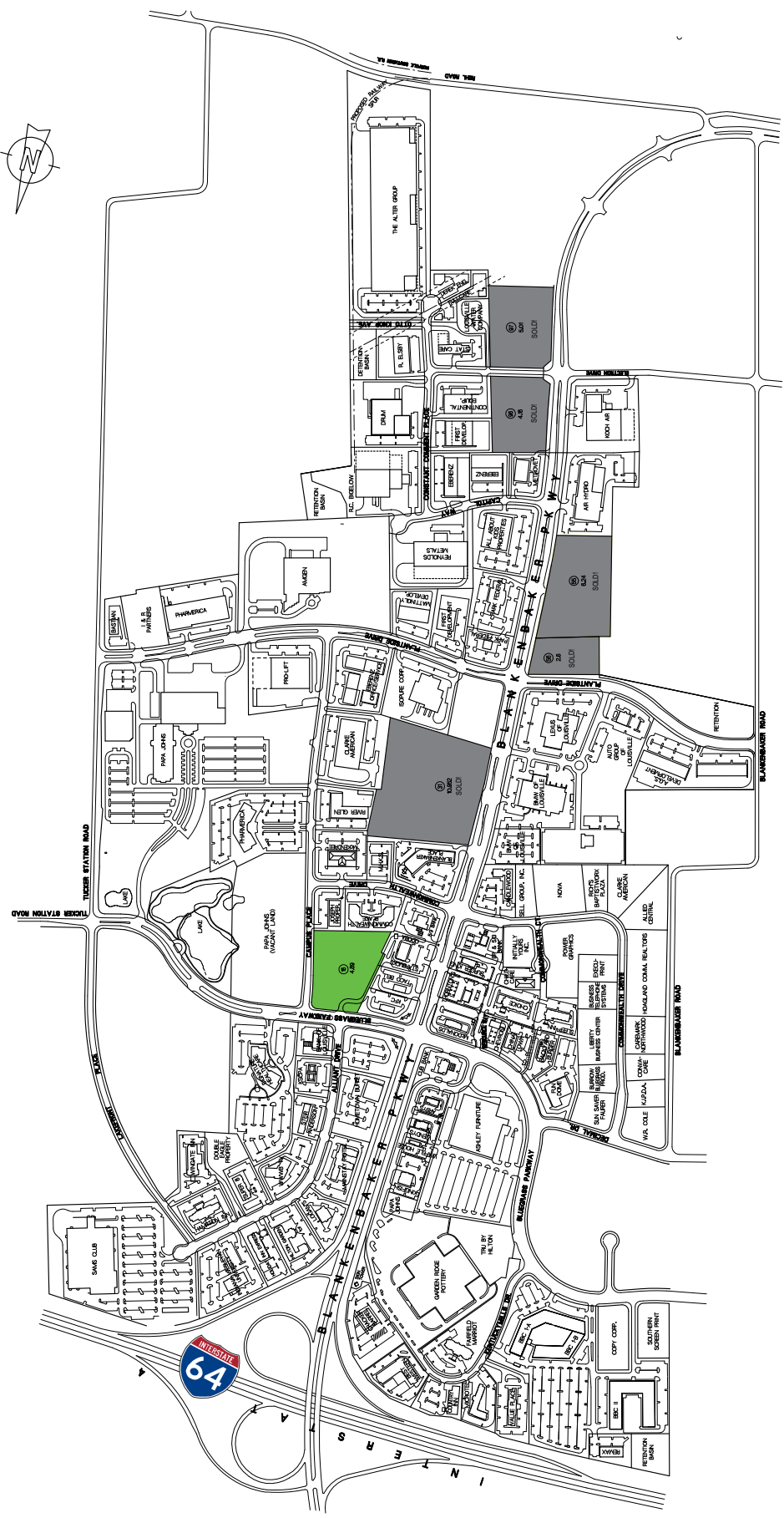

BLANKENBAKER CROSSINGS

Available Lots Shown Are Typically Marketed For Build To Suite Development or Ground Lease.

The information herein, while believed to be accurate, has been obtained from third party sources. We have not independently verified the information herein and cannot warrant its accuracy. No responsibility shall be assumed for any errors or omissions in this information presented herein.

For more information or to schedule a tour, please contact:

Tony Fluhr, SIOR, CCIM
 Managing Director
 502.429.9820
 tfluhr@ntsdevco.com

Mark Meredith, CCIM
 Director of Commercial Leasing
 502.429.9827
 mmeredith@ntsdevco.com

www.ntsdevelopment.com



Although all information furnished regarding the property for sale, rental, or financing is from sources deemed reliable, such information has not been verified and no express representation is made nor is any to be implied as to the accuracy thereof and it is submitted subject to errors, omissions, change of price, rental or other changes or conditions, prior sale, lease financing, or withdrawal without notice and to any special conditions imposed by our principal.