



295 KENNEDY MEMORIAL DRIVE
WATERVILLE, ME 04901

PROPERTY HIGHLIGHTS

- 2,672± SF former pharmacy, fully renovated in 2022.
- Operational drive-up lane and window.
- Co-tenants include food, office, and medical.
- High-traffic corridor supported by turning lane.
- **Sublease Rate: \$15.00/SF NNN**



FOR SUBLEASE

END-CAP RETAIL SPACE W/ DRIVE-THRU

PROPERTY DETAILS

SUBLESSOR	Northern Light Health
BOOK/PAGE	11231/134
ASSESSOR'S REFERENCE	Map 41, Lot 100
AVAILABLE SPACE	2,672± SF
BUILDING SIZE	9,476± SF
LOT SIZE	8.75± AC
ZONING	CD - Highway Commercial
YEAR BUILT	1965; Space renovated in 2022
LOT FRONTAGE	300' on Kennedy Memorial Drive
UTILITIES	Municipal water and sewer
HEATING & COOLING	Forced-air; installed in 2022
SPRINKLERS	Yes, wet system.
PARKING	In common with other tenants, not assigned.
BUILDING TENANTS	Harvest Moon, Edward Jones, Waterville Pediatric & Hanger Clinic
TRAFFIC COUNT	24,082 vehicles/day (factored 2025)
DATE AVAILABLE	Immediately
NNN EXPENSES	See broker for details.
LEASE RATE	\$15.00/SF NNN

FLOOR PLAN

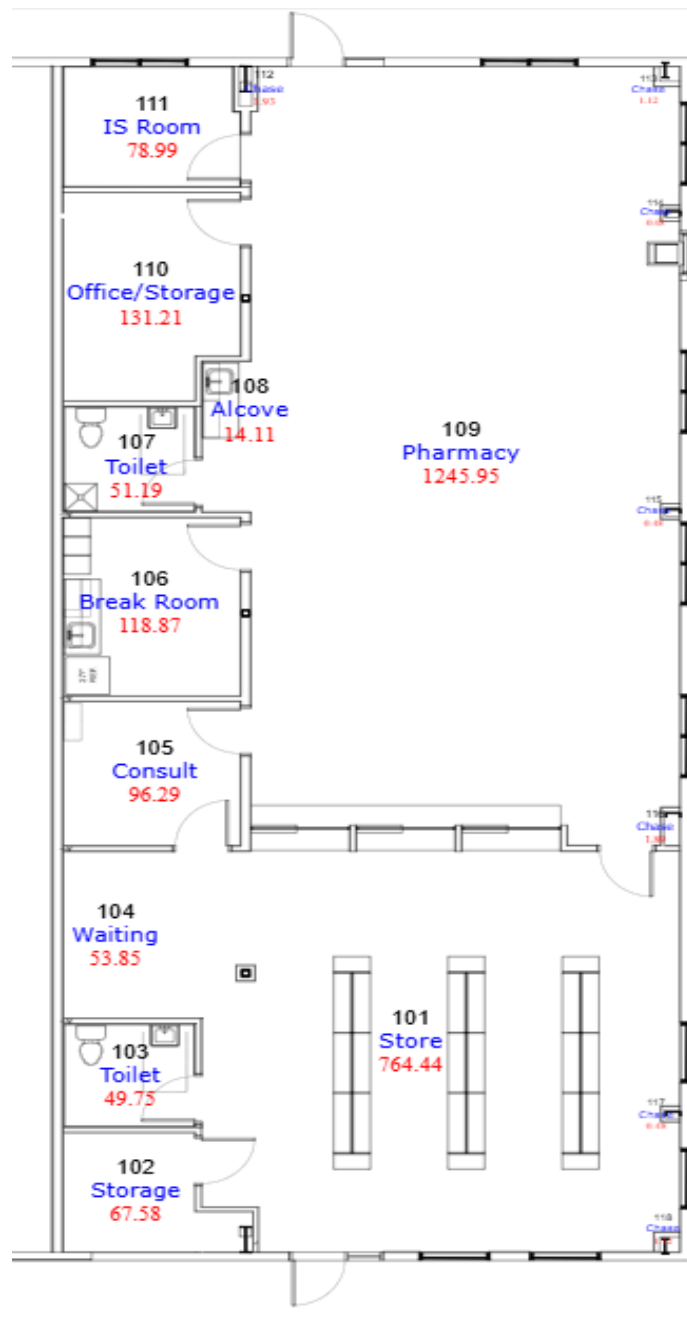

FOR SUBLEASE | **END-CAP RETAIL SPACE W/ DRIVE-THRU**
295 KENNEDY MEMORIAL DRIVE, WATERVILLE, ME 04901



FOR SUBLEASE | END-CAP RETAIL SPACE W/ DRIVE-THRU
295 KENNEDY MEMORIAL DRIVE, WATERVILLE, ME 04901



CONTACT US



ROY DONNELLY
ASSOCIATE BROKER
+1 207.553.1736D
+1 207.356.1327 C
RDONNELLY@BOULOS.COM



©2025 The Boulos Company, Inc. All rights reserved. This information has been obtained from sources believed reliable but has not been verified for accuracy or completeness. You should conduct a careful, independent investigation of the property and verify all information. Any reliance on this information is solely at your own risk. The Boulos Company and The Boulos Company logo are service marks of The Boulos Company, Inc. All other marks displayed on this document are the property of their respective owners. Photos herein are the property of their respective owners. Use of these images without the express written consent of the owner is prohibited.