



3481 - 3483 Old Conejo Road / **Newbury Park, CA**

DRYSHHELL BUSINESS CENTER



±2,476SF

3481 - 3483 Old Conejo Road / **Newbury Park, CA**



Overview

- Suite #206: ±2,476 SF
- Available: February 1st, 2026
- Modified Gross Lease: NO CAM
- Asking Rent: \$3,900.00 (\$1.57/SF)
- Office: Corridor layout with four (4) private offices, HVAC, and private restrooms
- Warehouse has Air Conditioning
- ±12 ft clear height
- Recently Remodeled space with new flooring and paint

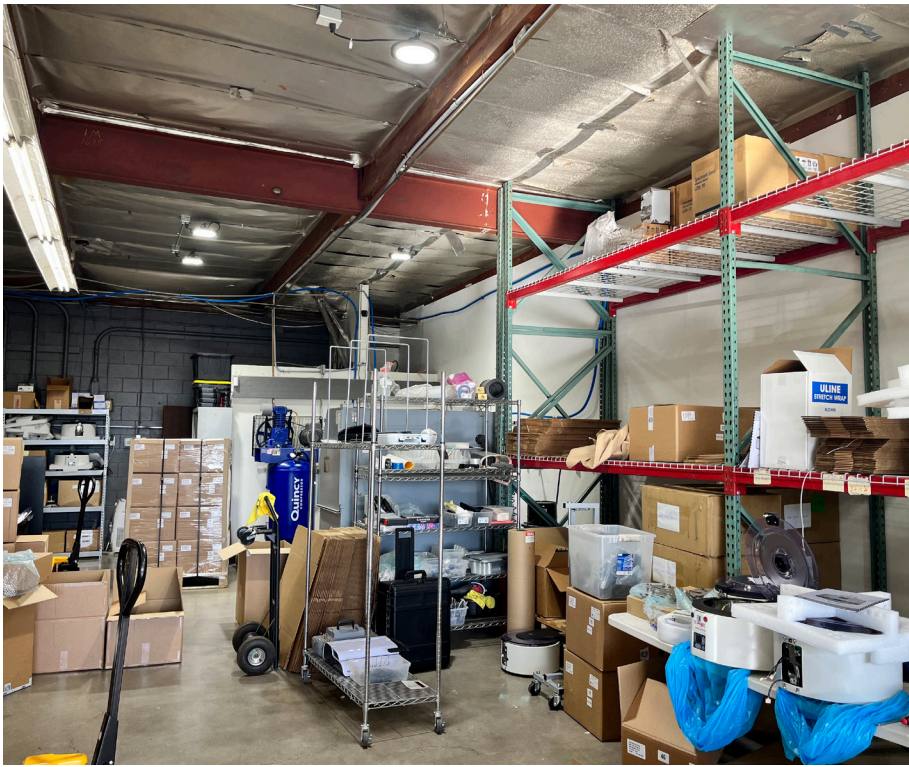

**DRYSHELL
BUSINESS
CENTER**



WESTCORD





**DRYSHELL
BUSINESS
CENTER**



 **WESTCORD**



FLOOR PLAN

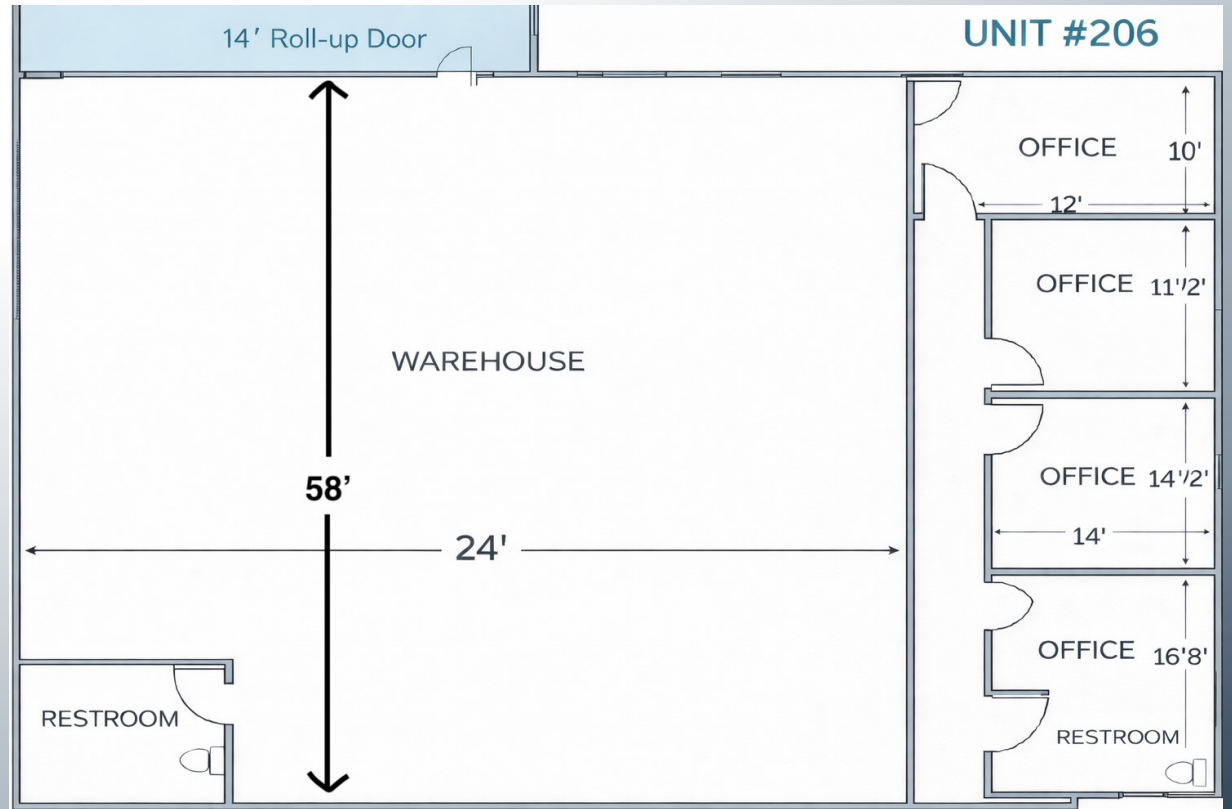



Liam Wells

Associate

DRE #02117529

805.206.7736

liam@westcord.com



WESTCORD.COM

3481 - 3483 Old Conejo Road / **Newbury Park, CA**

DRYSHELL BUSINESS CENTER