

INDUSTRIAL/WAREHOUSE  
FOR LEASE

# Davis Industrial Park

3247 NW Yeon Ave, Portland, OR 97210  
Building C

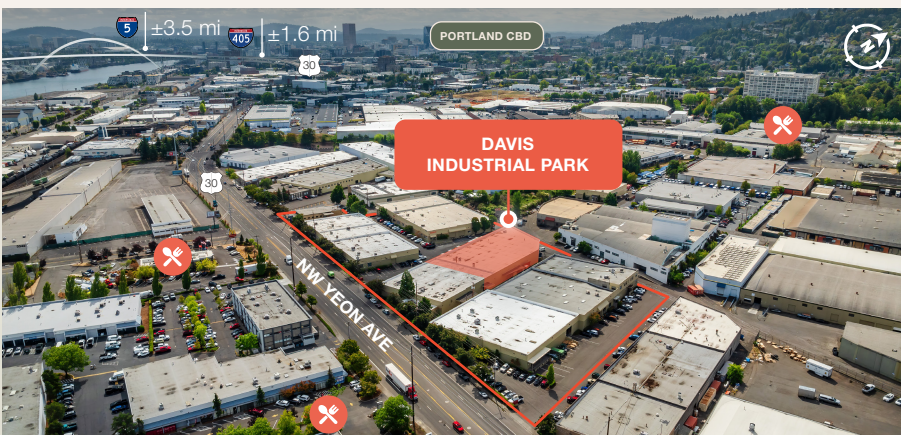

## Key Features



29,300 sq. ft. shell



1,626 sq. ft. office



8 dock doors  
1 grade door

---

16' clear height

---

LED lighting

---

Convenient access to I-405  
and I-5

---

Desirable Guilds Lake  
location

---

Available April 2025

**Lease Rate (NNN):**

**\$0.80/sq. ft. shell**

**\$1.10/sq. ft. office**

**Jake Bigby**

jakeb@pactrust.com

**Caitlin Knecht**

caitlink@pactrust.com

503.624.6300

Owned & Managed by

**PACTRUST**

# Space Plan

3247 NW Yeon Ave, Portland, OR 97210

29,300 Sq. Ft.

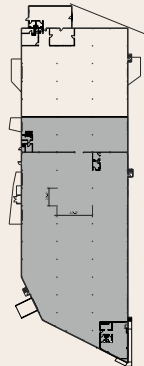

**BUILDING PLAN**

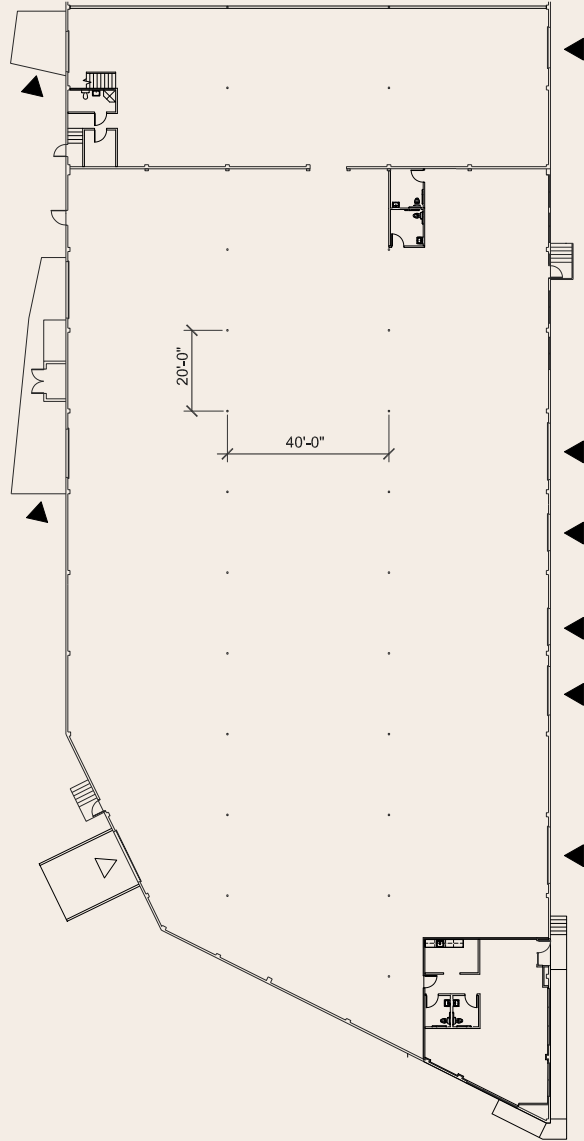

▽ GRADE ACCESS  
▼ DOCK ACCESS

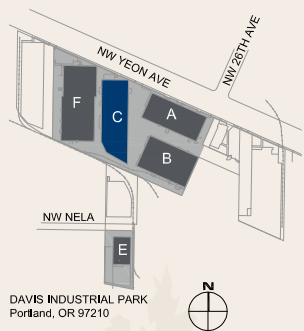

**Jake Bigby**  
jakeb@pactrust.com

**Caitlin Knecht**  
caitlink@pactrust.com

503.624.6300  
www.PacTrust.com