

EAT UP!

AT 

Generational Food Hall in our nation's
Asian supermarket powerhouse



37-11 MAIN STREET

Flushing,
New York





FLUSHING is the world's largest and one of the fastest growing Chinatowns.

“

With over 250,000 people passing through Times Square each day, the only other space in New York City that comes close to that amount of foot traffic is on Main Street in Flushing, Queens.

-NYC DDC

”

7

Main Street Subway station with over 13.87 million annual ridership (2023)
18.4% increase in ridership compared to 2022



Twenty bus lines servicing Downtown Flushing



Flushing-Main Street station is on the LIRR Port Washington Branch with over 9.92 million ridership (2023)
19.3% increase in ridership compared to 2022



Demographic

Radius	1-mile	3-mile	5-mile
Population	114,387	741,695	1,660,944
Households	42,965	256,533	561,615
Persons per Household	2.62	2.86	2.76
Household Average Income	\$81,624	\$101,620	\$107,024
Average Age	45.06	41.66	41.32



Retail Map



Floor Plan

Total Food Stalls: 22

Available Spaces: 150-540 sf

Storage Space: Upon Request

Dining Area: 6,880 sf

No. of Seats: 158

Pricing: Upon Request

Comments:

-  **RANCH MARKET** as the 22,000 sf ground floor anchor supermarket
- Elevators and stairs connecting directly to the market
- Escalators at the Main Street entrance
- Anticipated delivery: 2025-Q1

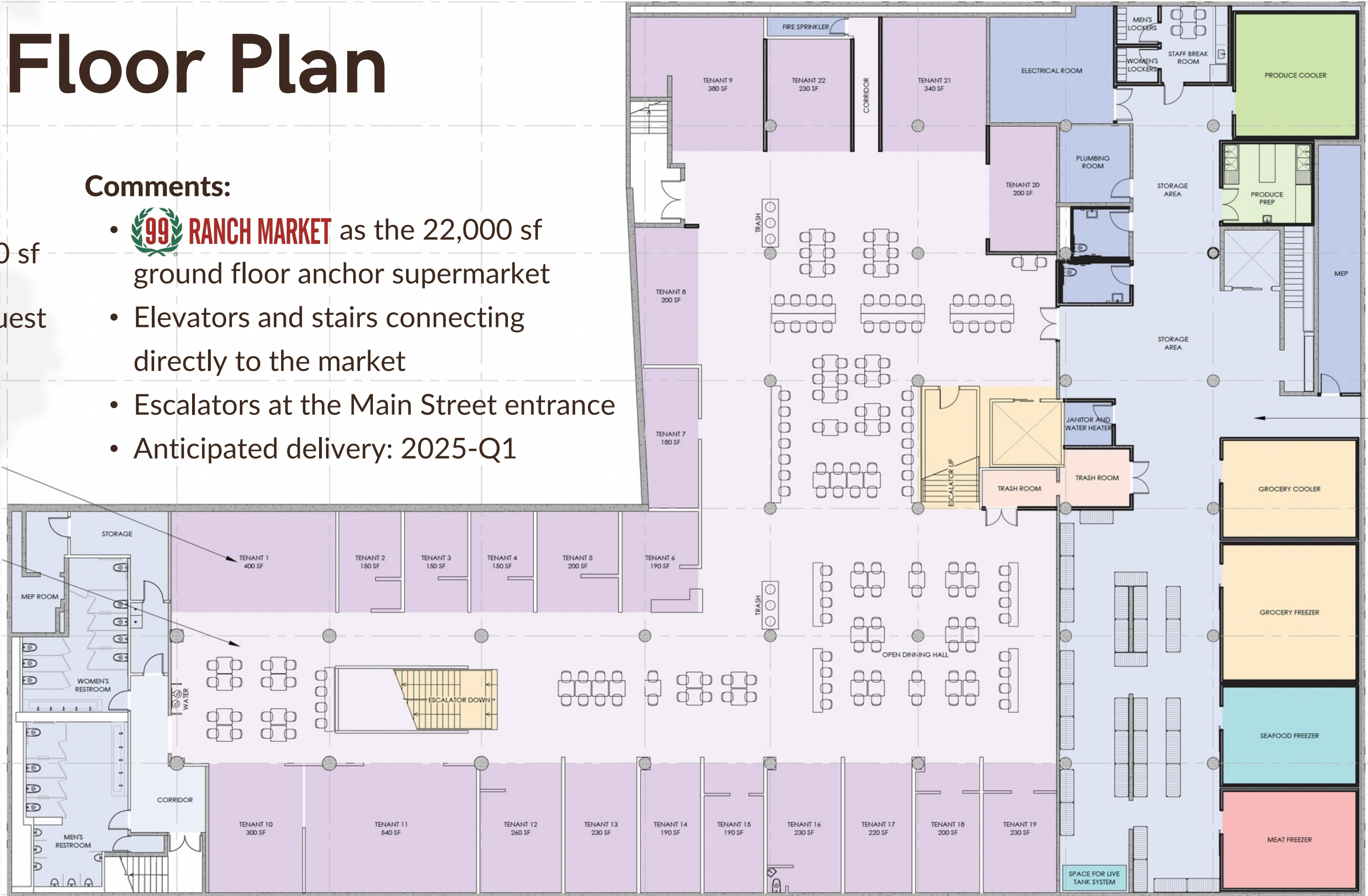

Exclusive Leasing Broker:

Keat Chew

347.571.3338

keat@kineticreg.com



Established in 1984 in Westminster, California. For 40 years, it has grown to be one of the largest Asian grocery chains in the US.

62+ stores across 11 states

- Arizona, California, Maryland, Massachusetts, Nevada, New Jersey, New York, Oregon, Texas, Virginia, and Washington

A Pan-Asian Destination that offers a wide variety of Asian products, including fresh produce, premium meats, live seafood, everyday Asian staples, and snacks, as well as authentic Asian cuisines and Asian-inspired bakery items.





RANCH MARKET

At 99 Ranch market, we're on a mission to bring customers the authentic flavors of Asia, served up with a generous helping of warmth and hospitality. From our top-notch products to our friendly service, we're here to ensure that every visit is a delightful experience.

Over 200K+ followers across all social media channels:



Contact Exclusive Leasing Broker

KEAT CHEW
PRINCIPAL BROKER

PHONE NUMBER
347.571.3338

EMAIL ADDRESS
keat@kineticreg.com

WEBSITE
kineticreg.com

