

FOR LEASE

D Street Village #1

3050 SE DIVISION STREET / PORTLAND, OR 97202



Creative office space on Division Street

AVAILABLE SPACE

- Suite 230: 1,018 SF
- Suite 165: 859 SF
- Suite 240: 734 SF
- Suite 255: 492 SF

LEASE RATE

- Call for pricing

TRAFFIC COUNTS

- SE Division St – 6,250 ADT ('23)

HIGHLIGHTS

- High-demand SE Division location
- Boutique-scale retail / office spaces
- Integrated micro-village of shops, office & residential
- Shared interior alley with active common space
- Elevator access for easy vertical circulation

CONTACT

Justin Darling
Sara Daley

503 457 2990 / 503 224 6791 / jdarling@naielliott.com
503 568 5908 / 503 224 6791 / sdaley@naielliott.com

NAIElliott

The information herein has been obtained from sources we deem reliable. We do not, however, guarantee its accuracy. All information should be verified prior to purchase/leasing. View the Real Estate Agency Pamphlet by visiting our website, www.naielliott.com/agencydisclosures

Located in a prime location on the “50 yard line” of Division

Recent renovations and new construction on both sides of SE Division and 30th Avenue have cultivated a curated tenant mix of office space, shops, and restaurants in D Street Village.



NEARBY BUSINESSES:

- Eb & Bean Frozen Yogurt
- Salt & Straw Ice Cream
- St. Honoré Bakery
- Pinn Salon
- Wallflower Coffee
- PDX Sliders
- NOW Yoga
- Kati Portland–Vegetarian/Vegan Thai Restaurant
- Casa Italia
- Raylee Consignment Boutique
- Tight Tacos
- Blue Star Donuts
- Oma's Hideaway



98

BIKE SCORE



96

WALK SCORE



54

TRANSIT SCORE

CONTACT

Justin Darling
Sara Daley

503 457 2990 / 503 224 6791 / jdarling@naielliott.com
503 568 5908 / 503 224 6791 / sdaley@naielliott.com

NAIElliott

The information herein has been obtained from sources we deem reliable. We do not, however, guarantee its accuracy. All information should be verified prior to purchase/leasing. View the Real Estate Agency Pamphlet by visiting our website, www.naielliott.com/agencydisclosures

Trendy mixed-use development



CONTACT

Justin Darling
Sara Daley

503 457 2990 / 503 224 6791 / jdarling@naielliott.com
503 568 5908 / 503 224 6791 / sdaley@naielliott.com

NAIElliott

The information herein has been obtained from sources we deem reliable. We do not, however, guarantee its accuracy. All information should be verified prior to purchase/leasing. View the Real Estate Agency Pamphlet by visiting our website, www.naielliott.com/agencydisclosures

Interior photos

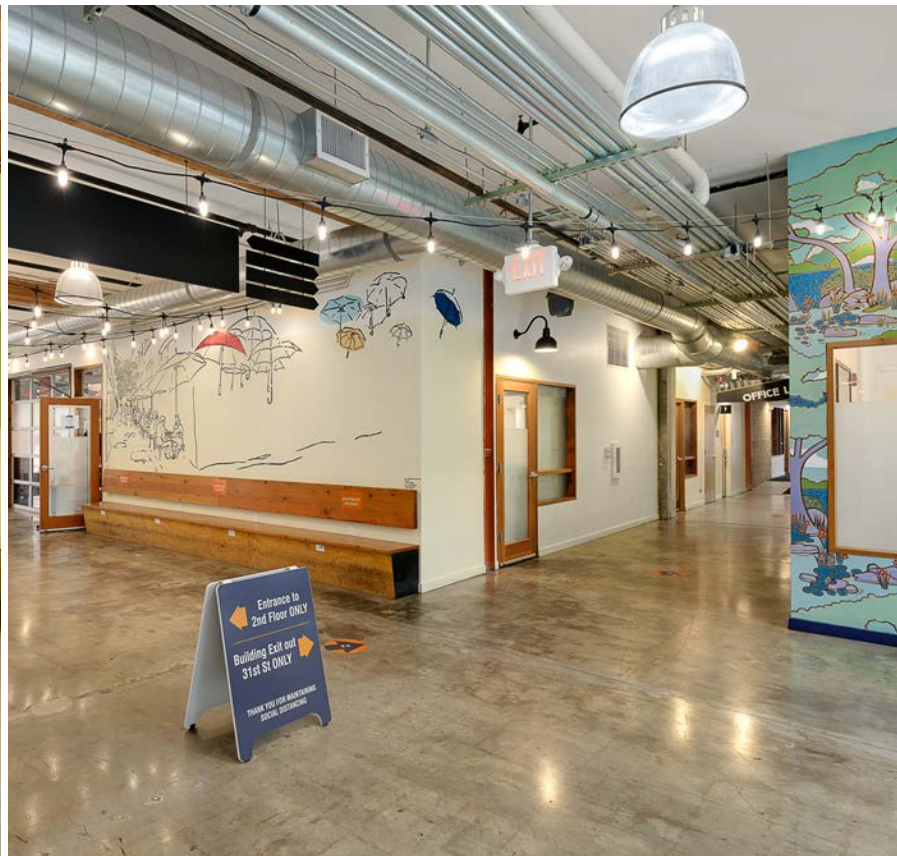

CONTACT

Justin Darling
Sara Daley

503 457 2990 / 503 224 6791 / jdarling@naielliott.com
503 568 5908 / 503 224 6791 / sdaley@naielliott.com

NAIElliott

The information herein has been obtained from sources we deem reliable. We do not, however, guarantee its accuracy. All information should be verified prior to purchase/leasing. View the Real Estate Agency Pamphlet by visiting our website, www.naielliott.com/agencydisclosures

Floor plan | 1st floor

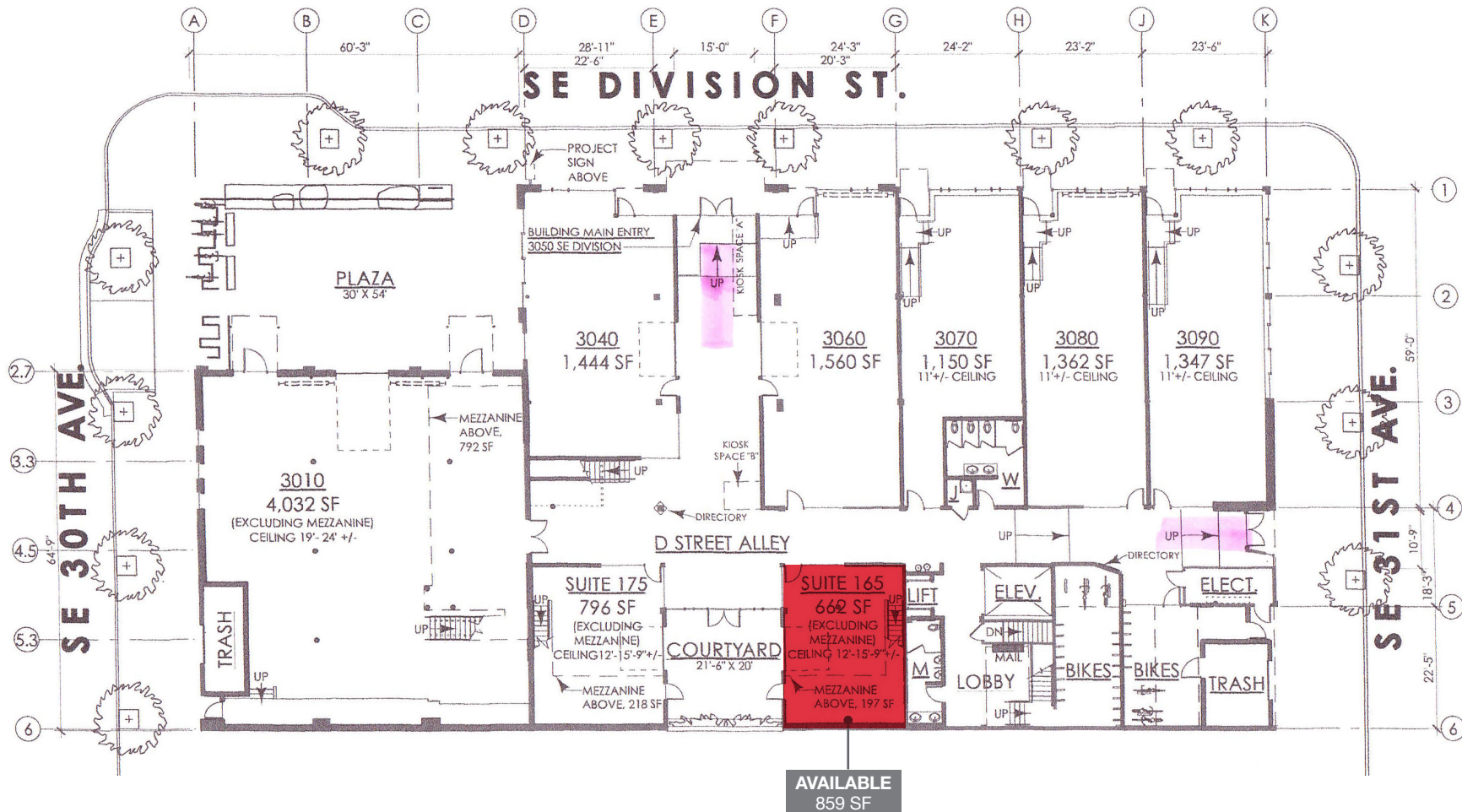

CONTACT

Justin Darling
Sara Daley

503 457 2990 / 503 224 6791 / jdarling@naielliott.com
503 568 5908 / 503 224 6791 / sdaley@naielliott.com

NAI Elliott

The information herein has been obtained from sources we deem reliable. We do not, however, guarantee its accuracy. All information should be verified prior to purchase/leasing. View the Real Estate Agency Pamphlet by visiting our website, www.naielliott.com/agencydisclosures

Floor plan | 2nd floor

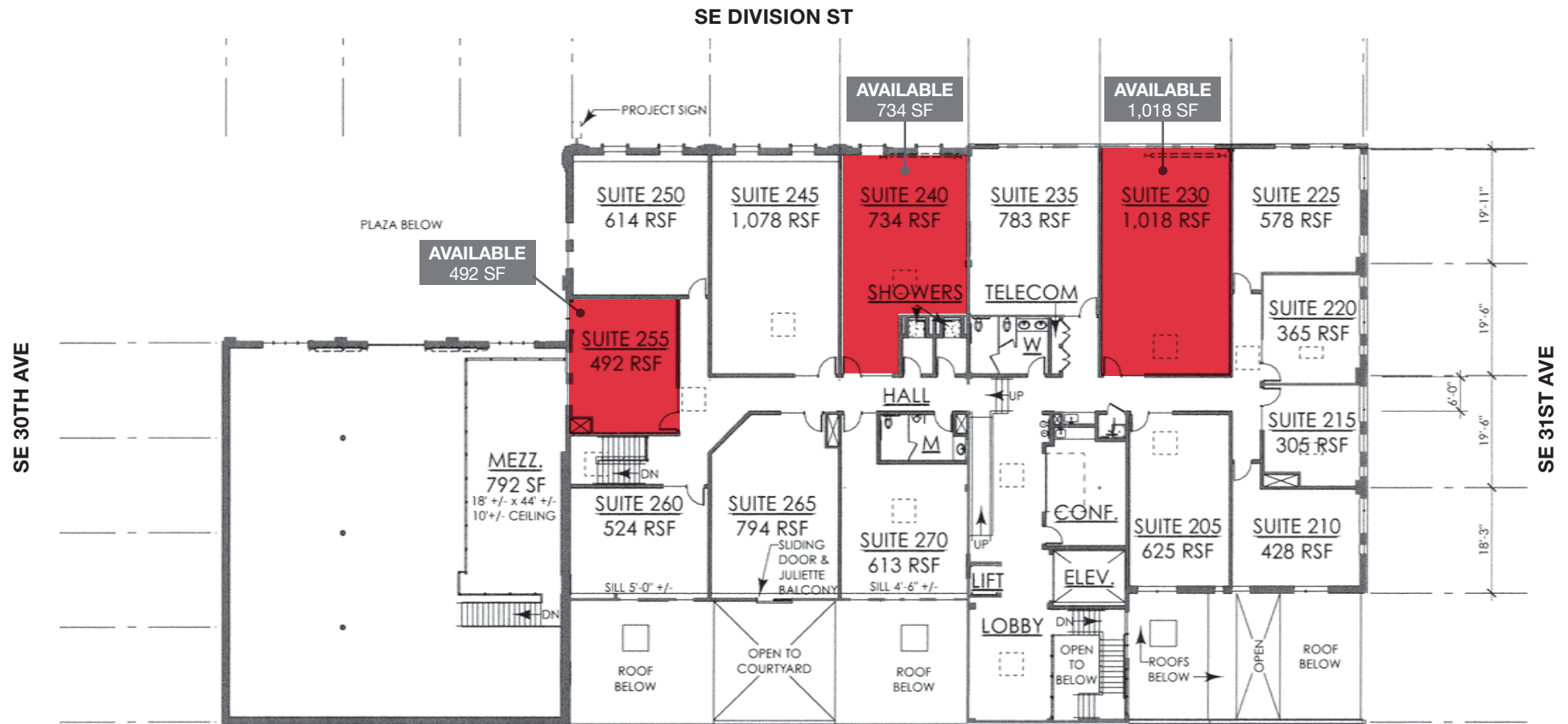

CONTACT

Justin Darling
Sara Daley

503 457 2990 / 503 224 6791 / jdarling@naielliott.com
503 568 5908 / 503 224 6791 / sdaley@naielliott.com

NAI Elliott

The information herein has been obtained from sources we deem reliable. We do not, however, guarantee its accuracy. All information should be verified prior to purchase/leasing. View the Real Estate Agency Pamphlet by visiting our website, www.naielliott.com/agencydisclosures

SE PORTLAND, OREGON

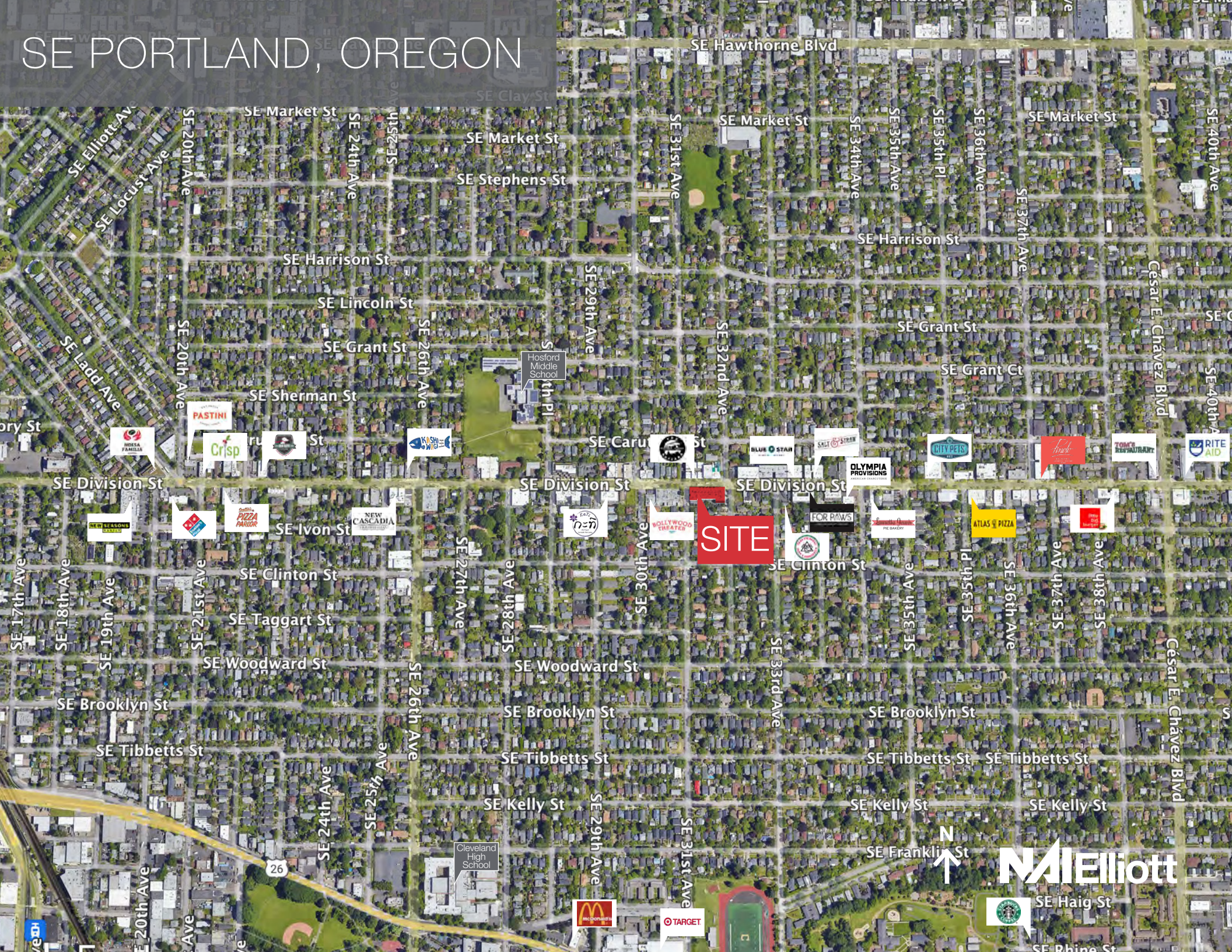

Demographics

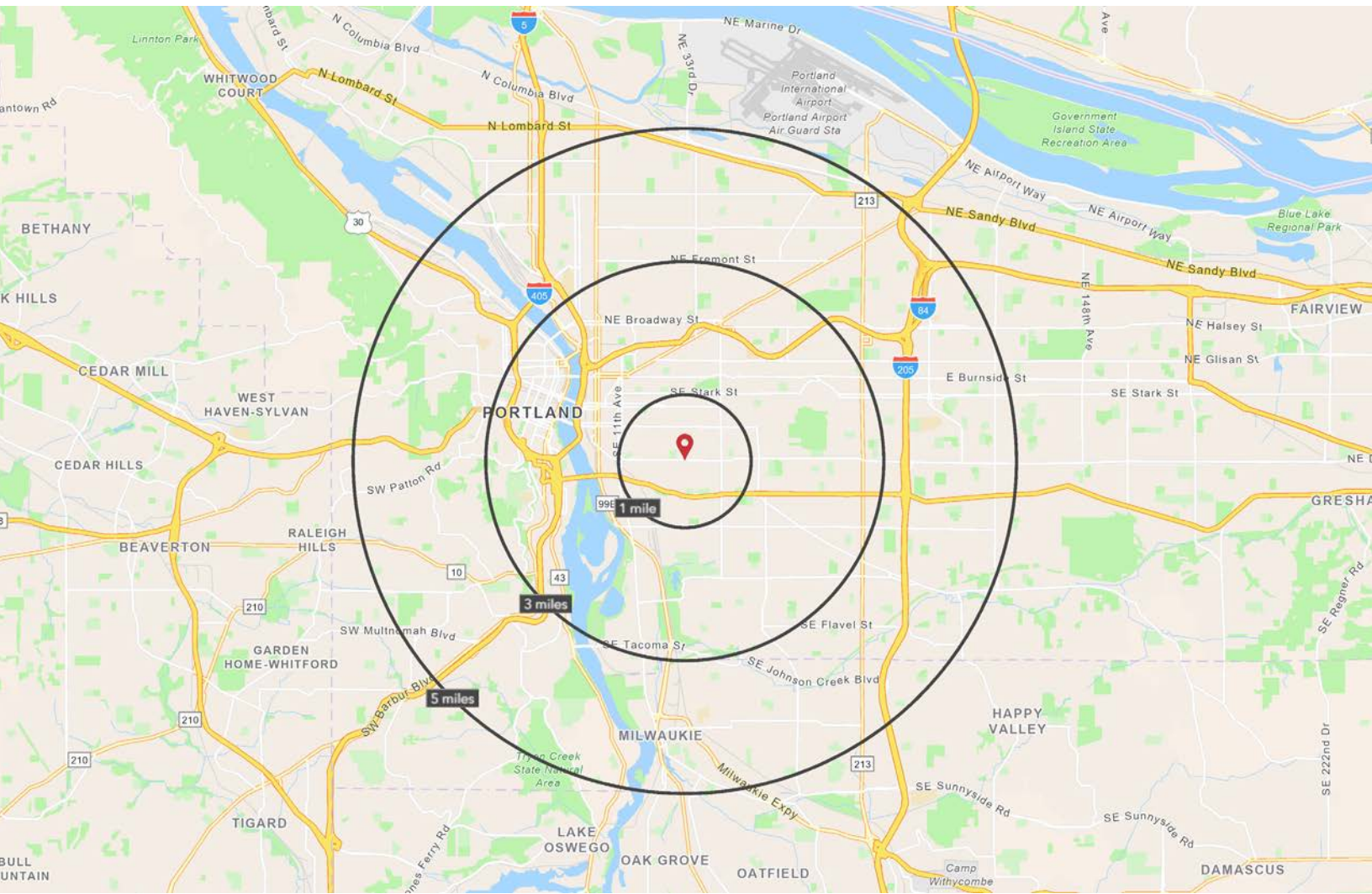

	1 MILE	3 MILE	5 MILE
Estimated Total Population 2025	33,384	234,808	516,074
Projected Total Population 2030	33,650	241,325	526,395
Average HH Income	\$139,476	\$132,861	\$133,093
Median Home Value	\$708,552	\$691,523	\$654,006
Estimated Total Households	15,714	113,673	232,861
Daytime Demographics 16+	18,726	278,476	423,032
Some College or Higher	89%	87%	82%

Source: ESRI - 2025

CONTACT

Justin Darling
Sara Daley

503 457 2990 / 503 224 6791 / jdarling@naielliott.com
503 568 5908 / 503 224 6791 / sdaley@naielliott.com

NAIElliott

The information herein has been obtained from sources we deem reliable. We do not, however, guarantee its accuracy. All information should be verified prior to purchase/leasing. View the Real Estate Agency Pamphlet by visiting our website, www.naielliott.com/agencydisclosures