

GENERAL PLAN NOTES

1. VERIFY ALL EXISTING CONDITIONS AND DIMENSIONS PRIOR TO START OF WORK. CONTRACTOR TO NOTIFY ARCHITECT OF ANY DISCREPANCY WITH THE PLANS AND SPECIFICATIONS PRIOR TO BEGINNING WORK.
2. VERIFY ALL DOOR AND WINDOW SIZES AND LOCATIONS PRIOR TO WALL LAYOUT WITH THE OWNER.
3. GENERAL CONTRACTOR TO COORDINATE ALL OWNER PROVIDED EQUIP.
4. ALL DIMENSIONS ARE GIVEN FROM FACE OF STUD OR FACE OF MASONRY (UNLESS NOTED OTHERWISE). DIMENSIONS TO EXISTING WALLS ARE TO FACE OF EXISTING FINISHES.
5. ALL INSIDE FACE OF DOOR JAMBS ARE LOCATED 4" FROM ADJACENT WALL TO DOOR HINGE JAMB (UNLESS NOTED OTHERWISE).
6. ALL NEW DOORS AND FRAMES TO MATCH EXISTING. CONTRACTOR TO MATCH EXISTING HARDWARE AND COORDINATE EACH NEW/EXISTING DOORS HARDWARE NEEDS WITH OWNER.
7. GENERAL CONTRACTOR TO PROVIDE BLOCKING AT ALL WALL HUNG 'MEP' EQUIPMENT, REFER TO 'MEP' DRAWINGS TO COORDINATE LOCATIONS.
8. GENERAL CONTRACTOR TO PROVIDE BLOCKING AT ALL WALL HUNG SHELVING, TOILET PARTITIONS, TOILET ACCESSORIES, GRAB BARS, MIRRORS, ETC. GENERAL CONTRACTOR TO COORDINATE LOCATION OF WALL HUNG ITEMS WITH OWNER PRIOR TO COVER UP OF BLOCKING.
9. GENERAL CONTRACTOR TO PROVIDE BLOCKING FOR ALL 'TV' MOUNTING BRACKETS. GENERAL CONTRACTOR TO COORDINATE FINAL BLOCKING LOCATION WITH OWNER. TV'S AND BRACKETS SHALL BE OWNER FURNISHED AND CONTRACTOR INSTALLED. COORDINATE POWER/CABLE/DATA OUTLETS AT TV LOCATIONS.
10. NEW INTERIOR PARTITIONS AND INFILL OF EXISTING PARTITIONS ARE TO MATCH THE CONSTRUCTION TYPE OF EXISTING PARTITIONS.
11. PROVIDE MOISTURE & MOLD RESISTANT TYPE GYP. BD. AT ALL RESTROOM INTERIOR WALLS.
12. FURNITURE SHOWN IS FOR GENERAL INFORMATION PURPOSES, AND IS NOT IN CONTRACT.
13. PROVIDE SOUND ATTENUATION BLANKETS AT ALL NEW WALLS AT TOILET AREAS AND AT OFFICES.
14. SEE MECHANICAL FOR TOILET ROOM FORCED AIR VENTILATION TO THE EXTERIOR.
15. COORDINATE ALL OVERHEAD AND UNDER SLAB UTILITIES WITH THE OWNER.
16. REINSTALL SALVAGED FIRE EXTINGUISHERS AS SHOWN IN PLAN.

PARTITION GENERAL NOTES

1. FOR ALL FIRE RATED PARTITIONS
 - A. SEAL ALL PENETRATIONS WITH THROUGH - PENETRATION FIRESTOP (078413)
 - B. PROVIDE CONTINUOUS FIRESTOP SEALANT BOTH SIDES, TOP, & BOTTOM OF ALL GYP. BD. PARTITIONS.
 - C. INFILL VOIDS WITH FIRE SAFING
2. FOR ALL SOUND BARRIER PARTITIONS
 - A. SEAL AIR TIGHT AT FLOOR, SIDE WALLS, COLUMNS, DECK WITH A NON-HARDENING ACOUSTICAL SEALANT.
 - B. PACK ALL WALL PENETRATIONS WITH FIBERGLASS AND CAULK AIR TIGHT.
 - C. FOR ALL WALL OUTLETS AND J-BOXES - STAGGER WALL OUTLET AND J-BOX LOCATIONS ON OPPOSITE SIDES OF WALL A MINIMUM OF 12" WITH AT LEAST ONE WALL STUD SEPARATION, AND AT WALL OUTLETS AND J-BOXES, CUT GYP. BD. TO ALLOW A MINIMUM OF 1/4" OVERLAP BY FACE PLATE.
3. THE TERM "WET SIDE" OF WALL REFERS TO ALL SIDES FACING TOILETS, FUTURE TOILETS, JANITOR CLOSETS, ELECTRIC WATER COOLERS AND SINKS. AT THESE LOCATIONS, PROVIDE 5/8" W.R. VERY HIGH IMPACT ABUSE GYP. BD. WHERE INDICATED. INSTALL 4' X 8' SHEET OF FRP PANEL BEHIND AND BESIDE JANITOR SINK.
4. CONTRACTOR TO PROVIDE ALL BLOCKING NECESSARY FOR ATTACHMENT OF HANDRAILS, BOOK SHELVING, TOILET ACCESSORIES AND OTHER WALL HUNG ITEMS.
5. PROVIDE WOOD BLOCKING IN PARTITIONS AS REQUIRED FOR ATTACHEMENT OF WOOD BASE. BLOCKING TO BE FIRE TREATED IN RATED PARTITIONS.
6. PROVIDE THE FOLLOWING PERMANENT STENCILED LETTERING AT 10'-0" O.C. (HORIZ.) ON ALL FIRE RATED PARTITIONS, "FIRE AND SMOKE BARRIER - PROTECT ALL OPENINGS." LOCATE ABOVE THE CEILING.
7. ALLOW FOR 100 LINEAR FEET OF GYP. BD. CONTROL JOINTS TO BE LOCATED AS DIRECTED BY THE ARCHITECT.

GENERAL DOOR NOTES

1. ALL NEW DOORS TO BE PAINTED.
2. ALL EXISTING DOORS TO REUSE EXISTING HARDWARE.
3. ALL NEW DOOR HARDWARE TO BE LEVER OR PUSH/PULL TYPE, NOT REQUIRING GRASPING OR TWISTING.
4. CLEAN, PREP, AND PAINT ALL EXISTING DOOR(S)/FRAME(S) THAT ARE TO REMAIN OR BE RELOCATED.
5. COORDINATE KEYING WITH OWNER. PROVIDE ONE (1) GRANDMASTER KEY AND FOUR (4) MASTER KEYS FOR OWNER.
6. PROVIDE TEMPORARY CONSTRUCTION CORES AS NEEDED.

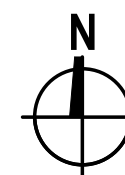
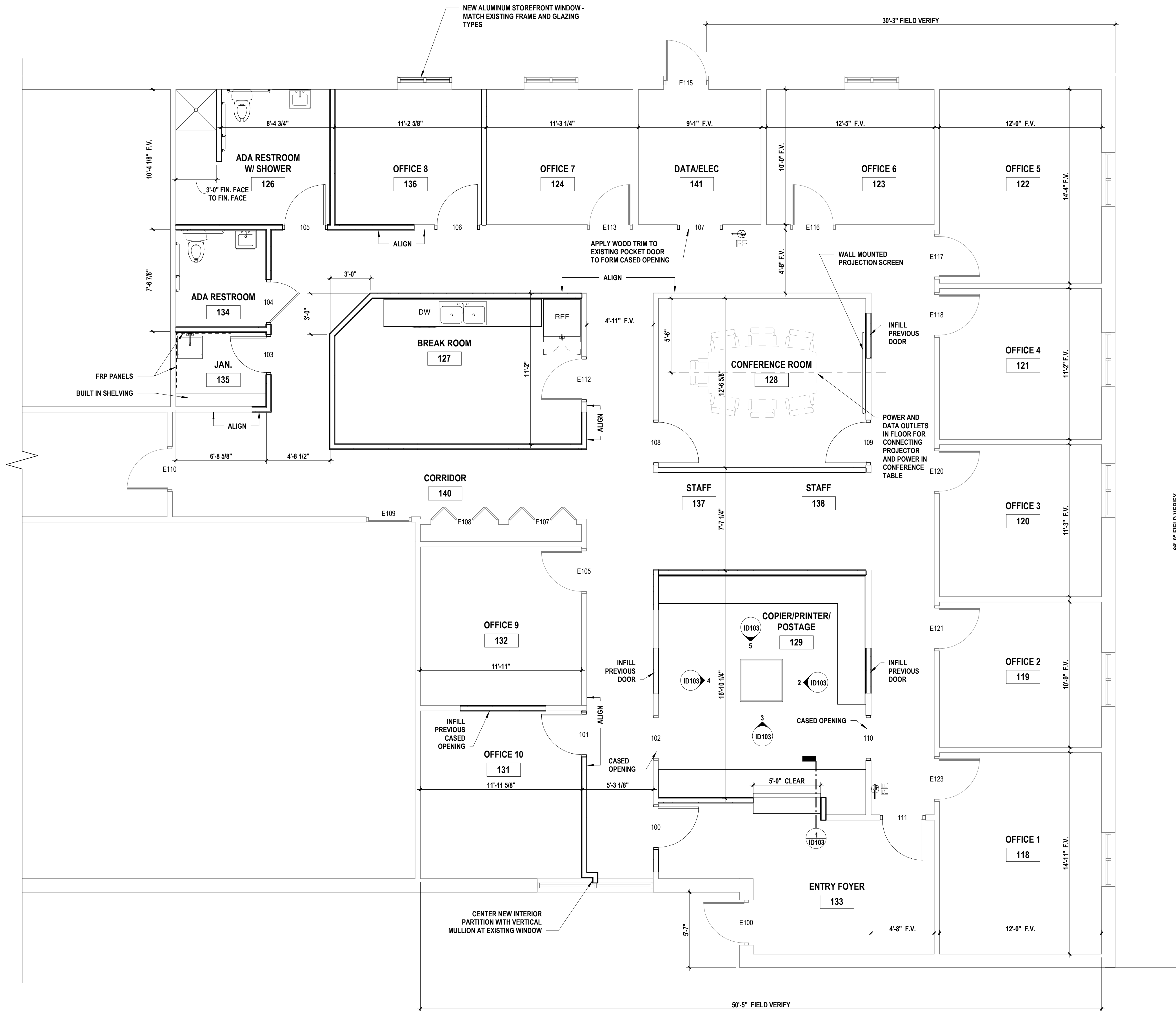

1 ARCHITECTURAL FLOOR PLAN

1/4" = 1'-0"

OFFICE AREA FOR CFO NETWORK

NORTH LITTLE ROCK, AR 72114



CONSTRUCTION DOCUMENTS

ARCHITECTURAL FLOOR PLAN

REVISIONS

NO.	DESCRIPTION	DATE

NOV. 16, 2018 :ISSUE DATE

18-031 :PROJECT NUMBER

A102 :SHEET NUMBER