

welltower

MEDICAL OFFICE SPACE

FOR LEASE

Click or Scan Below



For Information:

RYAN LEWIS
AVP, Leasing
561.354.4822
rlewis@welltower.com

330 Physicians Center

330 TURNER MCCALL BLVD SW | ROME, GA

medicaloffice.welltower.com

EXECUTIVE SUMMARY



Location Description

At the corner of N 2nd Ave NW and Turner McCall Blvd SW

Property Highlights

- On campus of the Floyd Medical Center
- Close to shopping and restaurants
- Close to Shorter University, Barron Stadium, & Heritage Park
- Less than 1 mile from Historic District

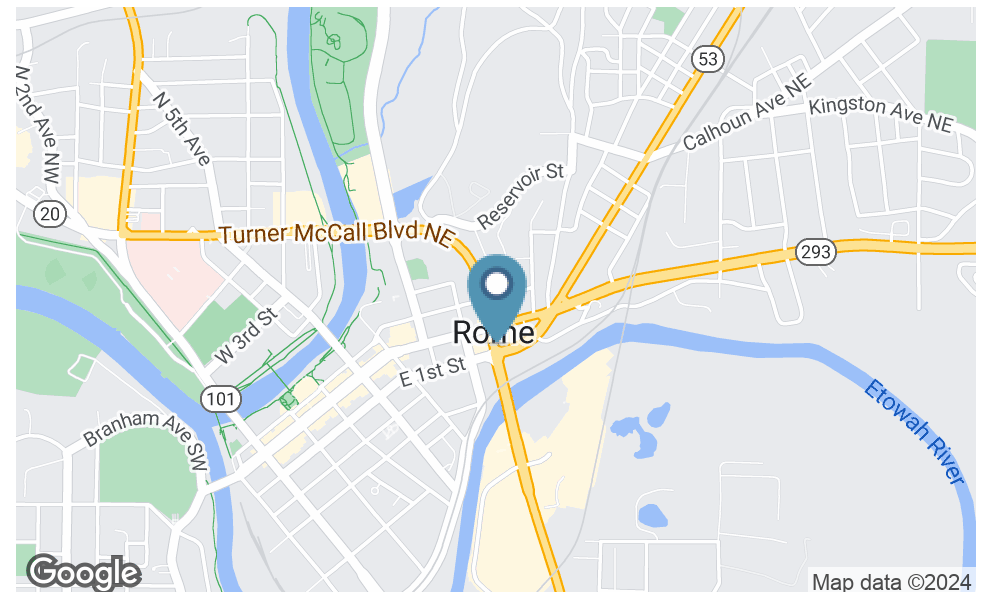

SUITE 4000

welltower

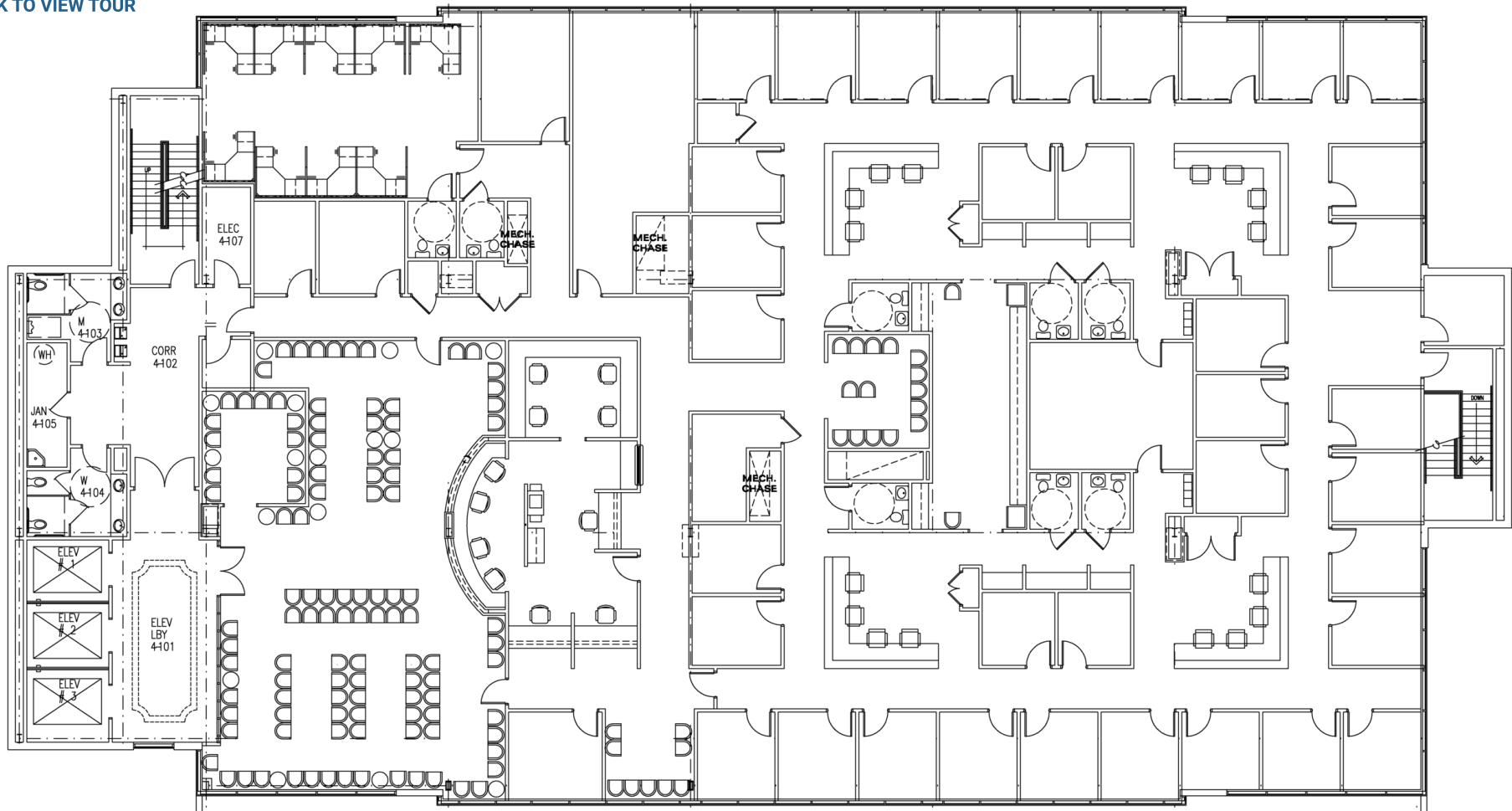

16,527 RSF

Existing Layout

RYAN LEWIS

AVP, Leasing
561.354.4822
rlewis@welltower.com

SUITE 4000



3,366 - 5,032 RSF

Proposed Multi-Tenant Layout

RYAN LEWIS

AVP, Leasing
561.354.4822
rlewis@welltower.com

DEMOGRAPHICS MAP & REPORT



Population

	1 Mile	5 Miles	10 Miles
Total Population	3,661	48,089	94,146
Average Age	36.9	35.1	36.6
Average Age (Male)	33.6	33.9	35.6
Average Age (Female)	42.0	37.6	38.2

Households & Income

	1 Mile	5 Miles	10 Miles
Total Households	1,545	17,774	34,572
# of Persons per HH	2.4	2.7	2.7
Average HH Income	\$42,103	\$51,079	\$53,569
Average House Value	\$188,865	\$146,228	\$148,449

Ethnicity (%)

	1 Mile	5 Miles	10 Miles
Hispanic	11.8%	13.0%	10.4%

Race

	1 Mile	5 Miles	10 Miles
Total Population - White	2,104	32,452	71,203
Total Population - Black	1,311	11,677	16,155
Total Population - Asian	8	723	1,461
Total Population - Hawaiian	0	28	66
Total Population - American Indian	17	311	381
Total Population - Other	165	2,057	3,287

Traffic Counts

/day

* Demographic data derived from 2020 ACS - US Census

RYAN LEWIS

AVP, Leasing
561.354.4822
rlewis@welltower.com

