

Available SF 41,460 SF

Industrial For Sale

Building Size 41,460 SF



**Address:** 8001 Beach St, Los Angeles, CA 90001

**Cross Streets:** Beach St/Nadeau St

Low-Cost Multi-Purpose Facility for User/Investors  
36,200 SF DH Bldg + 5,260 SF Metal Bldg - Potential to Divide  
1600 Amp 277/480 Volt 3 Phase 4 Wire Service with 4 Meters  
\$10k/Month Rent from MTM Tenant in Front 12,200 SF  
Unincorporated Los Angeles County - No Gross Receipt Tax  
West of Alameda Street - Approx. 2 Miles from 105 & 110 Fwys

**Sale Price:** \$5,500,000.00  
**Sale Price/SF:** \$132.66  
**Available SF:** 41,460 SF  
**Prop Lot Size:** 1.20 Ac / 52,185 SF  
**Taxes:**  
**Yard:** Fenced / Paved  
**Zoning:** SP-MU3

**Sprinklered:** Yes  
**Clear Height:** 12' - 20'  
**GL Doors/Dim:** 3 / 20'x10'; (2) 14'x12'  
**DH Doors/Dim:** 4 / (20'x13'); (20'x11')  
**A: 1600 V: 277/480 O: 3 W: 4**  
**Construction Type:** Masonry  
**Const Status/Year Blt:** Existing / 1938

**Whse HVAC:** No  
**Parking Spaces: 12 / Ratio: 0.3:1**  
**Rail Service:** No  
**Specific Use:** Warehouse/Office

**Office SF / #:** 1,350 SF / 4  
**Restrooms:** 4  
**Office HVAC:** Heat & AC  
**Finished Ofc Mezz:** 0 SF  
**Include In Available:** No  
**Unfinished Mezz:** 0 SF  
**Include In Available:** No  
**Possession:** COE  
**Vacant:** No  
**To Show:** Call broker  
**Market/Submarket:** Outlying Los Angeles  
**APN#:** 6027-016-003

**Listing Company:** Dorin Realty Company  
**Agents:** [Mark Whitman 213-627-0007](mailto:mwhitman@dorinrealty.com)

**Listing #:** 43515999 **Listing Date:** 10/09/2025

**FTCF:** CB250Y175S250

**Notes:** No permit for 1,440 SF of metal building. All details must be verified. Taxes: TBD.



**Mark Whitman**  
mwhitman@dorinrealty.com  
213-627-0007

## 8001 Beach Street, Los Angeles, CA 90001

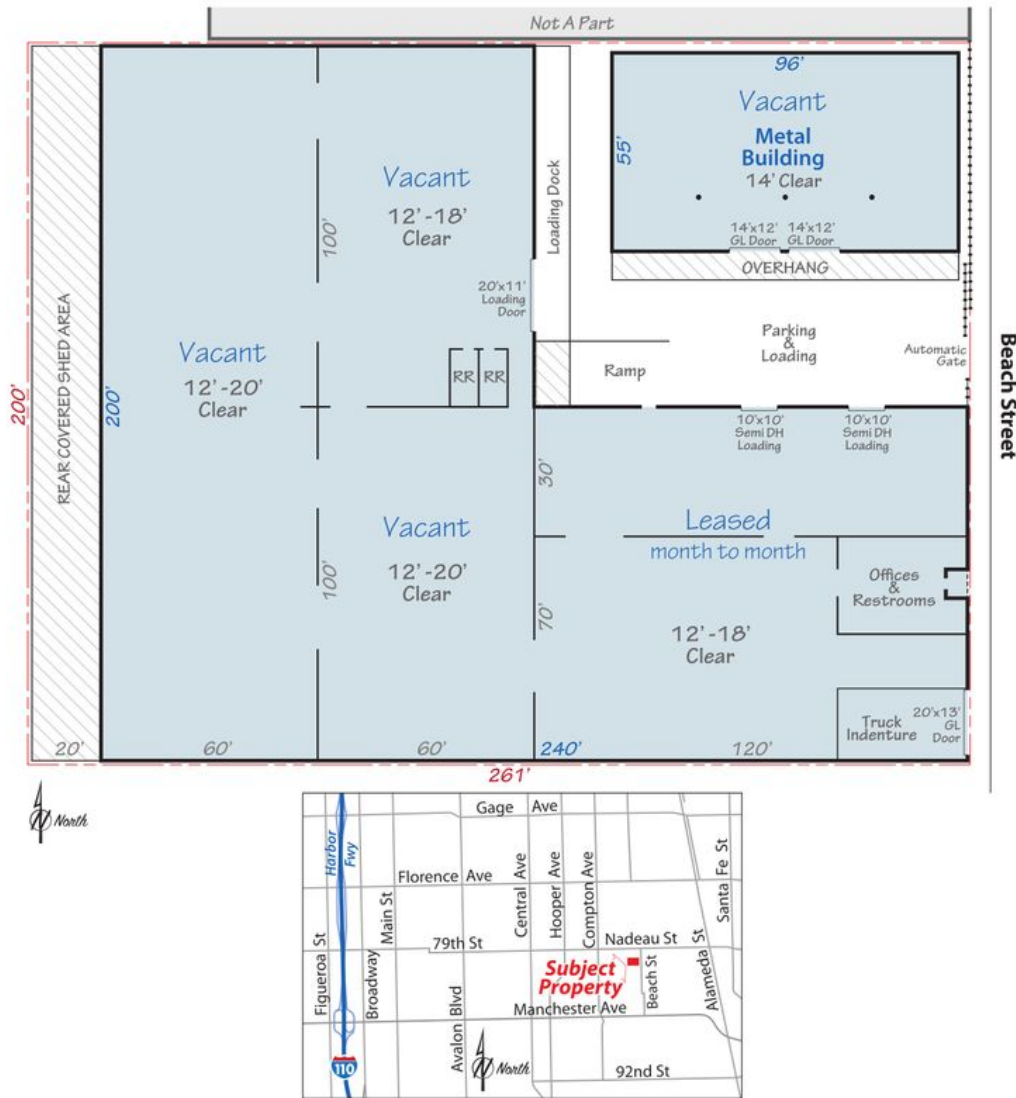

Contact exclusive agent:

**Mark Whitman**

Lic. No. 00918875

mwhitman@dorinrealty.com

**213-627-0007 Ext 124**

4555 Pacific Blvd., Vernon, CA 90058-2207

Industrial and Commercial Real Estate Specialists

Since 1959

[www.dorinrealty.com](http://www.dorinrealty.com)

The information contained herein is from sources we believe to be reliable but, we do not guarantee its accuracy. All measurements & dimensions are approximations and are not to scale. Clients are encouraged to verify their accuracy.



**Mark Whitman**

mwhitman@dorinrealty.com

213-627-0007



Powered by

**MOODY'S**