

FOR LEASE

GATOR CHERRY HILL

INVESTMENTS 2375 NJ-70 | CHERRY HILL, NJ 08002



PROPERTY OVERVIEW

- Free Standing Building
- GLA of +/- 8,842 SF

LOCATION OVERVIEW

- Direct Frontage to Marlton Pike W/Rte 70
- Nearest Intersection: West of Donahue Avenue & Marlton Pike W/Rte 70
- Camden County
- Traffic Count: 45,000 AADT

www.GatorInvestments.com

7850 NW 146th Street, 4th Floor | Miami Lakes | FL 33016

James A. Goldsmith, Lic. Real Estate Broker

LEASING INFO: 877.459.9605

Leasing@GatorInvestments.com

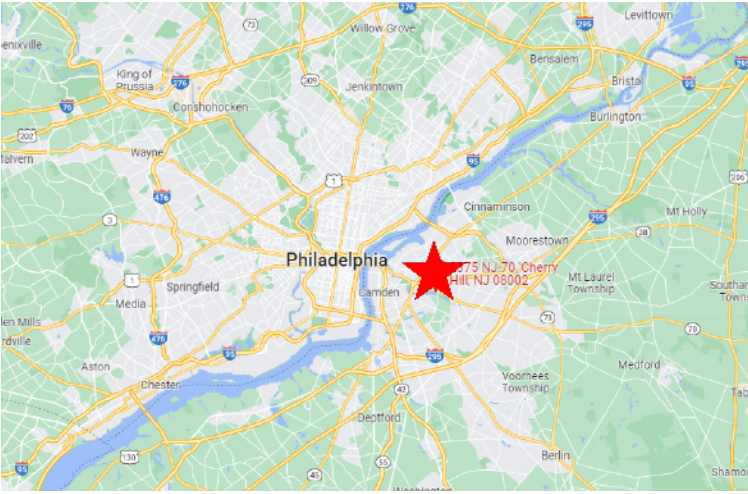

DEMOGRAPHICS

• 2021

**2375 NJ-70
CHERRY HILL, NJ 08002**

TRADE AREA	1 MILE	3 MILE	5 MILE
POPULATION	12,501	163,622	363,055
AVG. HH INCOME	\$98,277	\$87,573	\$93,806
AVG. AGE	41	37	38

MARLTON PIKE

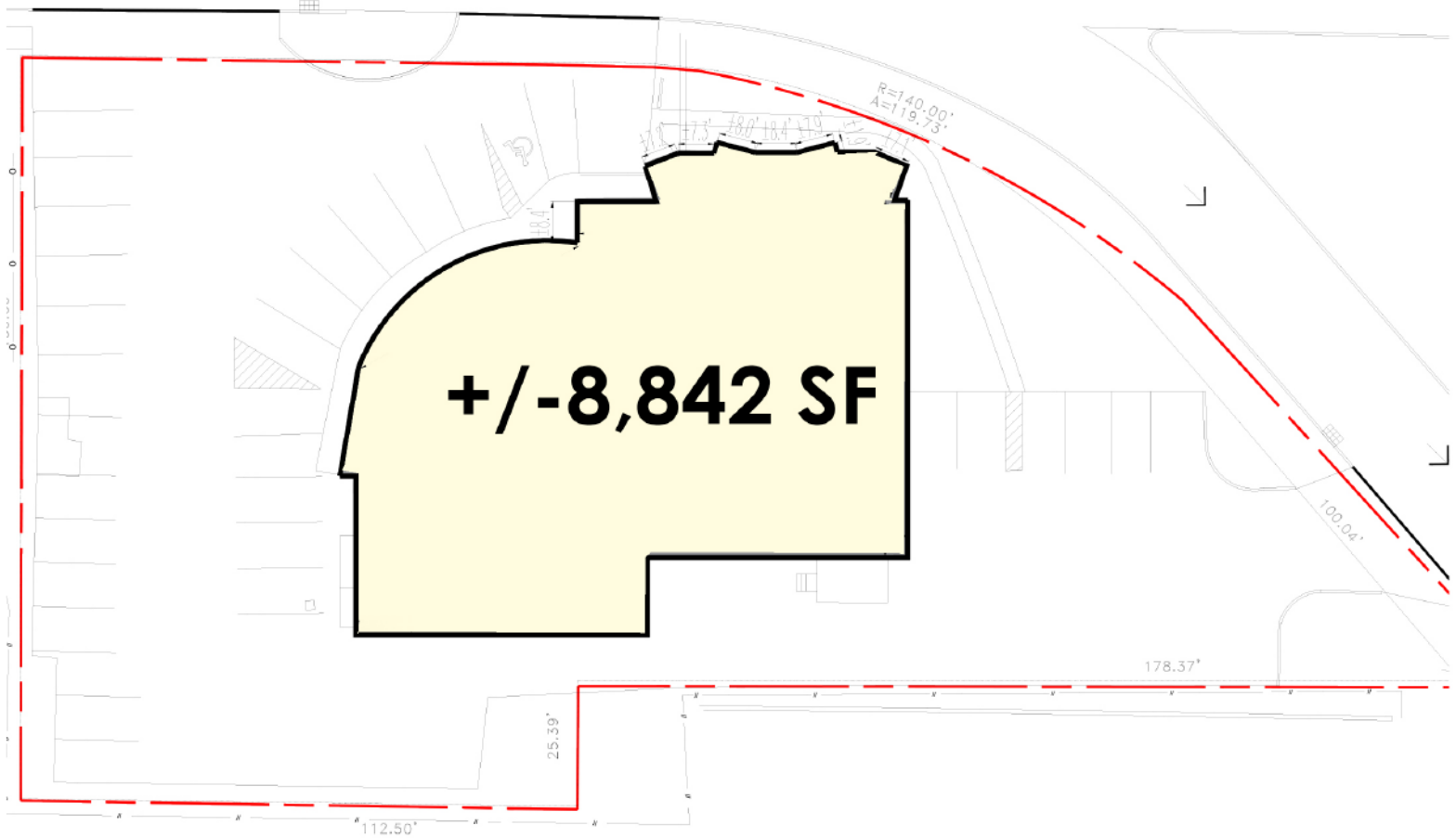

Owned and Operated By A
GATOR
Affiliated Company

www.GatorInvestments.com

7850 NW 146th Street, 4th Floor | Miami Lakes | FL 33016

James A. Goldsmith, Lic. Real Estate Broker

LEASING INFO: 877.459.9605

Leasing@GatorInvestments.com