

Riverview Solar Technology Park Now Leasing Office Space



TONAWANDA, NY
400 Riverwalk Parkway



Available Office Space
Suite 150 - 2,750 Sq. Ft.
Suite 500 - 1,900 Sq. Ft.



TM Montante
DEVELOPMENT



LOCATION

- Within 10 Minutes of Downtown Buffalo & Canada
- Approximately 1 Mile from I-190 and I-290
- Free Parking

FEATURING

- Reduced Energy Costs Due to Solar Energy
- 2,750 Sq. Ft. of Office Space
- 1,900 Sq. Ft. of Office Space



For More Information

Contact: TM Montante Development
Info @Montante.com | 716-876-889 9

Now Leasing Office Space



TONAWANDA, NY
400 Riverwalk Parkway

SUITE 150 - 2,750 SF

SUITE 500 - 1,900 SF

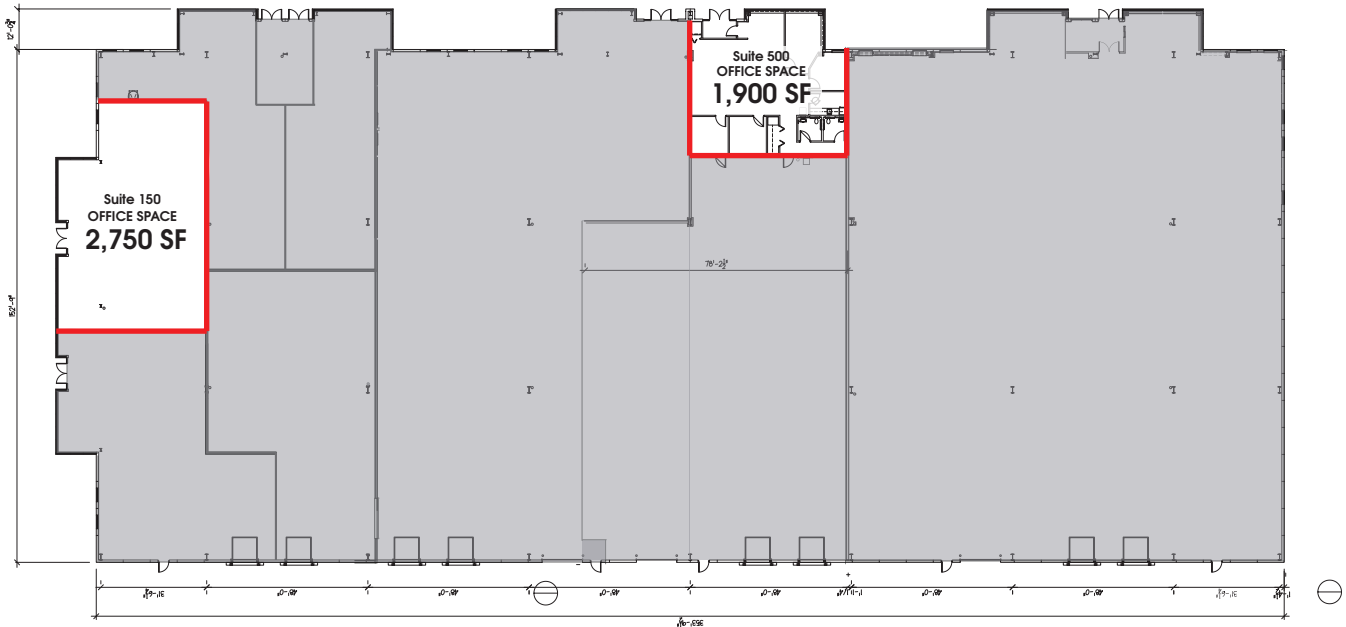

Approximately 4,650 Sq.Ft.

For More Information

Contact: TM Montante Development
Info @Montante.com | 716-876-889 9