

**BEAUTY SUPPLY**  
COSMETICS · WIGS · JEWELRY · SALON BARBER SUPPLIES

**WONDER BEAUTY**

SUITS  
JACKETS

SPORTS WEAR  
ACCESSORIES

JEANS  
SHOES



**GameStop**

For Lease

# 370 Knickerbocker Ave

High Foot Traffic Retail For Lease | 2,500 - 3,300 SF

**MRG**  
Momentum Realty Group

# Property Details

## OVERVIEW

|               |   |
|---------------|---|
| ADDRESS       | 370 Knickerbocker Ave, Brooklyn, NY 11237 |
| CROSS STREETS | Stockholm Street and Stanhope Street      |
| NEIGHBORHOOD  | Bushwick                                  |

## SPACE DETAILS

|                |                     |
|----------------|---------------------|
| TOTAL SF       | 2,500 - 3,300 sq ft |
| CEILING HEIGHT | 10 ft               |
| FRONTAGE       | 27 ft               |

## HIGHLIGHTS

- Prime Bushwick Retail Corridor
- Steps from the M train
- Glass Storefront
- High Foot Traffic

## NEIGHBORS



More Than Brokers.  
Trusted Partners.

# Floor Plan

---

**Basement**

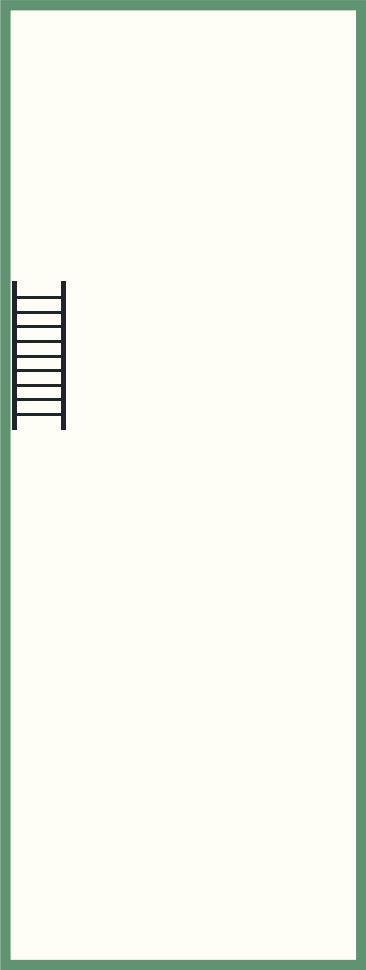

**Ground Floor**

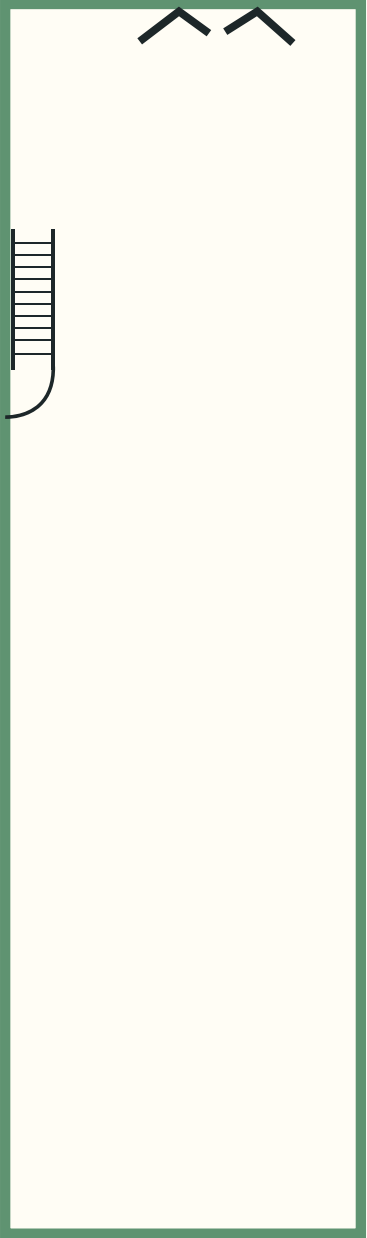

# Location Overview

## TRANSPORTATION



**B26, B52 Buses**  
1 min walk to bus lines



**Train M**  
5 min walk to subway



**LGA Airport** | **JFK Airport** | **EWR Airport**  
20 min drive | 25 min drive | 35 min drive

## DEMOGRAPHICS



**Population**  
49,896



**Median Household Income**  
\$81,245



**Median Home Value**  
\$965,400





# 370 Knickerbocker Avenue

---

370 Knickerbocker Avenue  
Brooklyn, NY 11237  
2,500-3,300 sq ft · For Lease

## INQUIRIES

*To arrange a showing or discuss leasing terms, please reach out to one of our agents directly.*

---

**Moshe Akiva**

Moshe@mrgny.com  
212-314-4684 · Ext. 103

---

**Victor Safenia**

Victors@mrgny.com  
212-314-4684 · Ext. 107

---

*All information supplied in this marketing presentation and/or flyer is from sources deemed reliable and is furnished subject to errors, omissions, modifications, removal of listings from sale/lease and to any listing condition. Any square footage, dimensions, floor plans and/or technical data set forth are approximations and are subject to further elaboration/confirmation.*