



FOR SALE OR LEASE

±7,630 SF Office/Flex Building

5139-5145 JOHNSON DRIVE, PLEASANTON 94588

LOCAL EXPERTISE. INTERNATIONAL REACH. WORLD CLASS.

Ryan Taurek

Associate
rtaurek@lee-associates.com
925-737-4157
LIC NO 02235311

Sean Offers, SIOR

Principal
soffers@lee-associates.com
925-737-4159
LIC NO 01858116

Mark Rinkle

Principal
mrinkle@lee-associates.com
925-737-4145
LIC NO 01512632



Johnson Drive

5139-5145
JOHNSON DRIVE

PROPERTY HIGHLIGHTS



±7,630 SF Office/Flex Building Available for Sale

±1,323-±5,883 SF Available For Lease

- Versatile layouts
- Potential for Grade Level Door Access
- Common area Restrooms (2)
- Single story building



3.3/±1,000 parking ratio, Excellent parking



Tenant Improvement Allowance Available



Solar Panel System on roof



Walking distance to various services and amenities



Close proximity to Dublin/Pleasanton BART Station



Excellent freeway access to I-580 and I-680



Contact Brokers for Pricing Details

5139-5145 JOHNSON DRIVE

*FLOOR PLAN NOT TO SCALE

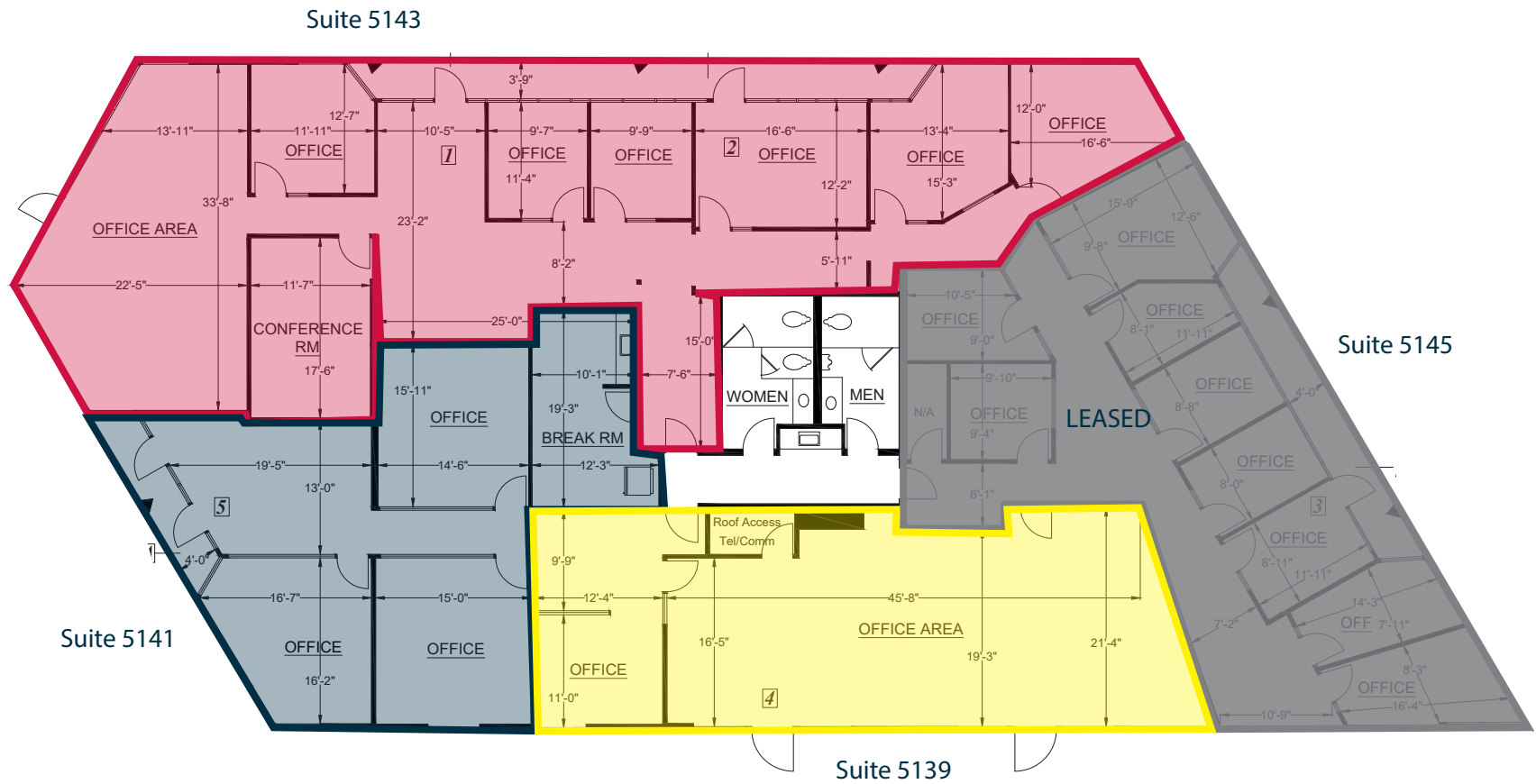

Up to 7,630SF Available
Potential Different Office Configurations Shown By Color Variance

- Common Area Restroom
- Suite 5145 - 1,797SF *Leased*
- Suite 5143 - 2,949 SF
- Suite 5141 -1,561 SF
- Suite 5139 -1,323 SF

5139-5145
JOHNSON DRIVE



DOUGHERTY ROAD

OWENS DRIVE

JOHNSON DRIVE

HOPYARD ROAD



FOR SALE OR LEASE

UP TO ±7,630 SF OF OFFICE/FLEX SPACE AVAILABLE

5139-5145 JOHNSON DRIVE | PLEASANTON CA 94588



Ryan Taurek

Associate
rtaurek@lee-associates.com
925-737-4157
LIC NO 02235311



Sean Offers, SIOR

Principal
soffers@lee-associates.com
925-737-4159
LIC NO 01858116



Mark Rinkle

Principal
mrinkle@lee-associates.com
925-737-4145
LIC NO 01512632

INFORMATION DISCLOSURE

This offering has been prepared solely for informational purposes. It is designed to assist a potential investor in determining whether it wishes to proceed with an in-depth investigation of the subject property. While the information contained herein is from sources deemed reliable, it has not been independently verified by Lee & Associates - East Bay, Inc., its affiliates, or by the Seller. The projections and pro forma budget contained herein represent best estimates on assumptions considered reasonable under the circumstances. No representations or warranties, expressed or implied, are made that actual results will conform to such projections. This document is provided subject to errors, omissions and changes in the information and is subject to modification or withdrawal. The contents herein are confidential and are not to be reproduced without the express written consent of Lee & Associates - East Bay, Inc. Interested buyers should be aware that the Seller is selling the Property in "AS IS" CONDITION WITH ALL FAULTS, WITHOUT REPRESENTATIONS OR WARRANTIES OF ANY KIND OR NATURE. Prior to and/or after contracting to purchase, as appropriate, buyer will be given a reasonable independently or through agents of the buyer's choosing. The Seller reserves the right to withdraw the Property being marketed at any time without notice, to reject all offers, and to accept any offer without regard to the relative price and terms of any other offer. Any offer to buy must be: (i) presented in the form of a non-binding letter of intent (ii) incorporated in a formal written contract of purchase and sale to be prepared by the Seller and executed by both parties and executed by both parties; and (iii) approved by Seller and such other parties who may have an interest in the Property. Neither the prospective buyer nor Seller shall be bound until execution of the contract of purchase and sale, which contract shall supersede prior discussions and writings and shall constitute the sole agreement of the parties. Prospective buyers shall be responsible for their costs and expenses of investigating the Property and all other expenses, professional or otherwise, incurred by them.

Lee & Associates® East Bay, Inc. Corp. ID 01194869 5000 Pleasanton Ave, Suite 220, Pleasanton, CA 94566

LEE-ASSOCIATES.COM

5139-5145 JOHNSON DRIVE