

# Princeton Corporate Plaza laboratory & research center



inspiring innovation.



## who we are

Princeton Corporate Plaza is ideally located in the biotech hub of New Jersey, on the Princeton-Rutgers Route 1 corridor, known as "Einstein Alley." With easy access to both New York City and Philadelphia, we offer fully furnished lab space for any size company.

Our Research Center is one of New Jersey's most successful laboratory facilities, hosting a wide range of scientific R&D companies for over 35 years. We are home to 80+ companies including: BioCentriq, HotSpot Therapeutics, Orthobond, Elucida Oncology, Praxgen Pharmaceuticals, Alliance Technologies, Signum Biosciences, DeWolf Chemical, Taxis Pharmaceuticals, Palatin Technologies & American Cryostem Corp.

The Kent's see our 250,000 SF complex as a constantly evolving facility, growing to meet the needs of existing tenants while retaining the capacity to accommodate new companies. At Princeton Corporate Plaza we are committed to investing in the success of our tenants.



# Princeton Corporate Plaza laboratory & research center



our science park advantages



## what we do

- Fully fit out laboratory & office space
- 24/7 on-site management team
- Custom space design by in-house architectural team
- Ability to expand & sub-divide: 300 sf — 60,000 sf
- Flexible lease lengths & competitive rates
- Home to 80+ scientific companies of all sizes & areas of research
- Adjacent hotel for traveling guests
- Beautiful park setting



# Princeton Corporate Plaza laboratory & research center



## news & developments

### new 60,000sf facility planned for 2024

Due to the expansion requirements of our tenants and the demand for space from new clients, construction has started on our 5<sup>th</sup> building – a new 60,000 sf laboratory facility

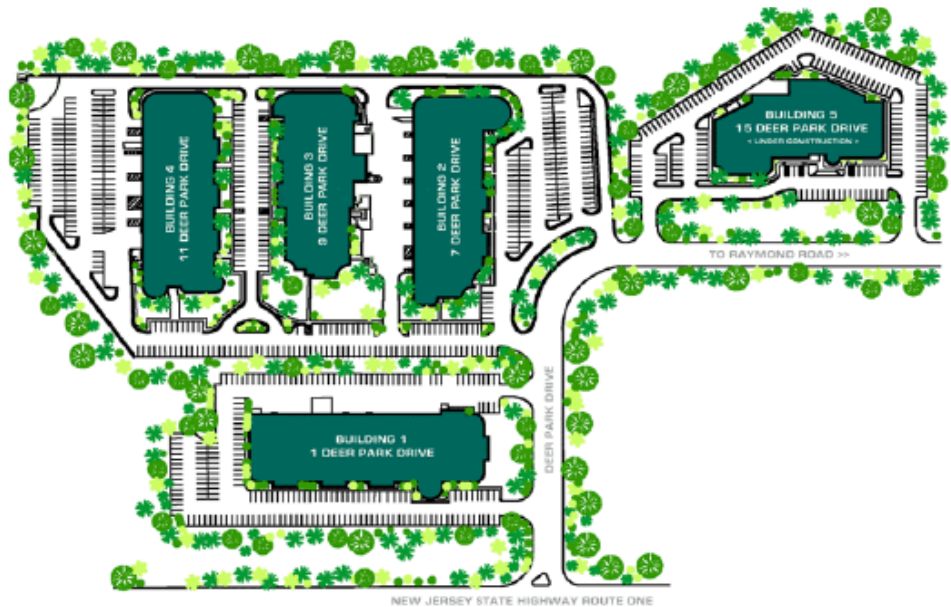

# Princeton Corporate Plaza laboratory & research center



## Kent Management

7 Deer Park Drive | Suite A  
Monmouth Junction, NJ 08852

Contact: Jessie Kent

p | 732-329-3655

e | [jkent@kentmgmt.com](mailto:jkent@kentmgmt.com)

[princetoncorporateplaza.com](http://princetoncorporateplaza.com)

