



FOR SALE OR FOR LEASE

3120 N. Roemer Appleton, WI



**INDUSTRIAL /
WAREHOUSE /
STORAGE**



BUILT 1985
BUILDING SIZE 31,030 SF
CLEAR HEIGHT 10' - 22'
DOCK DOORS 4
DRIVE-IN DOORS 1
LOT SIZE 3.10 Acres
PARCEL # 31-1-5298-00 / 1-5298
2018 TAXES 17,001.61
TRAFFIC COUNTS 2,500 vehicles per day
LOCATION Easy access to  & 

LEASE RATE \$4.75-\$5.25 / PSF

PURCHASE PRICE \$1,199,999

ZONED..... Commercial

Teresa Lingg
(920) 427.9473

tlingg@commercialhorizons.com

Mike Maedke
(920) 360.7100

mmaedke@commercialhorizons.com

For more information:

GREEN BAY

111 N. Washington St. #400 Green Bay, WI 54301 (920) 434.7800

FOX CITIES

100 W. Lawrence St #214 Appleton, WI 54911 (920) 830.9646

FOR SALE OR FOR LEASE

3120 N. Roemer Appleton, WI

Industrial



INTERIOR



GREEN BAY

111 N. Washington St. #400 Green Bay, WI 54301 (920) 434.7800

FOX CITIES

100 W. Lawrence St #214 Appleton, WI 54911 (920) 830.9646

FOR SALE OR FOR LEASE

Industrial



3120 N. Roemer Appleton, WI

FLOORPLAN

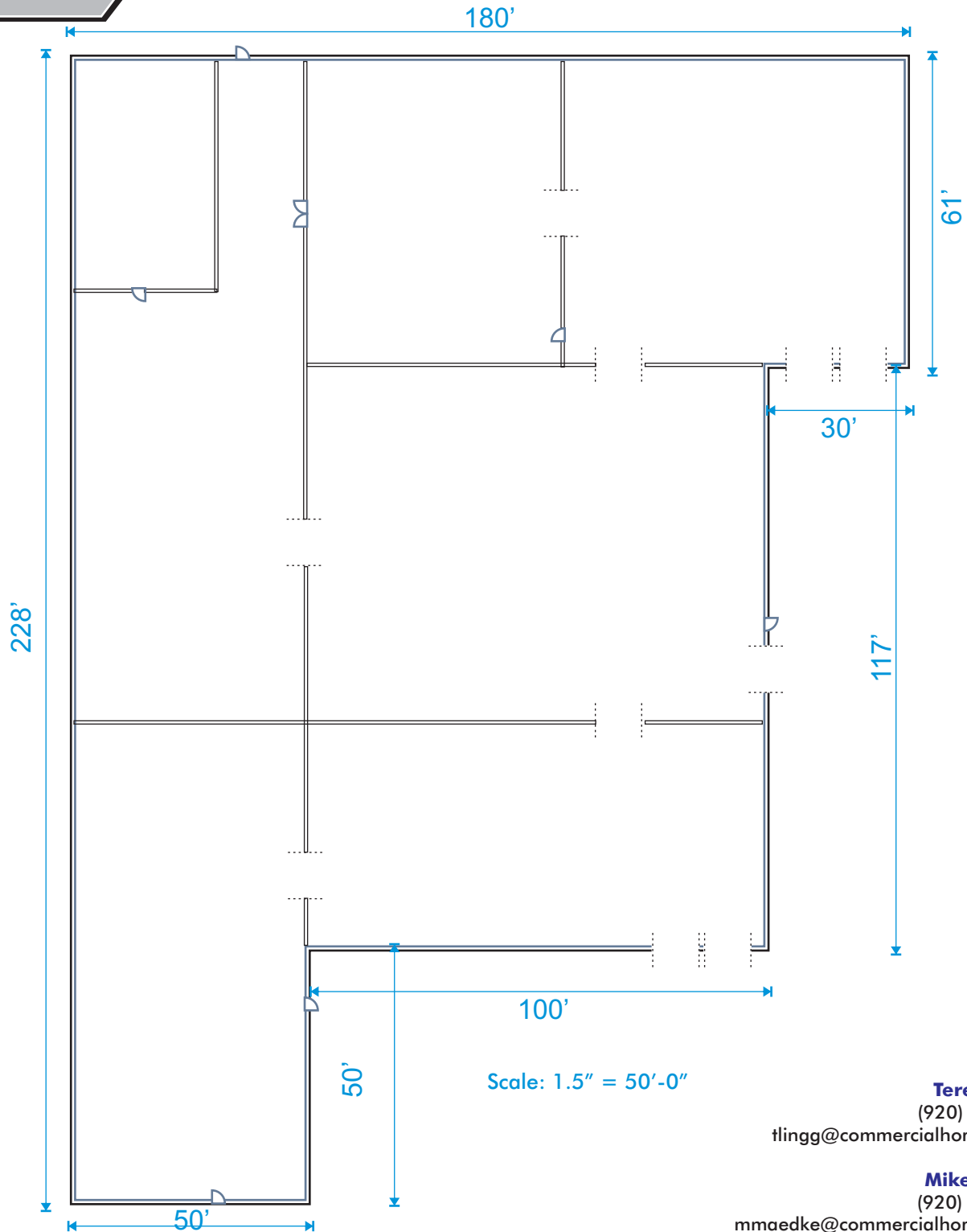

Teresa Lingg
(920) 427.9473
tlingg@commercialhorizons.com

Mike Maedke
(920) 360.7100
mmaedke@commercialhorizons.com

For more information:

GREEN BAY

111 N. Washington St. #400 Green Bay, WI 54301 (920) 434.7800

FOX CITIES

100 W. Lawrence St #214 Appleton, WI 54911 (920) 830.9646

FOR SALE OR FOR LEASE

Industrial



3120 N. Roemer Appleton, WI

AREA MAP



Teresa Lingg

(920) 427.9473

tlingg@commercialhorizons.com

Mike Maedke

(920) 360.7100

mmaedke@commercialhorizons.com

For more information:

GREEN BAY

111 N. Washington St. #400 Green Bay, WI 54301 (920) 434.7800

FOX CITIES

100 W. Lawrence St #214 Appleton, WI 54911 (920) 830.9646