



Specifications

±55,900 SF on 4 AC PROPOSED BUILDING	350' BUILDING WIDTH
±140' to 200' BUILDING DEPTH	ESFR SPRINKLER
±57'5" x 50' COLUMN SPACING	LED LIGHTING
±1,000 Amps POWER	39 Car Spaces PARKING
±36' Clear CEILING HEIGHT	
4 Docks, 2 Drive-Ins *4 Additional Dock Punch Outs LOADING	
Industrial (M2) ZONING	
8 Miles to NJ Turnpike 31 Miles to Newark Airport 32 Miles to New York City ACCESSIBILITY	

For additional property information or to arrange an inspection, please contact the exclusive brokers:

- Jason M. Crimmins, CCIM, SIOR, *Chief Executive Officer*, 973.379.6644 x 122, jmcrimmins@blauberg.com
- Alessandro (Alex) Conte, CCIM, SIOR, *President*, 973.379.6644 x 131, aconte@blauberg.com
- Peter J. Murano, Jr., *Managing Executive Director*, 973.379.6644 x 114, pjmurano@blauberg.com
- Rick Vanderbeck, *Executive Director*, 973.379.6644 x 237, rvanderbeck@blauberg.com



For additional property information or to arrange an inspection, please contact the exclusive brokers:
Jason M. Crimmins, CCIM, SIOR, *Chief Executive Officer*, 973.379.6644 x 122, jmcrimmins@blauberg.com
Alessandro (Alex) Conte, CCIM, SIOR, *President*, 973.379.6644 x 131, aconte@blauberg.com
Peter J. Murano, Jr., *Managing Executive Director*, 973.379.6644 x 114, pjmurano@blauberg.com
Rick Vanderbeck, *Executive Director*, 973.379.6644 x 237, rvanderbeck@blauberg.com

The information contained herein has been obtained from sources considered to be reliable, but no guarantee of its accuracy is made by this company. In addition, no representation is made respecting zoning, condition of title, dimensions, or any matters of a legal or environmental nature. Such matters should be referred to legal counsel for determination. Terms and conditions are subject to change without prior notice. Subject to errors and omissions.

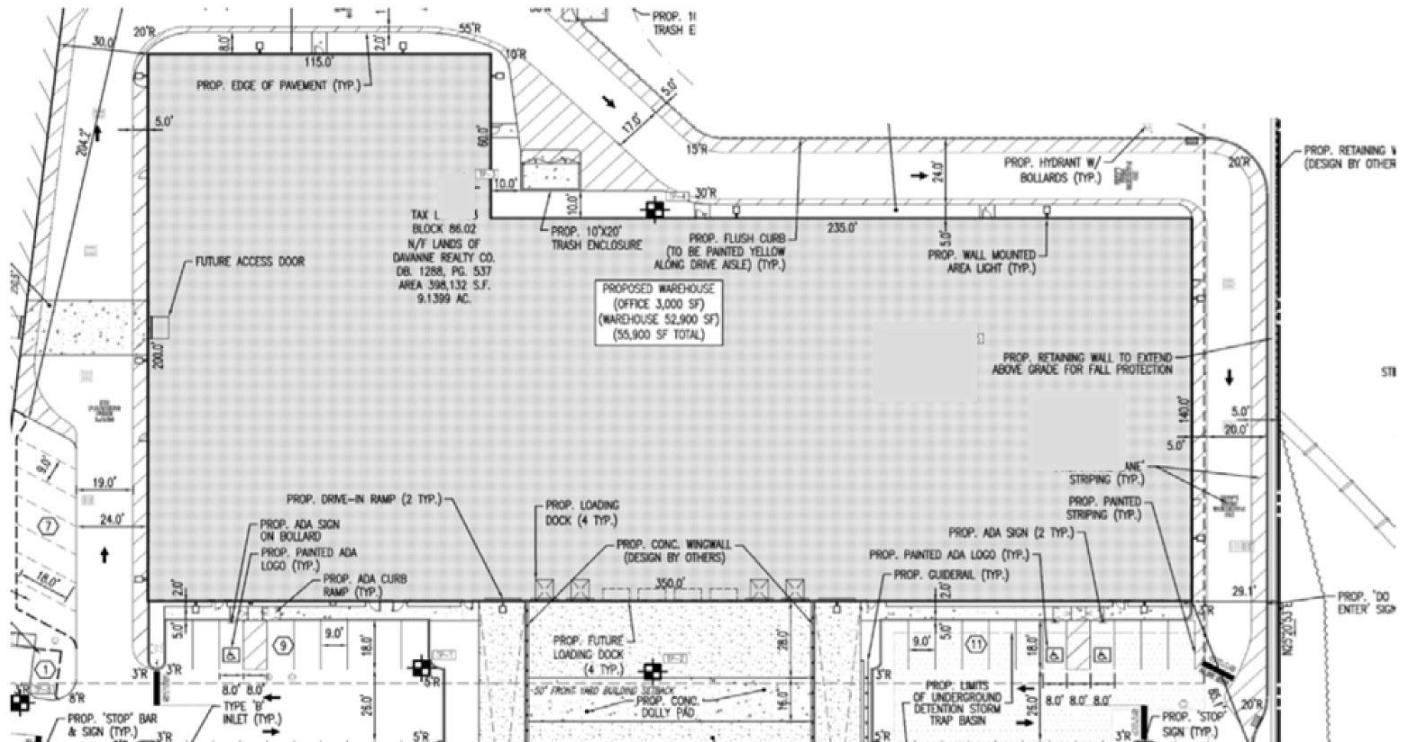

For additional property information or to arrange an inspection, please contact the exclusive brokers:

Jason M. Crimmins, CCIM, SIOR, *Chief Executive Officer*, 973.379.6644 x 122, jmcrimmins@blauberg.com

Alessandro (Alex) Conte, CCIM, SIOR, *President*, 973.379.6644 x 131, aconte@blauberg.com

Peter J. Murano, Jr., *Managing Executive Director*, 973.379.6644 x 114, pjmurano@blauberg.com

Rick Vanderbeck, *Executive Director*, 973.379.6644 x 237, rvanderbeck@blauberg.com

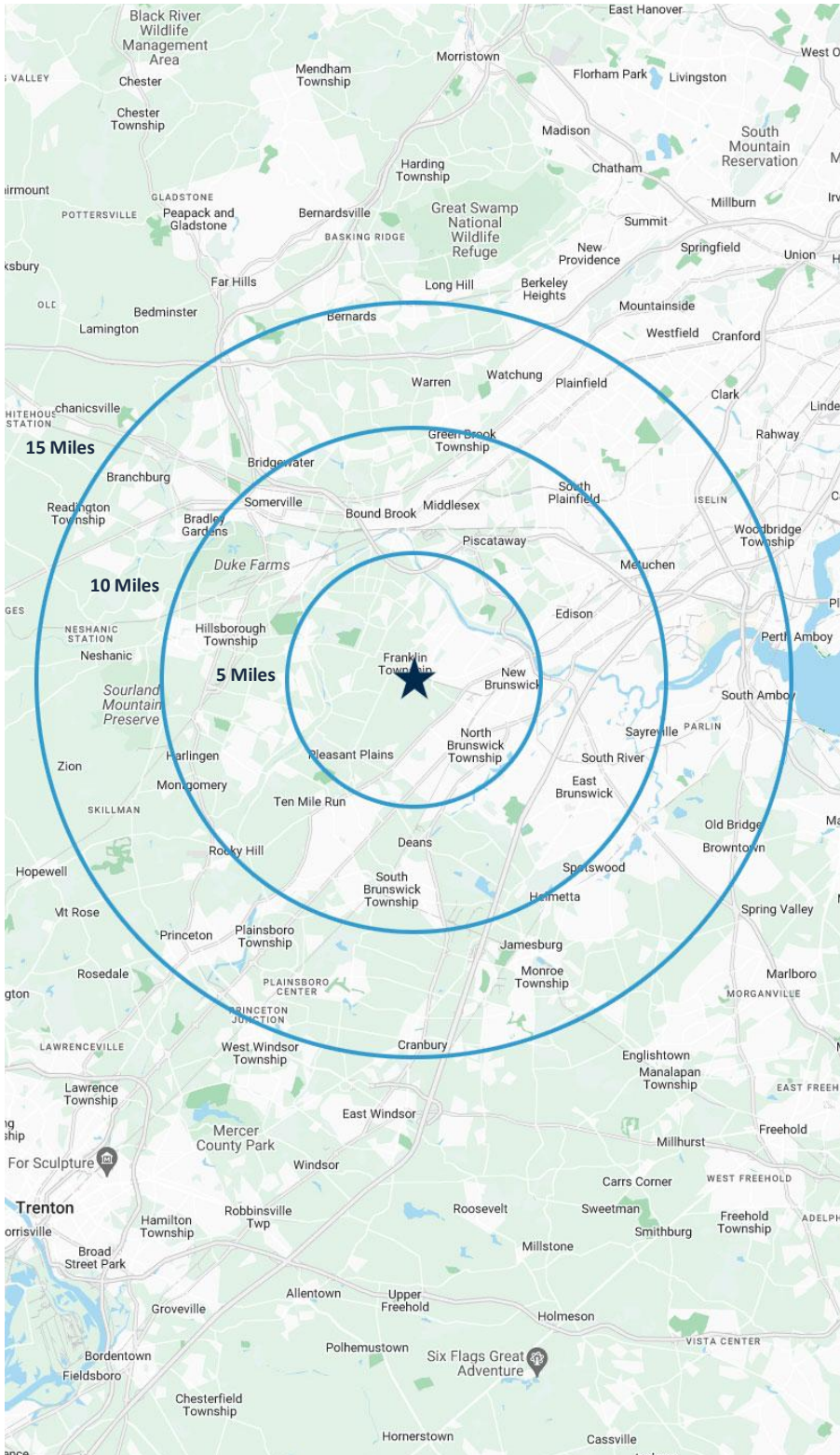

5 MILES

- Total Population: 224,596
- Households: 76,084
- Median Household Income: \$114,534
- Average Household Size: 2.7
- Transportation to Work: 120,999
- Labor Force: 185,512

10 MILES

- Total Population: 724,333
- Households: 254,418
- Median Household Income: \$129,819
- Average Household Size: 2.8
- Transportation to Work: 397,164
- Labor Force: 589,013

15 MILES

- Total Population: 1.44M
- Households: 519,540
- Median Household Income: \$133,076
- Average Household Size: 2.7
- Transportation to Work: 777,419
- Labor Force: 1.17M

For additional property information or to arrange an inspection, please contact the exclusive brokers:

Jason M. Crimmins, CCIM, SIOR, *Chief Executive Officer*, 973.379.6644 x 122, jmcrimmins@blauberg.com

Alessandro (Alex) Conte, CCIM, SIOR, *President*, 973.379.6644 x 131, aconte@blauberg.com

Peter J. Murano, Jr., *Managing Executive Director*, 973.379.6644 x 114, pjmurano@blauberg.com

Rick Vanderbeck, *Executive Director*, 973.379.6644 x 237, rvanderbeck@blauberg.com

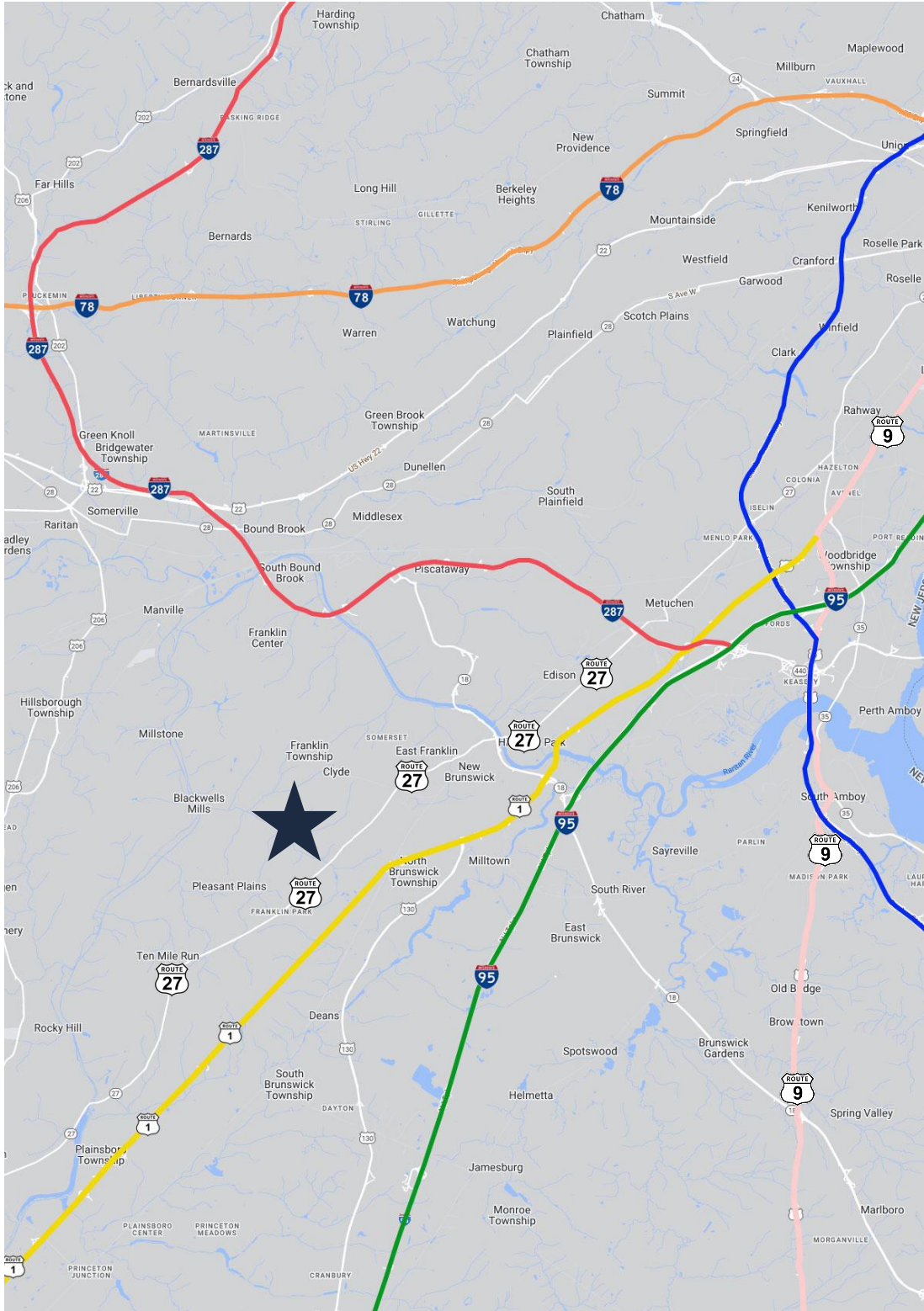

ACCESSIBILITY



1.8 MI
Route 27



4.4 MI
I-287



4.6 MI
US Hwy 1



8.2 MI
I-95 Exit 9



31.1 MI
Newark Airport

For additional property information or to arrange an inspection, please contact the exclusive brokers:

Jason M. Crimmins, CCIM, SIOR, *Chief Executive Officer*, 973.379.6644 x 122, jmcrimmins@blauberg.com

Alessandro (Alex) Conte, CCIM, SIOR, *President*, 973.379.6644 x 131, aconte@blauberg.com

Peter J. Murano, Jr., *Managing Executive Director*, 973.379.6644 x 114, pjmurano@blauberg.com

Rick Vanderbeck, *Executive Director*, 973.379.6644 x 237, rvanderbeck@blauberg.com

The information contained herein has been obtained from sources considered to be reliable, but no guarantee of its accuracy is made by this company. In addition, no representation is made respecting zoning, condition of title, dimensions, or any matters of a legal or environmental nature. Such matters should be referred to legal counsel for determination. Terms and conditions are subject to change without prior notice. Subject to errors and omissions.