



Newly renovated multi-user warehouse

- Located in the Denver Submarket
- Convenient access to I-25 via West 6th Avenue
- Upgrades include new warehouse unit heaters, new carpet and paint, new ceiling tiles, and new LED lighting
- See page 2 for a complete unit breakdown

Building size	14,000 sf
Available	Unit A - 8,000 sf
Lease rate	\$12.50/sf NNN
NNN	\$5.23/sf
Year built/reno	1959/2025
Zoning	I-1
Power	800 amps (TBV)
Clear height	14'
County	Denver
Parking	14 surface spaces

Get more information

Dawn McCombs
Principal
+1 720 508 8110
dawn.mccombs@avisonyoung.com

Ryan Almaleh
Vice President
+1 303 390 0961
ryan.almaleh@avisonyoung.com

Floor plan

Available

Unit A- 8,000 sf

- Approx. 1,322 sf office
- Approx. 6,678 sf warehouse
- (2) 10x10 drive-in doors
- (1) floor drain
- (8) allocated parking spaces

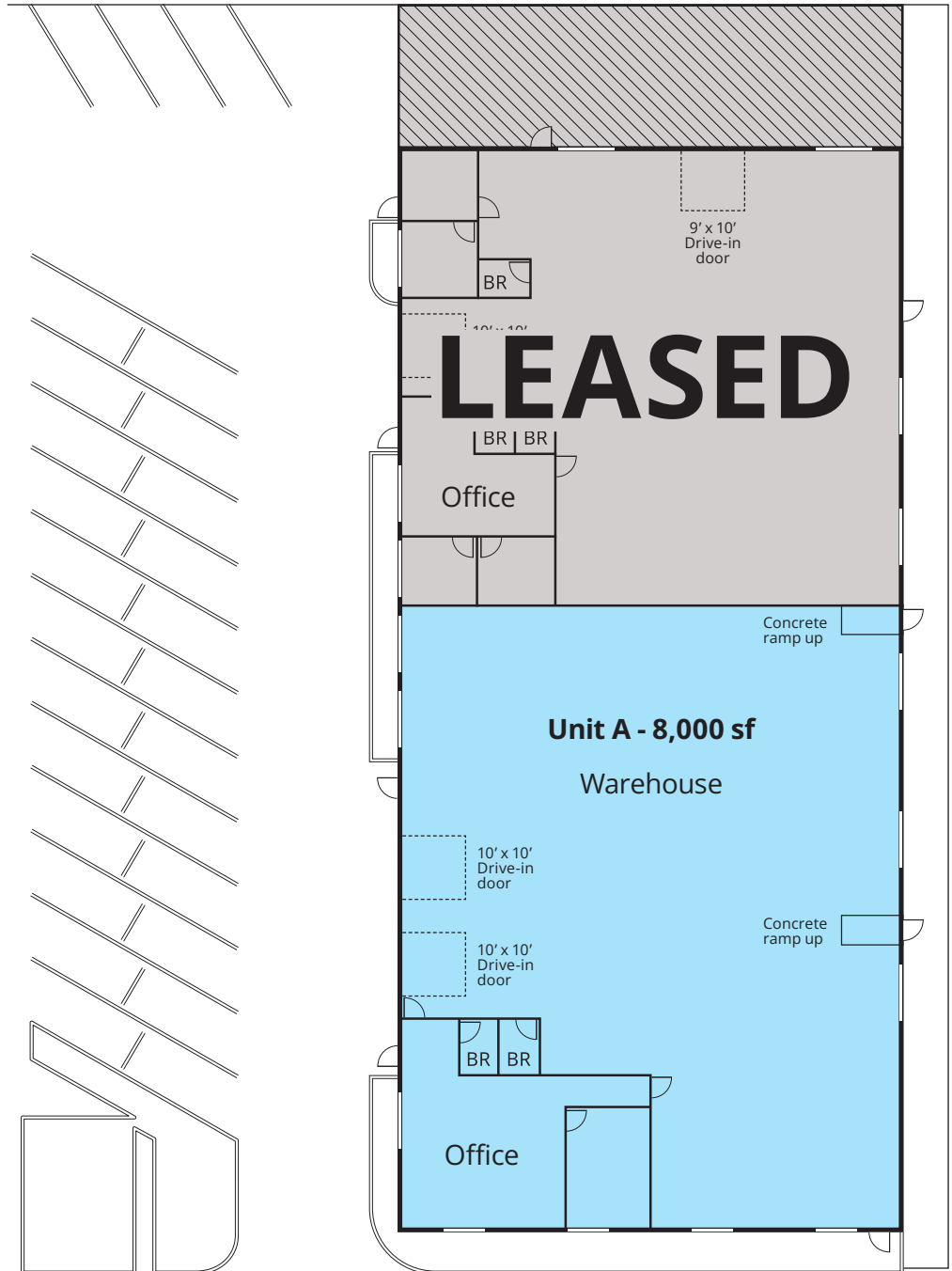

Sizes and dimensions are approximate, actual may vary.

Get more information

Dawn McCombs

Principal
+1 720 508 8110
dawn.mccombs@avisonyoung.com

Ryan Almaleh

Vice President
+1 303 390 0961
ryan.almaleh@avisonyoung.com

Unit A – Office and warehouse



**Get more
information**

Dawn McCombs
Principal
+1 720 508 8110
dawn.mccombs@avisonyoung.com

Ryan Almaleh
Vice President
+1 303 390 0961
ryan.almaleh@avisonyoung.com



Get more information

Dawn McCombs

Principal
+1 720 508 8110
dawn.mccombs@avisonyoung.com

Ryan Almaleh

Vice President
+1 303 390 0961
ryan.almaleh@avisonyoung.com