

Available For Sale

TRI-CITY MEDICAL PARK

*Three Medical/Office Condos
784 SF / 1,008 SF / 1,050 SF
Available in Oceanside, California.*

3230 WARING COURT
OCEANSIDE, CA 92056

 **Kidder
Mathews**

TRI-CITY MEDICAL PARK

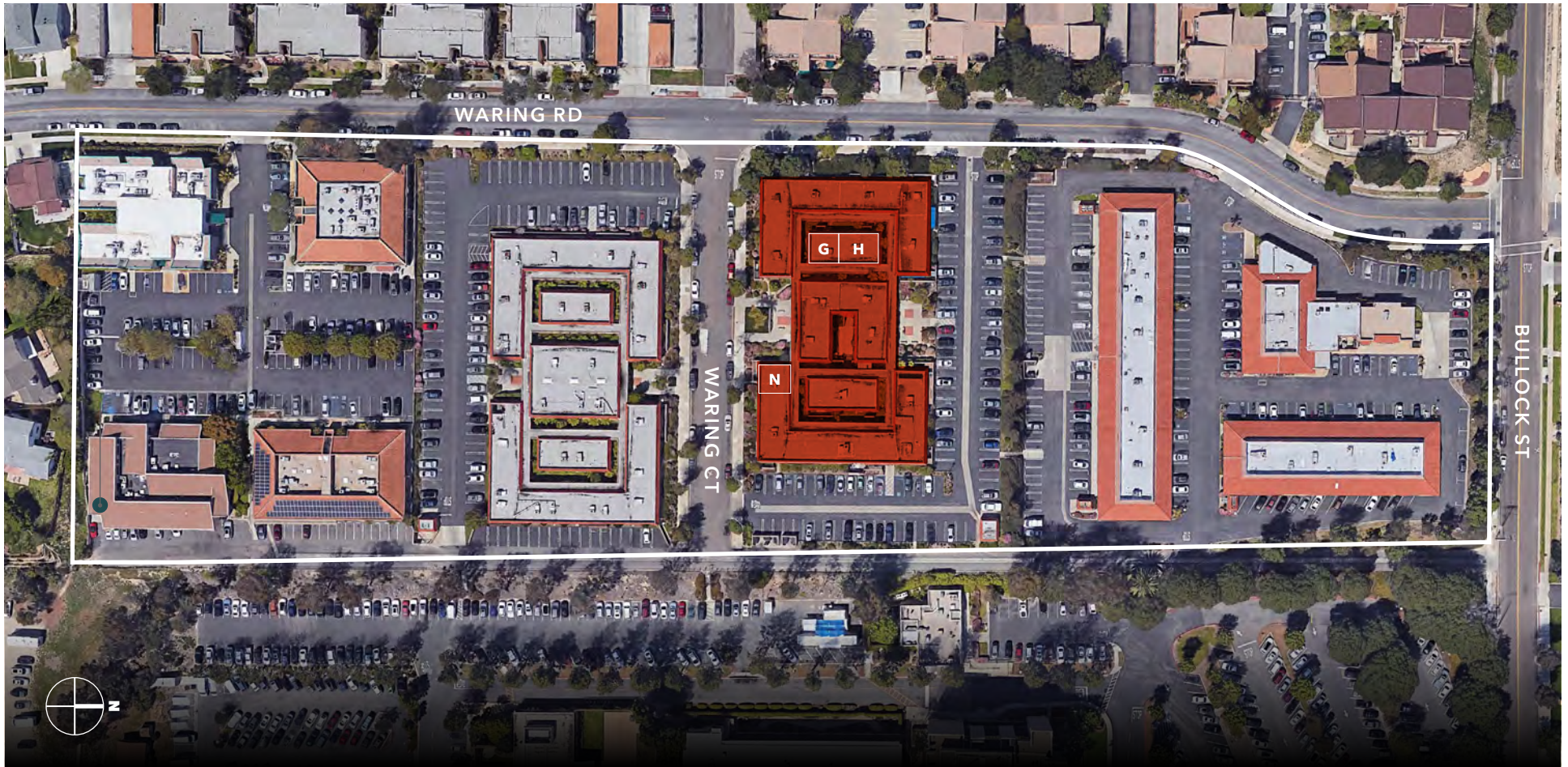

Property Address	Condo No.	Size	Purchase Price	Price Per SF	Notes
3230 Waring Court	G	784 SF	\$250,000	\$320	1 office, 3 exam rooms, 2 restrooms & reception area
3230 Waring Court	H	1,008 SF	\$300,000	\$300	3 offices, 2 restrooms, 2 exam rooms, & waiting room
3230 Waring Court	N	1,050 SF	\$310,000	\$300	3 exam rooms, 1 office, 2 restrooms, reception & a waiting room

*Suites can be combined. Suite G & H are contiguous suites.

FLOOR PLANS

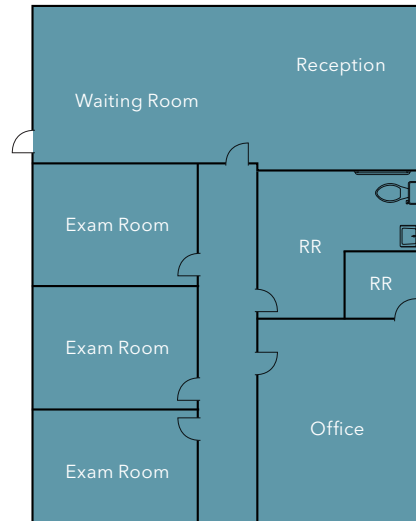
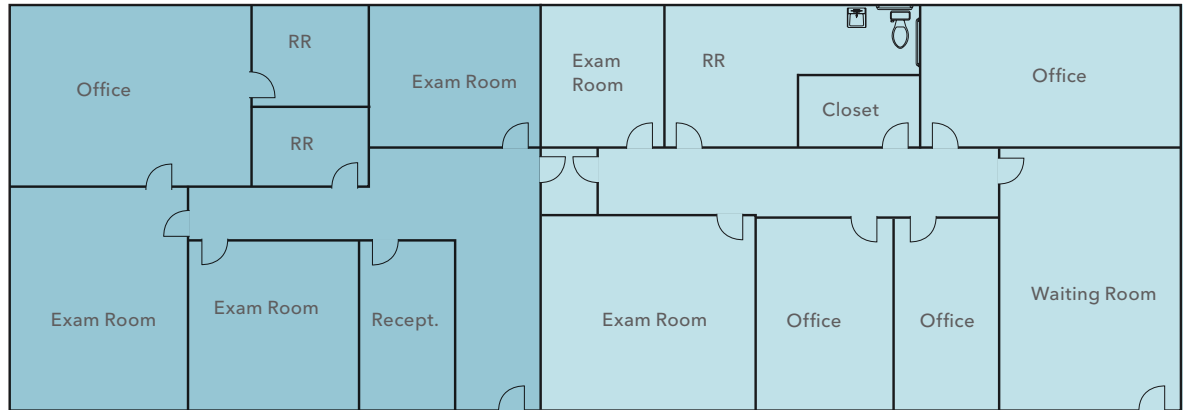
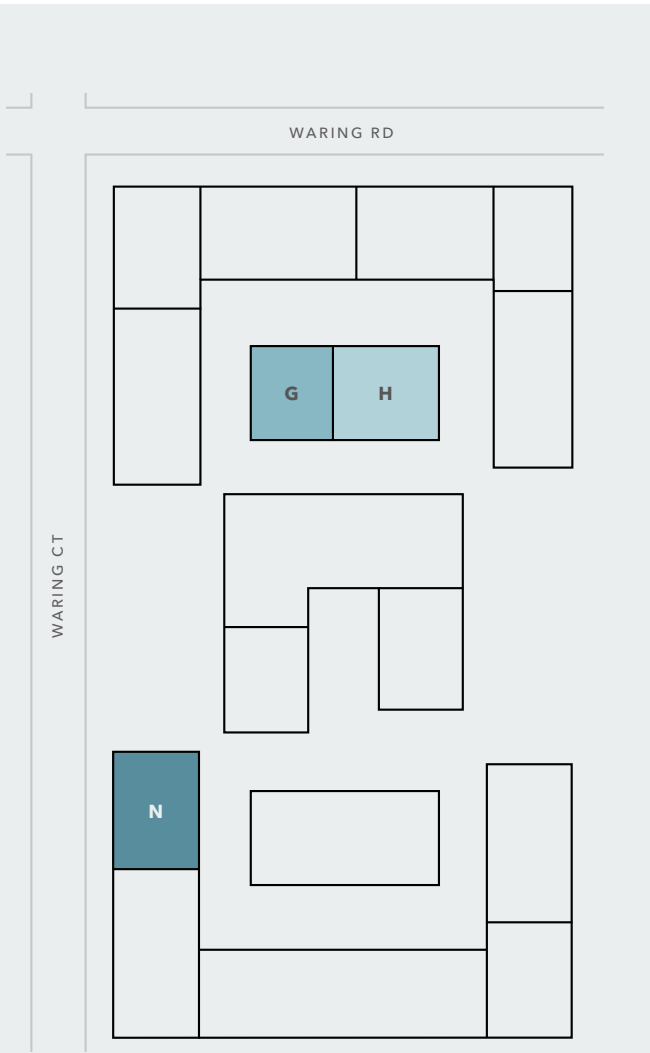

1970/2015

YEAR BUILT/RENOVATED

AMPLE

PARKING

MEDICAL

ZONING

HIGHLY- ACCESSIBLE LOCATION

Walking distance to Tri-City Hospital

Close to McClellan-Palomar Airport & Mira Costa College

Conveniently located near major
confluences Interstate 5, CA-76 & CA-78

Easy for visitors to locate

The COASTER commuter train is in
proximity in Oceanside & Carlsbad Village

Close to several local and national shops,
restaurants and services

13 MIN

MCCLELLAN-
PALOMAR AIRPORT

10 MIN

CARLSBAD VILLAGE/
COASTER STATION



TRI-CITY MEDICAL PARK



Exclusively listed by

JIM BENSON
760.822.7428
jim.benson@kidder.com
LIC N° 01204845

KIDDER.COM

This information supplied herein is from sources we deem reliable. It is provided without any representation, warranty, or guarantee, expressed or implied as to its accuracy. Prospective Buyer or Tenant should conduct an independent investigation and verification of all matters deemed to be material, including, but not limited to, statements of income and expenses. Consult your attorney, accountant, or other professional advisor.

