

# DOMINGUEZ HILLS INDUSTRIAL PARK

350-450 W APRA STREET

Compton, CA

**BRAND NEW, HIGH IMAGE OFFICES**

**FOR LEASE**

**198,977 SF AVAILABLE  
TWO BUILDING CAMPUS**

**NEWMARK**



**PGIM**

APRA STREET

# 350 W APRA STREET

## BUILDING HIGHLIGHTS

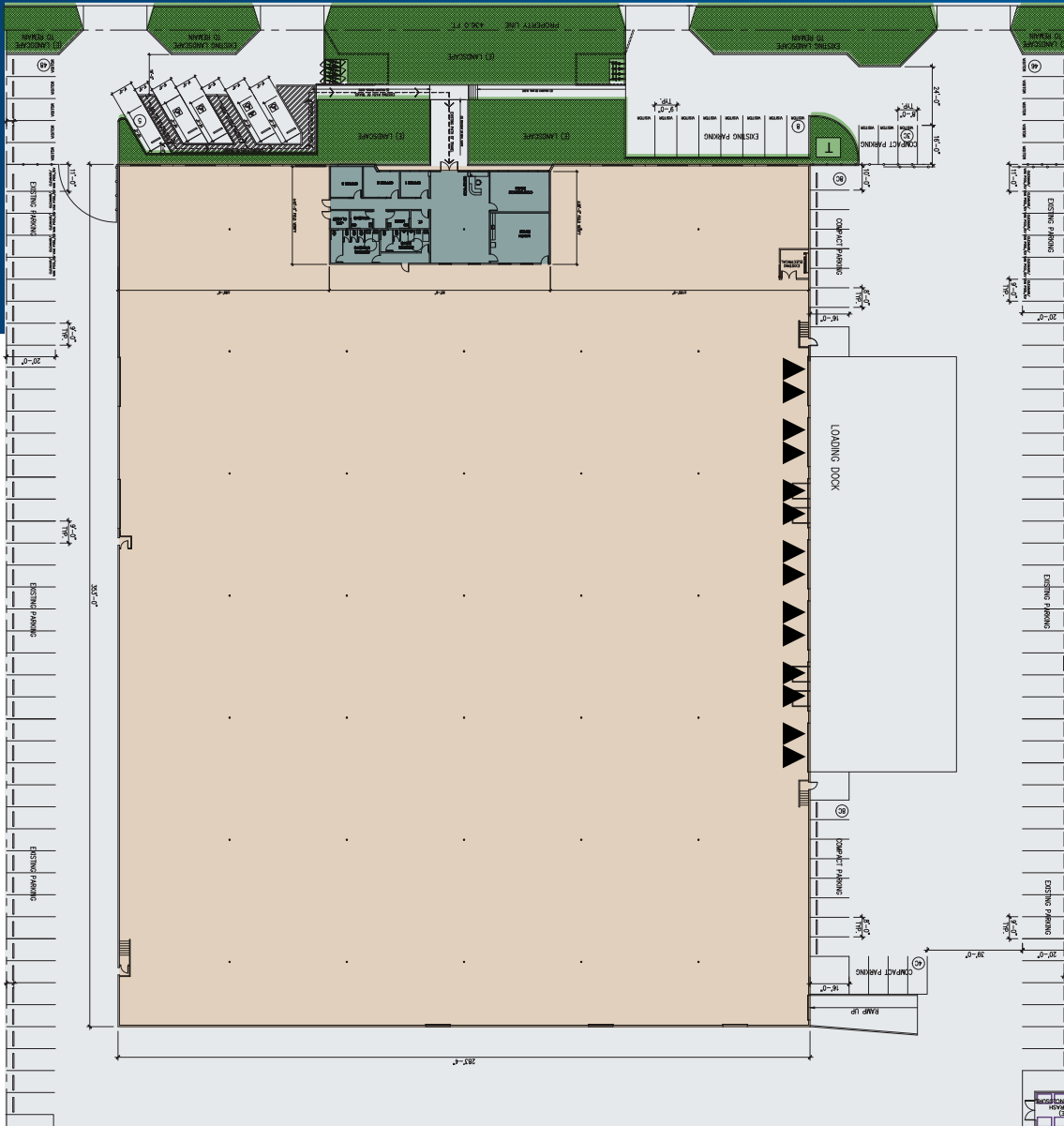

99,803  
SQUARE FEET

.60/4000  
SPRINKLER SYSTEM

14  
DOCK HIGH POSITIONS

3,478 SF  
BRAND NEW OFFICE

3  
GROUND LEVEL DOORS

2  
FENCED YARDS WITH  
DRIVE AROUND ACCESS

24'  
CLEAR HEIGHT

800  
AMPS OF POWER

▲ Dock High Positions

NOT TO SCALE

W APRA STREET

W VICTORIA STREET

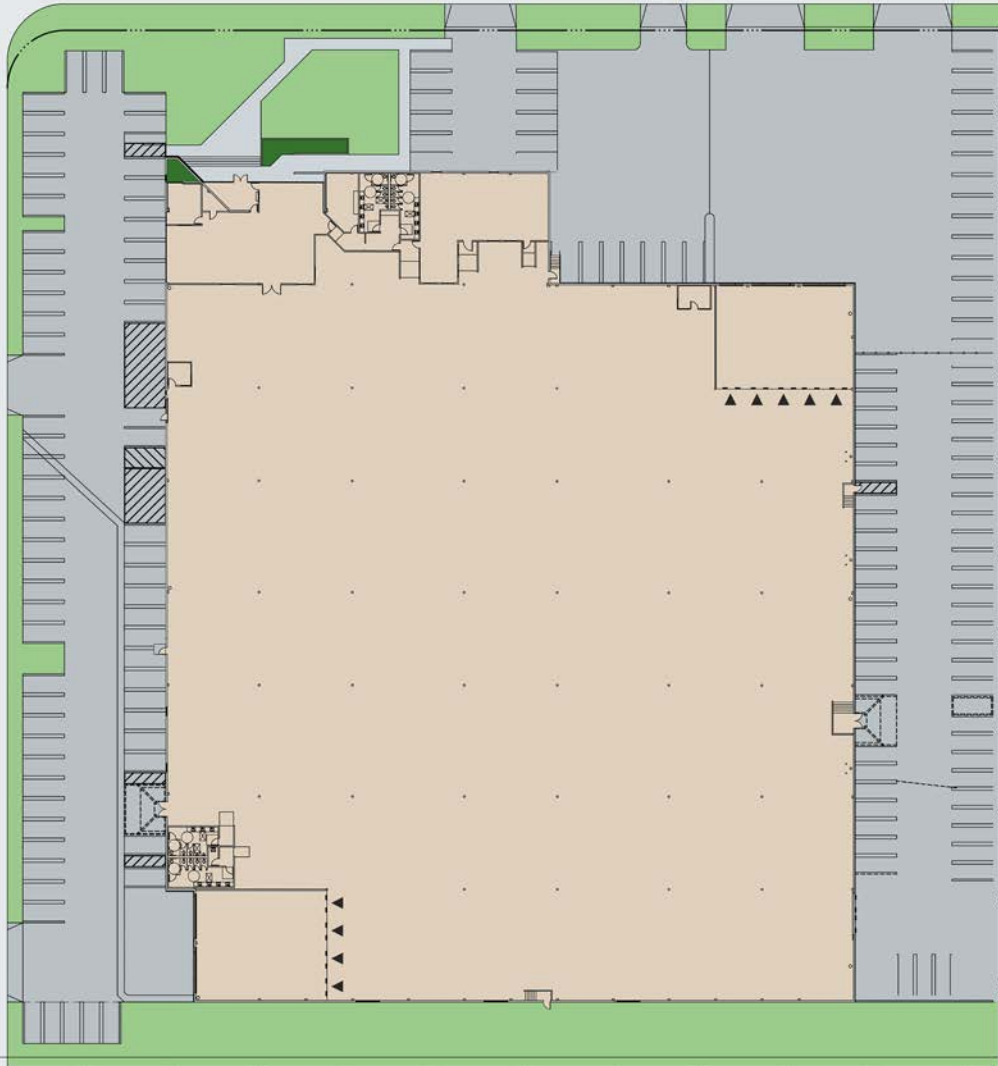

▲ Dock High Positions

# 450 W APRA STREET

## BUILDING HIGHLIGHTS

99,174  
SQUARE FEET

.45/3000  
SPRINKLER SYSTEM

9  
DOCK HIGH POSITIONS

5,100 SF  
OFFICE

1  
GROUND LEVEL DOOR

1,600  
AMPS OF POWER

24'  
CLEAR HEIGHT



# 350-450 W APRA STREET

## BUILDING HIGHLIGHTS

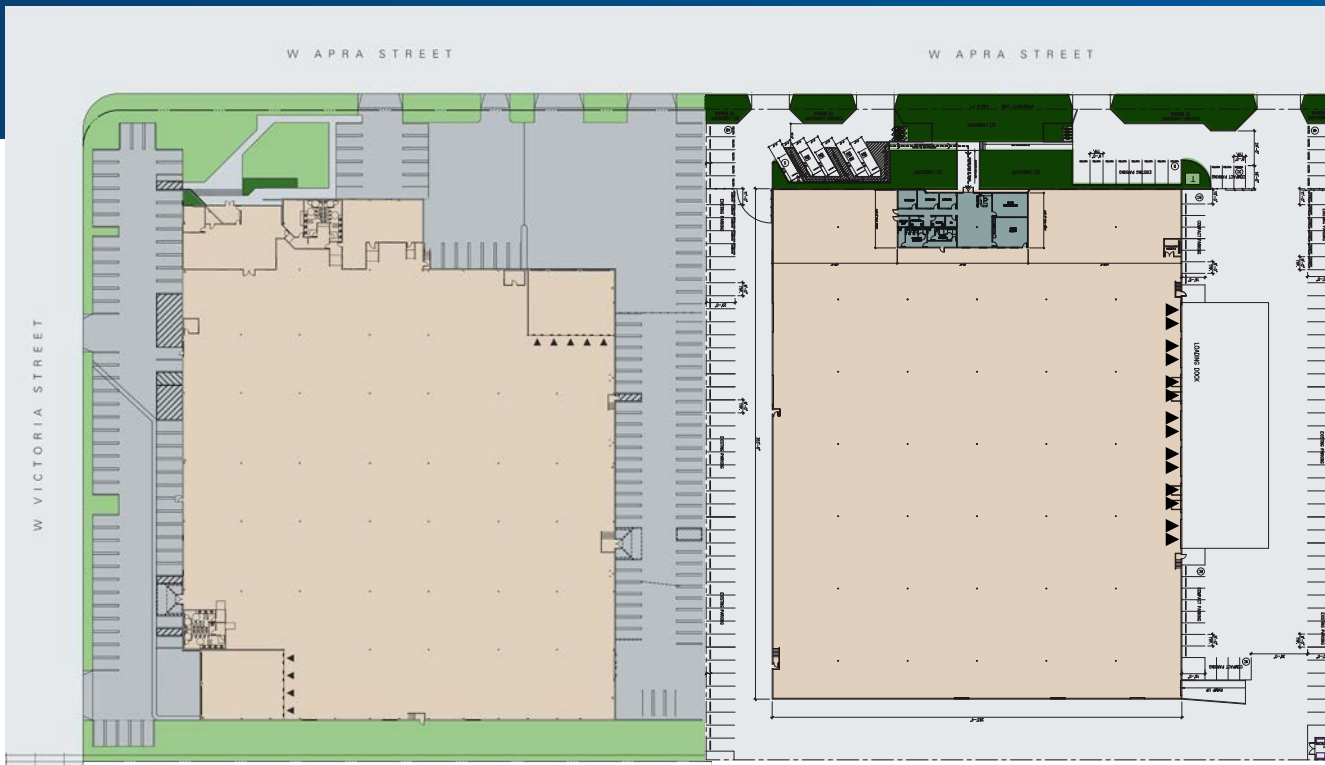

▲ Dock High Positions

NOT TO SCALE

198,977  
SQUARE FEET

.45/3000 &  
.60/4000  
SPRINKLER SYSTEM

23  
DOCK HIGH POSITIONS

8,578 SF  
OFFICE

4  
GROUND LEVEL DOORS

2  
FENCED YARDS WITH  
DRIVE AROUND ACCESS

24'  
CLEAR HEIGHT

2,400  
AMPS OF POWER







# LOCATOR MAP





For more information, please contact:

**DANNY WILLIAMS, SIOR**

*Executive Managing Director*

t 310-491-2061

danny.williams@nmrk.com

CA RE Lic. #01776416

**JOHN MCMILLAN, SIOR**

*Vice Chairman*

t 310-491-2048

john.mcmillan@nmrk.com

CA RE Lic. #01103292

**BARRY HILL, SIOR**

*Executive Managing Director*

t 310-491-2026

barry.hill@nmrk.com

CA RE Lic. #01250531

**350-450 W APRA STREET**

**Compton, CA**

The distributor of this communication is performing acts for which a real estate license is required. The information contained herein has been obtained from sources deemed reliable but has not been verified and no guarantee, warranty or representation, either express or implied, is made with respect to such information. Terms of sale or lease and availability are subject to change or withdrawal without notice.

**NEWMARK**



Corporate License #01355491

**nmrk.com**