

2699 Union Ave
San Jose, CA

Lunardi's
MARKETS

RETAIL SPACE ±1,348
AVAILABLE FOR LEASE

PROPERTY

Highlights



±1,348 SF of retail space
available for lease



Grocery anchored
shopping center



Affluent residential
community



Abundant daytime
population



Prime position at major
intersection of Bascom,
Union, and Curtner Ave



High traffic counts

DEMOGRAPHICS

	1 MILE	3 MILES	5 MILES
Population	24,426	219,639	519,167
Daytime Population	11,727	81,658	221,633
Average Household Income	\$190,294	\$195,573	\$197,094

TRAFFIC COUNTS

Source: 2022 Esri.

Bascom Avenue	20,229 ADT
Curtner Avenue	13,000 ADT
Union Avenue	17,987 ADT

UNIT 30

Available

CURRENTLY DEMISED

±2,777 SF (GoodVets) & ±1,348 SF AVAILABLE



UNIT 30 - DEMISED

Site Plan

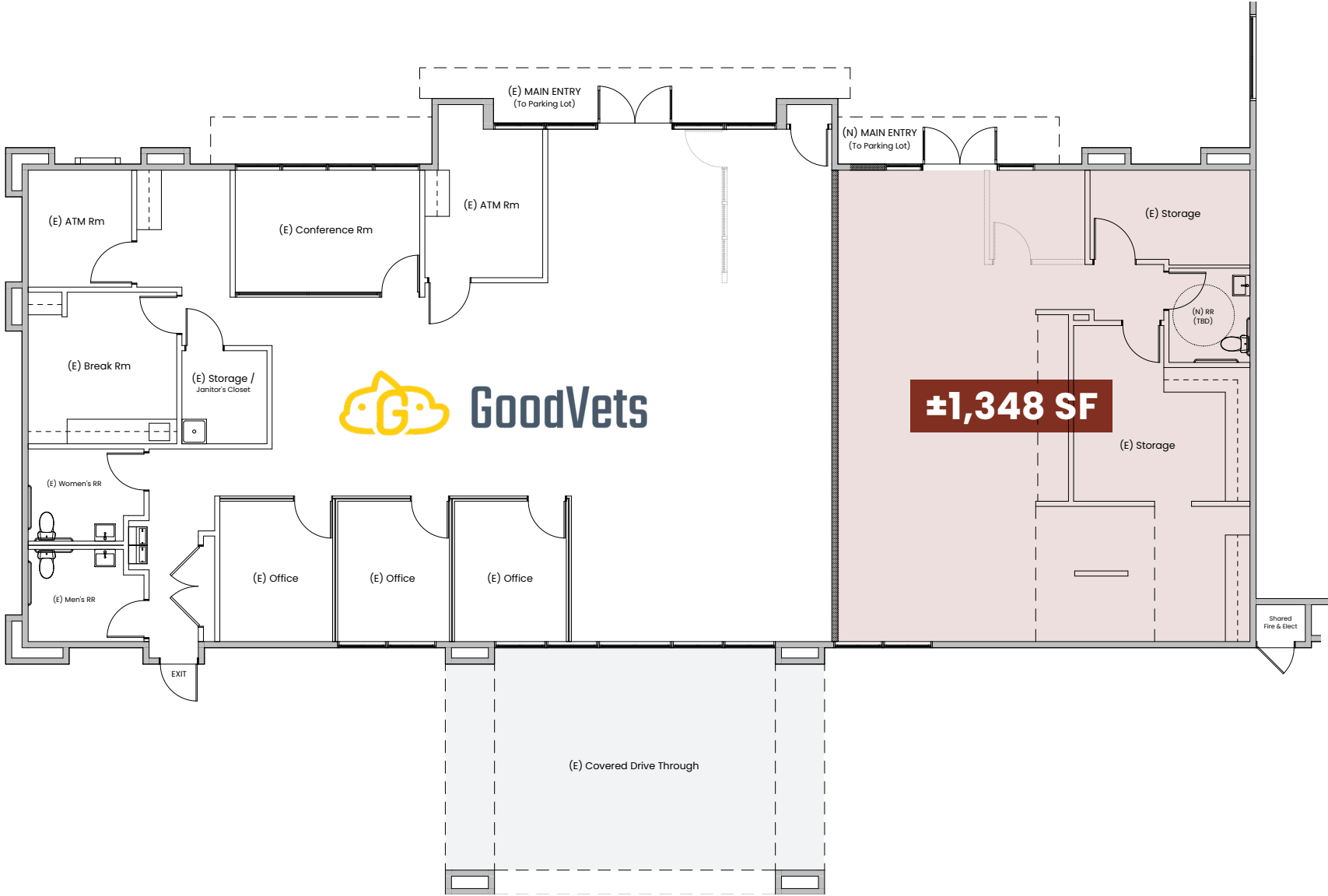



Monument Signage
Availability



PROPERTY Gallery



CLOSE UP

Aerial

In Lease

S Bascom Ave: 20,229 ADT

Union Ave: 17,987 ADT

±1,348 SF
Available

Lunardi's
MARKETS

GoodVets

Curtner Ave: 13,000 ADT

MARKET Aerial

Westgate Center



Walgreens

Hamilton Plaza



Pruneyard Shopping Center



Westgate West



THE HOME DEPOT

2699
Union Ave

Site Shopping Center



Camden Park Mall



SAFeway



DOLLAR TREE



Downing Center of Los Gatos



WHOLE FOODS MARKET

2699 Union Ave

San Jose, CA



JAMES CHUNG

jchung@theeoniccompany.com

(408) 400-7017

CA RE License #01408190

MIKE CONROY

mconroy@theeoniccompany.com

(408) 400-7061

CA RE License #02046912



the eonic company®