



# 4,155 SF AVAILABLE NOW

2134 James Jackson Parkway NW  
Suite C | Atlanta, GA 30318

OWNED & MANAGED BY:



## FOR LEASE



### PROPERTY INFORMATION

- Total Size:** 4,155 SF
- Office:** 677 SF
- Warehouse:** 3,478 SF
- Loading:** One (1) Oversize Dock High Door
- Clear Height:** 20'
- Available:** Immediately
- Location:**
  - +/- 1.5 miles from I-285
  - +/- 4 miles from I-75
  - +/- 4.5 miles from I-20
  - +/- 17 miles from Atlanta Airport

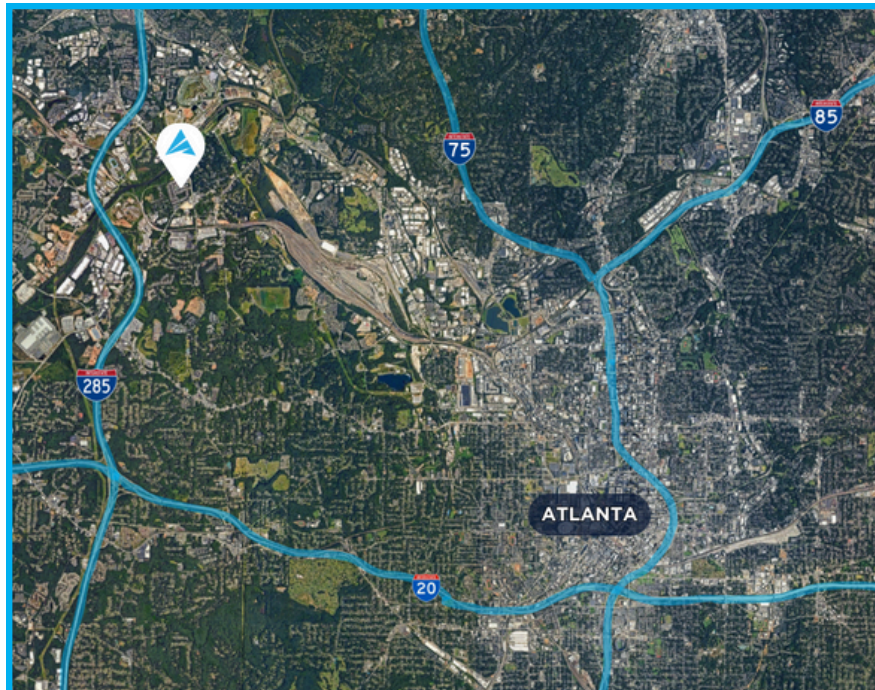

**APEX INDUSTRIAL**  
REAL ESTATE ADVISORS

3500 Lenox Road, Suite 1275 | Atlanta, GA 30326 | [apexindustrialre.com](http://apexindustrialre.com)

For more information, please contact:

#### TREY WEGHORST

Office: (770) 264-9420  
Cell: (404) 276-9314  
[tweghorst@apexindustrialre.com](mailto:tweghorst@apexindustrialre.com)

#### ANDY HEAD

Office: (404) 595-1466  
Cell: (404) 713-4601  
[ahead@apexindustrialre.com](mailto:ahead@apexindustrialre.com)

Although the information contained therein was provided from sources believed to be reliable, Apex Industrial makes no representation, expressed or implied, as to its accuracy and said information is subject to errors, omissions or changes.



# 4,155 SF AVAILABLE NOW

2134 James Jackson Parkway NW  
Suite C | Atlanta, GA 30318

OWNED & MANAGED BY:



## FLOOR PLAN

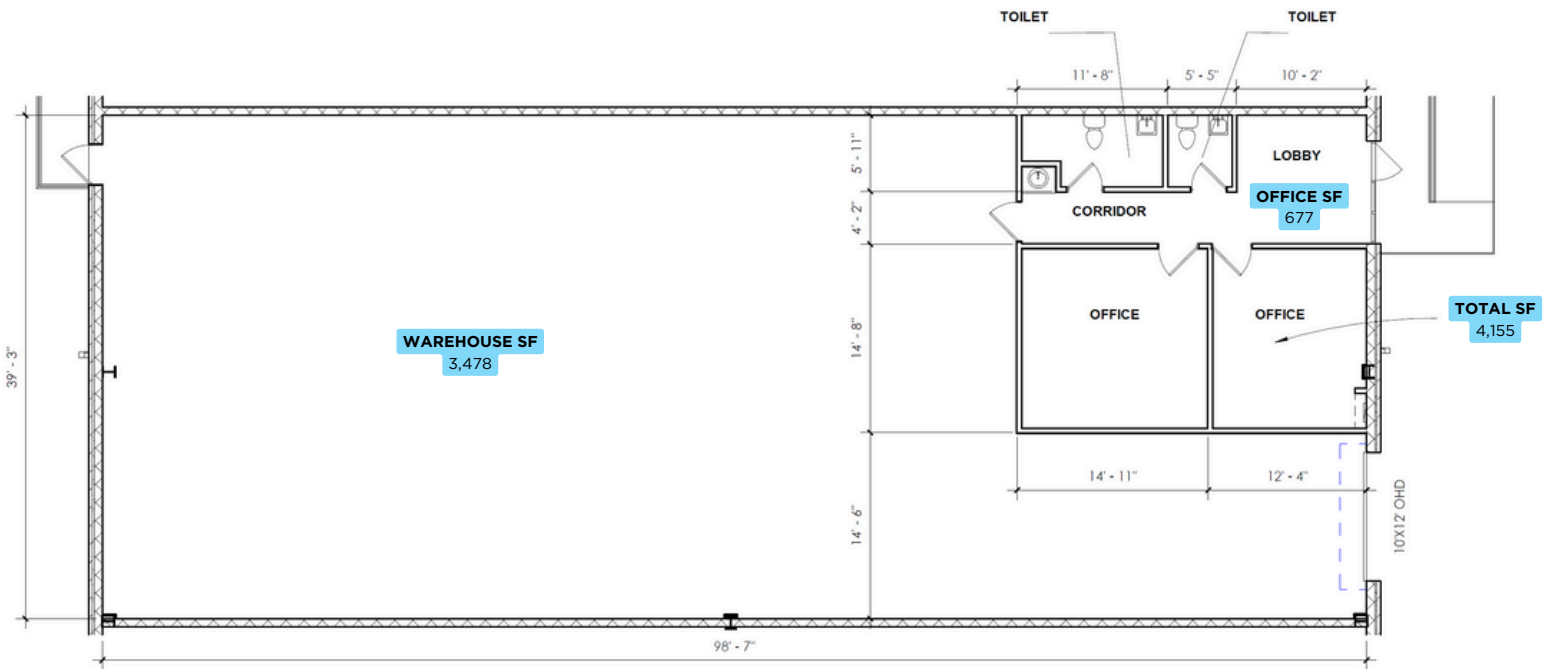

**APEX INDUSTRIAL**  
REAL ESTATE ADVISORS

3500 Lenox Road, Suite 1275 | Atlanta, GA 30326 | [apexindustrialre.com](http://apexindustrialre.com)

For more information, please contact:

### TREY WEGHORST

Office: (770) 264-9420  
Cell: (404) 276-9314  
[tweghorst@apexindustrialre.com](mailto:tweghorst@apexindustrialre.com)

### ANDY HEAD

Office: (404) 595-1466  
Cell: (404) 713-4601  
[ahead@apexindustrialre.com](mailto:ahead@apexindustrialre.com)

Although the information contained therein was provided from sources believed to be reliable, Apex Industrial makes no representation, expressed or implied, as to its accuracy and said information is subject to errors, omissions or changes.