

# NAI Advent

ADVENT COMMERCIAL REAL ESTATE CORP.

## Turnkey Restaurant

High-Visibility | Quality Finishes

460 Erin Woods Dr SE, Calgary, AB T2B 1N3

### PROPERTY HIGHLIGHTS

- ±4,164 SF single-storey freestanding restaurant building
- Situated on a ±0.46 acre fully paved and serviced site
- Recently renovated with high-end interior finishes and fixtures
- Flexible C-N2 zoning allowing for various uses such as Child Care Services (daycare) or Place of Worship (church)
- Brand new roof installed in 2025
- Ideal event space with an occupancy load of 150 people
- Walk in freezer and cooler included
- Kitchen equipment and restaurant fixtures all negotiable
- Located within the established residential community of Erin Woods in southeast Calgary
- Excellent visibility at the high-traffic corner of Erin Woods Drive and 52nd Street with strong signage opportunities
- Convenient access to major transportation routes including Peigan Trail, Deerfoot Trail, Stoney Trail, and 52nd Street SE
- Ample on-site customer parking and rear lane access

FOR SALE

**±4,200 SF on  
±0.46 AC**

**FREESTANDING  
RESTAURANT**

This brochure is intended for information purposes only and should not be relied upon for accurate factual information by the recipients hereof. The information contained herein is based on information which NAI Advent deems reliable, however, NAI Advent assumes no responsibility for the degree of accuracy of such information, nor does NAI Advent represent or warrant the information contained herein. Recipients hereof should conduct their own investigations to determine the accuracy of information contained herein. The information contained herein is subject to change without notice.

📍 3633 8 St SE, Calgary, AB T2G 3A5

📞 403 984 9800

🌐 [naiadvent.com](http://naiadvent.com)

## ABOUT THE PROPERTY

SHORT LEGAL	0812742;3
YEAR BUILT	1990
SUBDIVISION	Erin Woods
SITE SIZE	±20,038 SF (±0.46 Acres)
BUILDING SIZE	±4,200 SF
ZONING	C-N2 (Commercial - Neighbourhood 2)
TAXES	\$33,616.04 (2025)
PARKING	Ample
ASKING PRICE	\$2,700,000



For more info,  
please contact:



**Brody Butchart**  
+1 403 389 7857  
[bbutchart@naiadvent.com](mailto:bbutchart@naiadvent.com)



**Jamie Coulter, SIOR**  
+1 403 835 1535  
[jcoulter@naiadvent.com](mailto:jcoulter@naiadvent.com)



**Kaile Landry**  
+1 403 669 3050  
[klandry@naiadvent.com](mailto:klandry@naiadvent.com)



**Jennifer Myles**  
+1 403 975 2616  
[jmyles@naiadvent.com](mailto:jmyles@naiadvent.com)

**FOR SALE**

**Turnkey Restaurant**

460 Erin Woods Dr SE, Calgary, AB T2B 1N3 | Erin Woods

**CONCEPT PLAN**

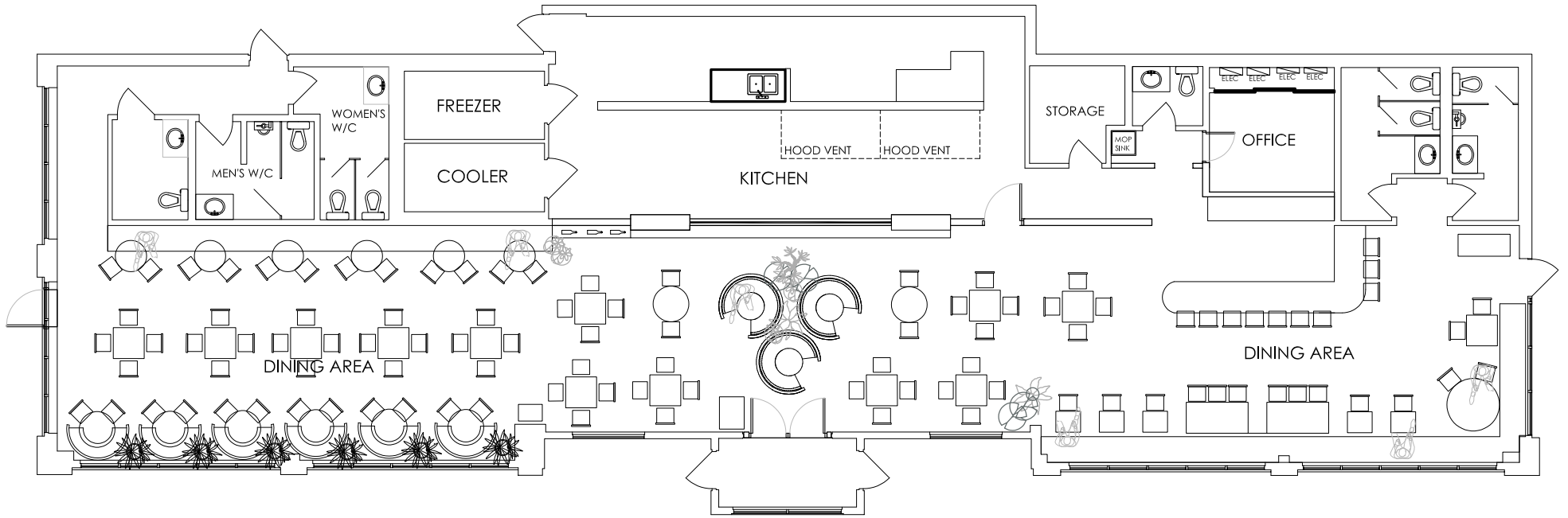

For more info,  
please contact:



**Brody Butchart**

+1 403 389 7857

[bbutchart@naiadvent.com](mailto:bbutchart@naiadvent.com)



**Jamie Coulter, SIOR**

+1 403 835 1535

[jcoulter@naiadvent.com](mailto:jcoulter@naiadvent.com)



**Kaile Landry**

+1 403 669 3050

[klandry@naiadvent.com](mailto:klandry@naiadvent.com)



**Jennifer Myles**

+1 403 975 2616

[jmyles@naiadvent.com](mailto:jmyles@naiadvent.com)

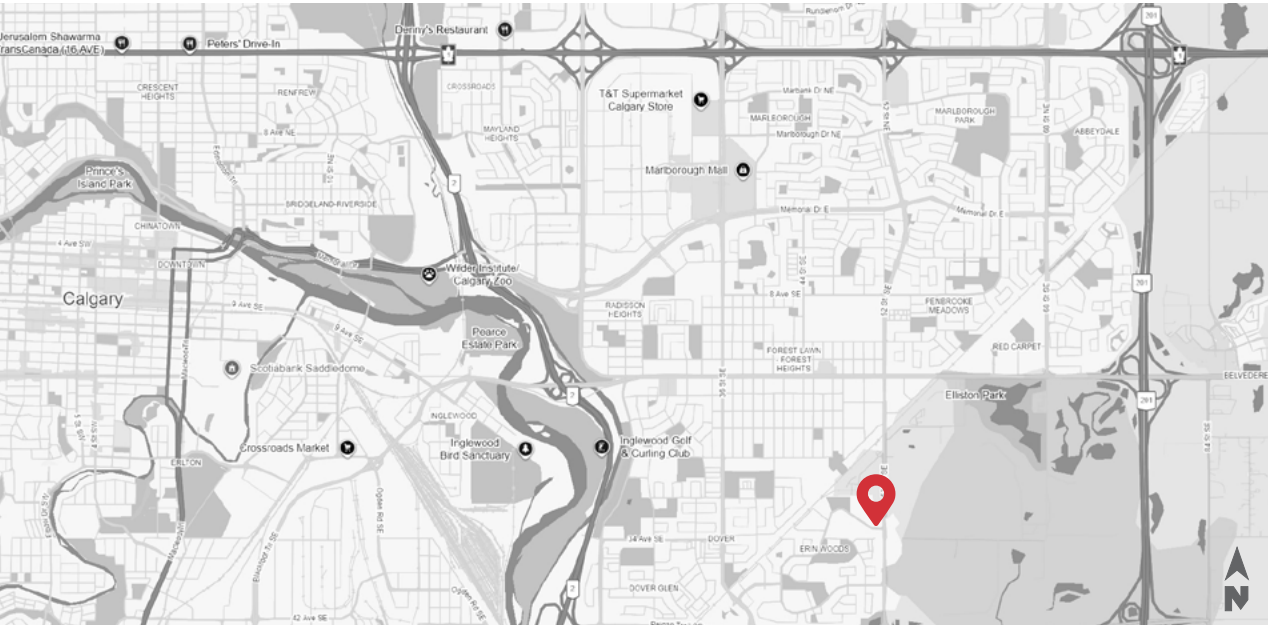

For more info,  
please contact:



**Brody Butchart**  
+1 403 389 7857  
[bbutchart@naiadvent.com](mailto:bbutchart@naiadvent.com)



**Jamie Coulter, SIOR**  
+1 403 835 1535  
[jcoulter@naiadvent.com](mailto:jcoulter@naiadvent.com)



**Kaile Landry**  
+1 403 669 3050  
[klandry@naiadvent.com](mailto:klandry@naiadvent.com)



**Jennifer Myles**  
+1 403 975 2616  
[jmyles@naiadvent.com](mailto:jmyles@naiadvent.com)