

2803 E BURNSIDE ST

Portland, OR 97214

FOR LEASE



RETAIL SPACE FOR LEASE

DETAILS

- Space size: $\pm 1,609$ SF
- Lease rate: Call brokers for rate
- Zoning: CM2

FEATURES

- Light food infrastructure (grease trap, floor drains, mop sink, 2 restrooms)
- Excellent walking score of 97
- High visibility on 28th and E Burnside Street
- Minutes from downtown Portland and major transportation arterials
- Surrounding tenants include: Whole Foods, Laurelhurst Theatre, Paadee, and Laurelhurst Market

DEMOGRAPHICS

	1 MILE	3 MILES
Population	34,216	248,108
Households	18,291	126,632
Median Age	37.3	38.3
Median Household Income	\$96,603	\$98,558
Daytime Employees	17,593	215,806

FLOOR PLAN

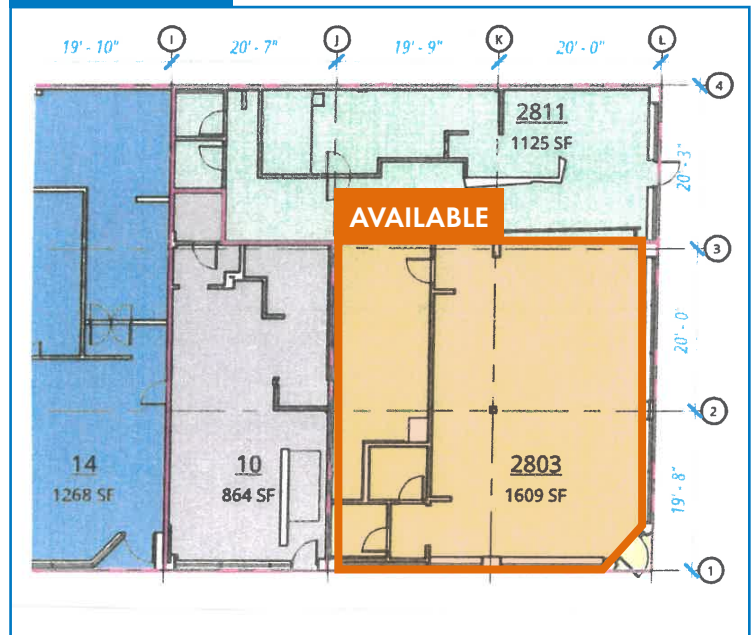

For more information or a property tour, please contact:

GREG NESTING

503.225.8440

GregN@norris-stevens.com

LUIS MARTIN DEL CAMPO

503.416.8422

LuisM@norris-stevens.com

Norris & Stevens

INVESTMENT REAL ESTATE SERVICES



Information contained herein has been obtained from others and considered to be reliable; however, a prospective purchaser or lessee is expected to verify all information to their own satisfaction.

900 SW 5th Avenue • 17th Floor • Portland, OR 97204
503.223.3171 • norris-stevens.com

2803 E BURNSIDE ST

Portland, OR 97214

FOR LEASE

PROPERTY PHOTOS

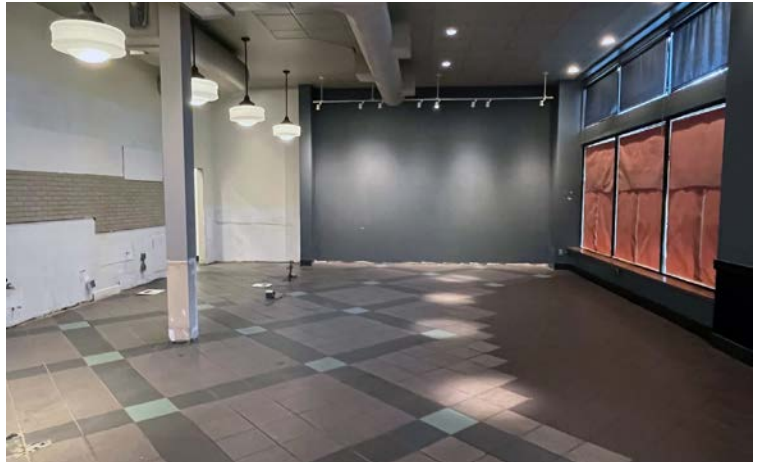

For more information or a property tour, please contact:

GREG NESTING

503.225.8440

GregN@norris-stevens.com

LUIS MARTIN DEL CAMPO

503.416.8422

LuisM@norris-stevens.com



Information contained herein has been obtained from others and considered to be reliable; however, a prospective purchaser or lessee is expected to verify all information to their own satisfaction.

Norris & Stevens

INVESTMENT REAL ESTATE SERVICES

900 SW 5th Avenue • 17th Floor • Portland, OR 97204

503.223.3171 • norris-stevens.com

2803 E BURNSIDE ST

Portland, OR 97214

FOR LEASE

MAP

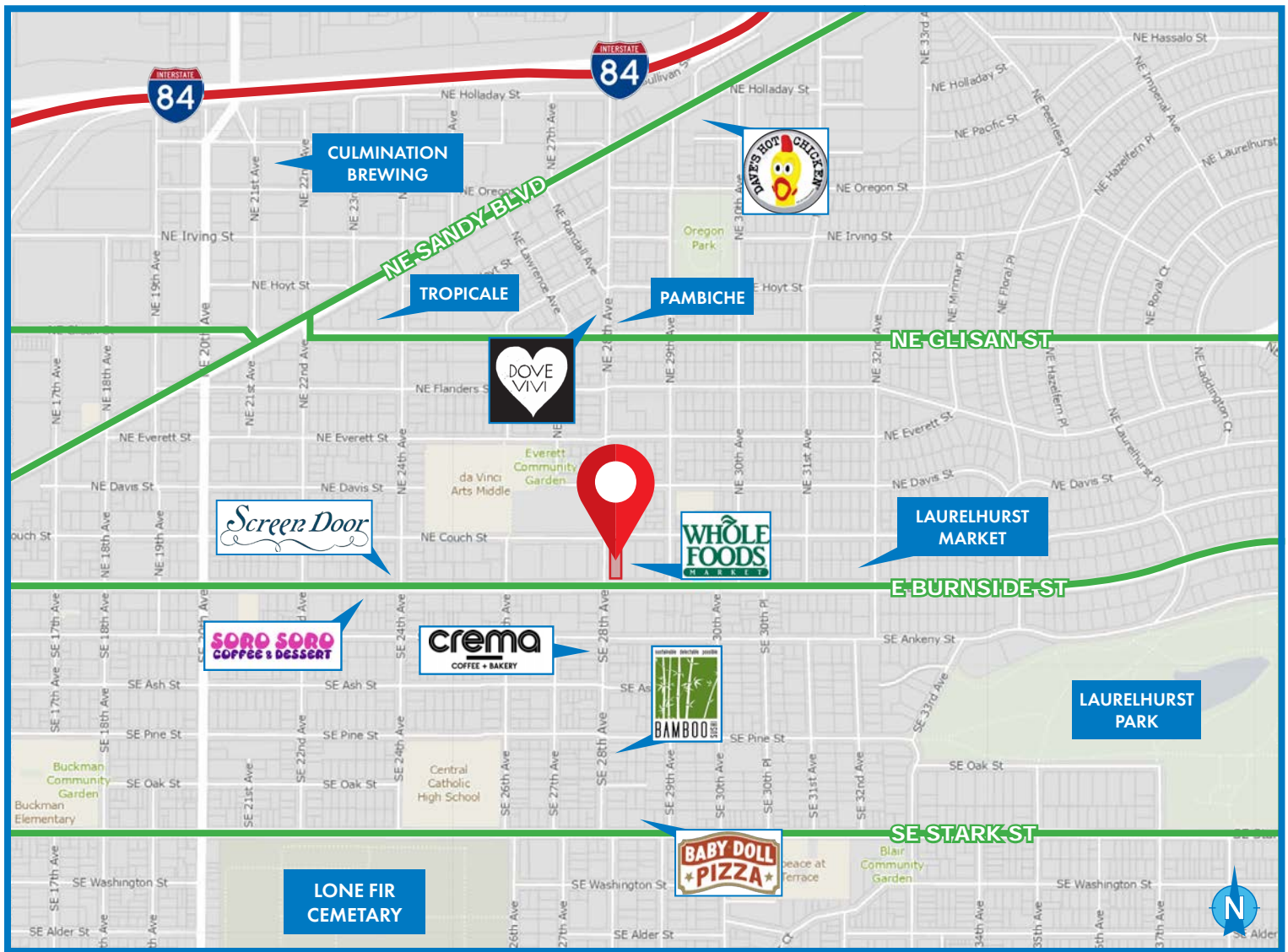

WALK SCORE

97

BIKE SCORE

94

For more information or a property tour, please contact:

GREG NESTING

503.225.8440

GregN@norris-stevens.com

LUIS MARTIN DEL CAMPO

503.416.8422

LuisM@norris-stevens.com

Norris & Stevens

INVESTMENT REAL ESTATE SERVICES



Information contained herein has been obtained from others and considered to be reliable; however, a prospective purchaser or lessee is expected to verify all information to their own satisfaction.

900 SW 5th Avenue • 17th Floor • Portland, OR 97204

503.223.3171 • norris-stevens.com