

CAP RATE 7%!

REDUCED PRICE!



PILOT

PROPERTY GROUP

HEAVY INDUSTRIAL ZONING 24650 SHERWOOD AVE, CENTERLINE, MI 48015

PROPERTY OVERVIEW:

- Great investment opportunity
- Truck parking available
- Well maintained building
- Great mix of tenants
- Ample Parking

Property Type: Industrial Investment
Cross Streets: On Sherwood just south of 10 Mile Road
Total Square Footage: 14,776
Year Built: 1998
Parcel ID: 01-13-28-202-006
Total Acreage: 1.6 AC
Zoning: M-1
Sale Price: ~~\$2,099,990.00~~ \$1,950,000.00

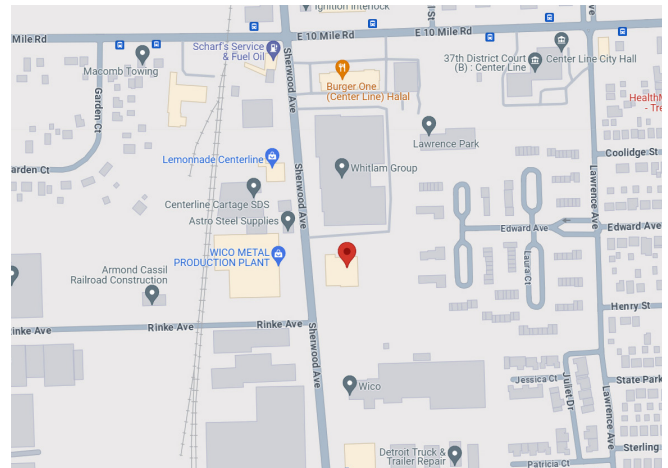

AGENT CONTACT INFO

JUSTIN FRANCEK O: 586.254.0900 x124 • C: 586.227.9515 • justin@pilotpg.com

Matching the right people to the right place.

44400 Van Dyke, Suite 101, Sterling Heights, MI 48314 • 1530 Pine Grove, Suite 4, Port Huron, MI 48060
586.254.0900 • www.pilotpg.com

FLOOR PLAN

Image/Sketch for Parcel: 01-13-28-202-006

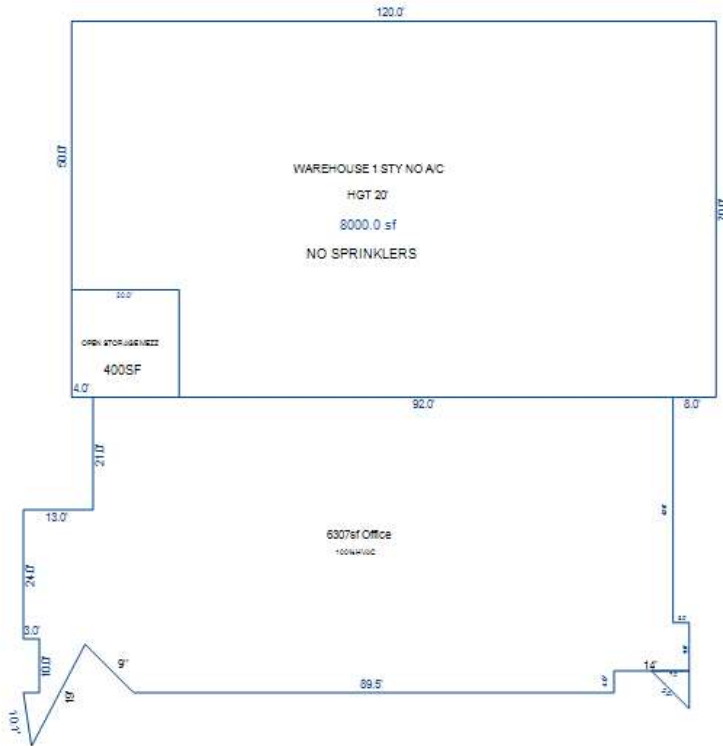

MSR'D 2022-08-29'

Matching the right people to the right place.

ADDITIONAL PHOTOS



Matching the right people to the right place.

ADDITIONAL PHOTOS



Matching the right people to the right place.