

**±1.6 Acres / ±16,186 SF Industrial Building**  
**AVAILABLE Regional Location**

**Property Highlights**

- ±16,186 SF Industrial Building
- 1.6 Acre land parcel with redevelopment potential
- Clear and full highway access to Interstate 95
- ±667' frontage and great sight lines on Jefferson Blvd
- Located near many amenities
- Many possible uses
- Zone LI (Light Industrial)

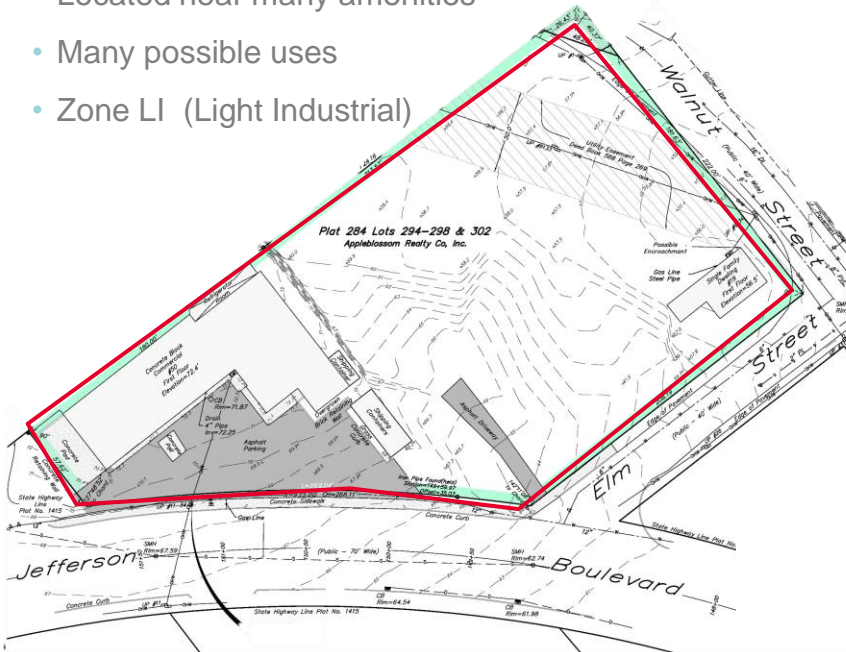

**POTENTIAL REDEVELOPMENT 1.6 ACRES**



For more information, please contact:

**Bill Greene**  
 Partner  
 401.273.7429  
 bgreene@hayessherry.com

146 Westminster Street, 2<sup>nd</sup> floor  
 Providence, RI 02903  
 phone: 401 273 1980  
 www.hayessherry.com



