

650 SF RETAIL SPACE

CONVENIENTLY LOCATED & HIGH VISIBILITY

5117 SE POWELL BLVD, PORTLAND OR 97206

FOR LEASE



AT INTERSECTION SE 52ND AVE / SE POWELL BLVD

Kai Fuhrmann

503.740.3008

Kfuhrmann@windermere.com

(Broker licensed in Oregon)



Portland Office
Oregon City Office

2105 NE Cesar E Chavez Blvd. Ste. 220, Portland OR 97212
1209 7th Street, Oregon City, OR 97045

The information contained in this document has been obtained from sources deemed reliable. We do not, however, guarantee its accuracy. All Information should be verified prior to purchase.

LEASE ASKING RATE

- \$24.00/ SF / Year (Modified Gross, tenant pays for own electrical, telephone & data)

PROPERTY ADDRESS

- 5117 SE Powell Blvd, Portland OR 97206

SPACE SIZE

- 650 SF (SUITE 4)

ZONING

- Commercial (CM2)



HIGHLY VISIBLE — CENTRALLY LOCATED

Kai Fuhrmann

503.740.3008

Kfuhrmann@windermere.com

(Broker licensed in Oregon)



Portland Office
Oregon City Office

2105 NE Cesar E Chavez Blvd. Ste. 220, Portland OR 97212
1209 7th Street, Oregon City, OR 97045

The information contained in this document has been obtained from sources deemed reliable. We do not, however, guarantee its accuracy. All Information should be verified prior to purchase.



Portland Office
Oregon City Office

2105 NE Cesar E Chavez Blvd. Ste. 220, Portland OR 97212
1209 7th Street, Oregon City, OR 97045

The information contained in this document has been obtained from sources deemed reliable . We do not, however, guarantee its accuracy. All Information should be verified prior to purchase.

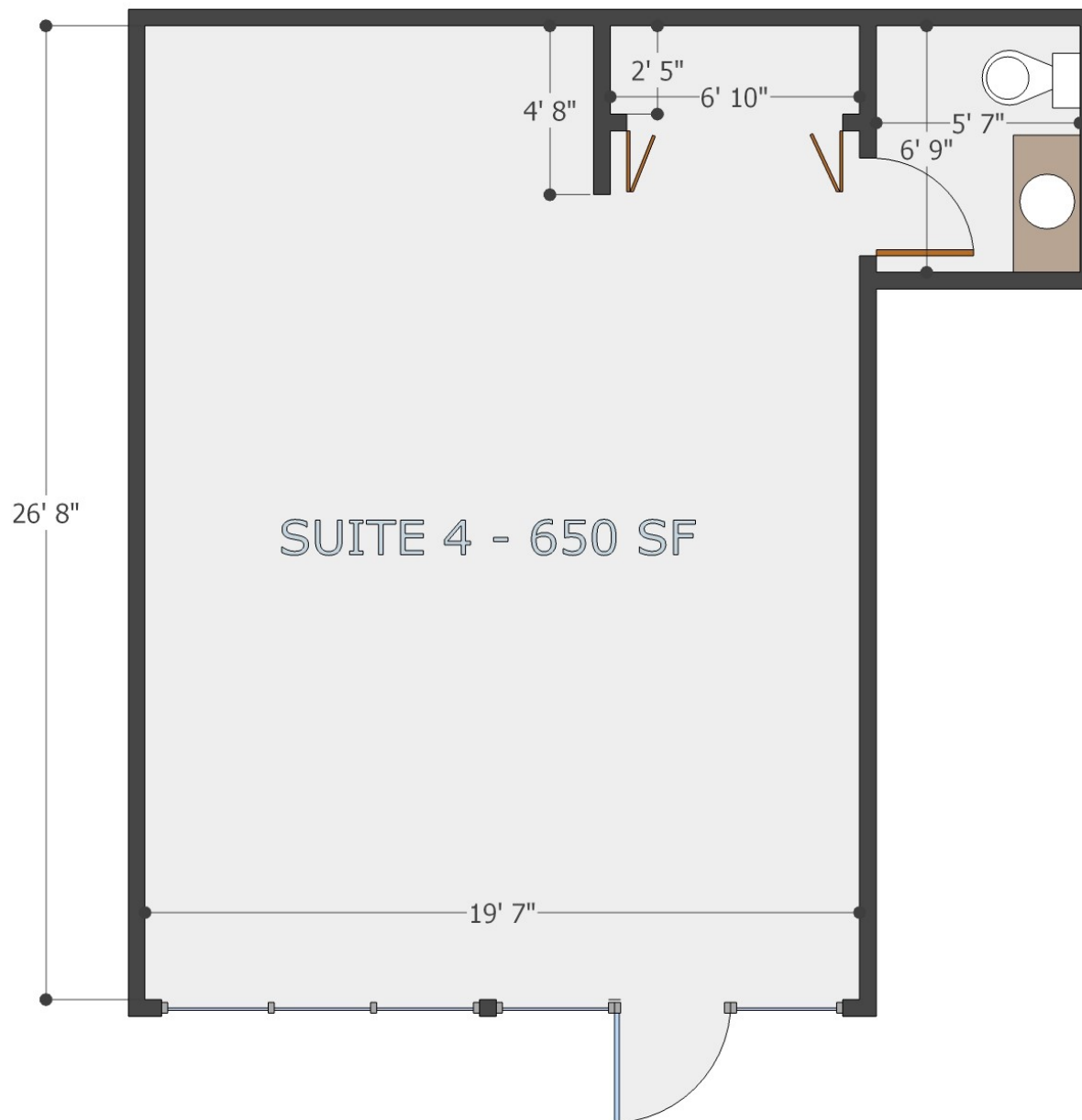

Portland Office
Oregon City Office

2105 NE Cesar E Chavez Blvd. Ste. 220, Portland OR 97212
1209 7th Street, Oregon City, OR 97045

The information contained in this document has been obtained from sources deemed reliable . We do not, however, guarantee its accuracy. All Information should be verified prior to purchase.

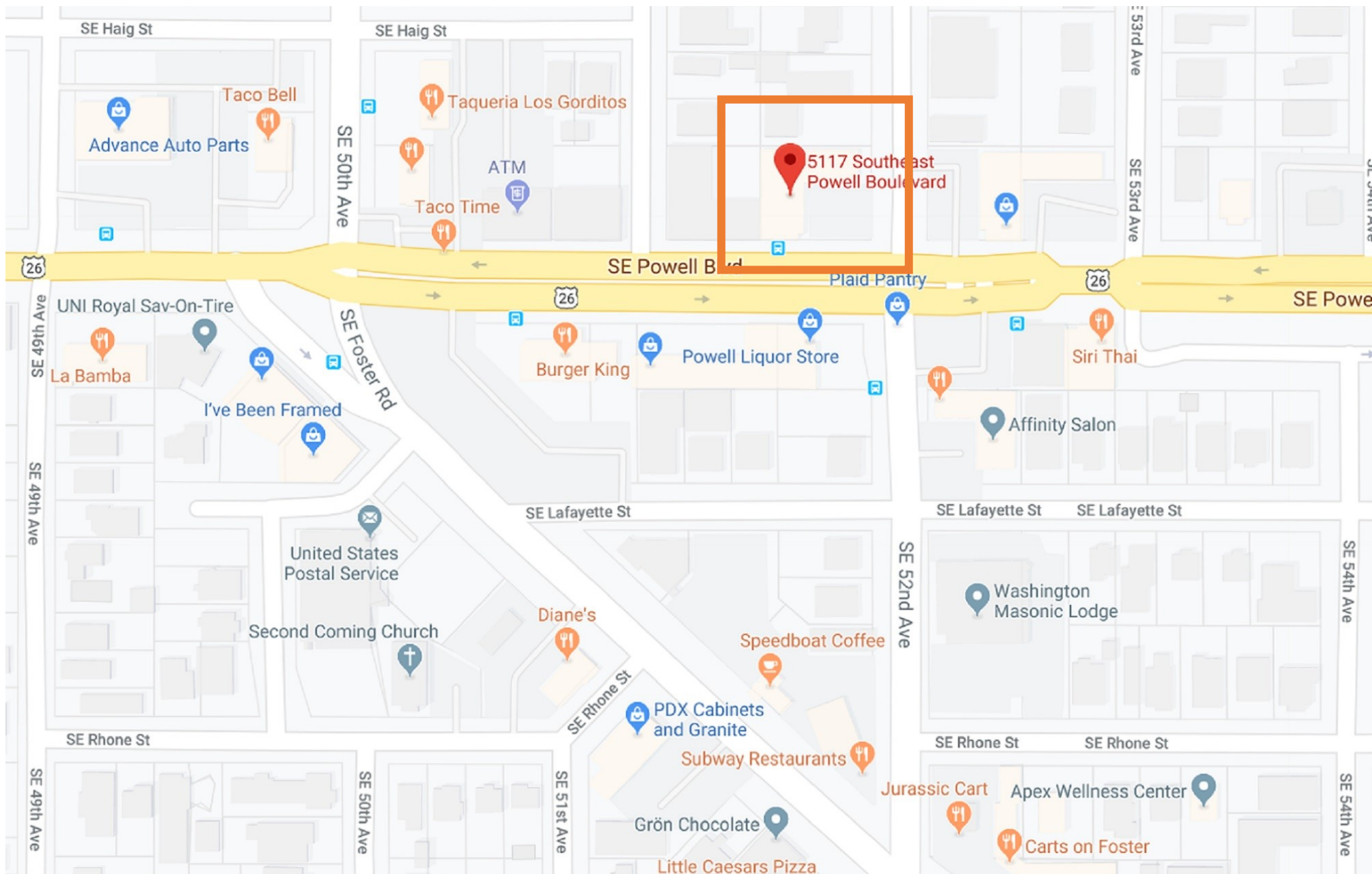

Portland Office
Oregon City Office

2105 NE Cesar E Chavez Blvd. Ste. 220, Portland OR 97212
1209 7th Street, Oregon City, OR 97045

The information contained in this document has been obtained from sources deemed reliable . We do not, however, guarantee its accuracy. All Information should be verified prior to purchase.