

TWO SUITES AVAILABLE



RETAIL SPACE AVAILABLE FOR LEASE

PARADISE SQUARE

3831-3923 E Thunderbird Rd | Phoenix, AZ

Space Available:

- Suite A121 1,290 SqFt
- Suite B107 2,200 SqFt

Space offered at: **\$19/sf NNN**

For more information please contact:

Ryan Banks

Property Manager

602.252.9300 | ryanb@casehuff.com

Professionally Managed & Leased by



www.casehuff.com



- Located in a dense residential area
- Thunderbird Rd (Traffic): ±29,842 VPD
- 40th Street (Traffic): ±18,421 VPD
- 1 mile Northwest of PV Mall
- 6 blocks East of SR-51

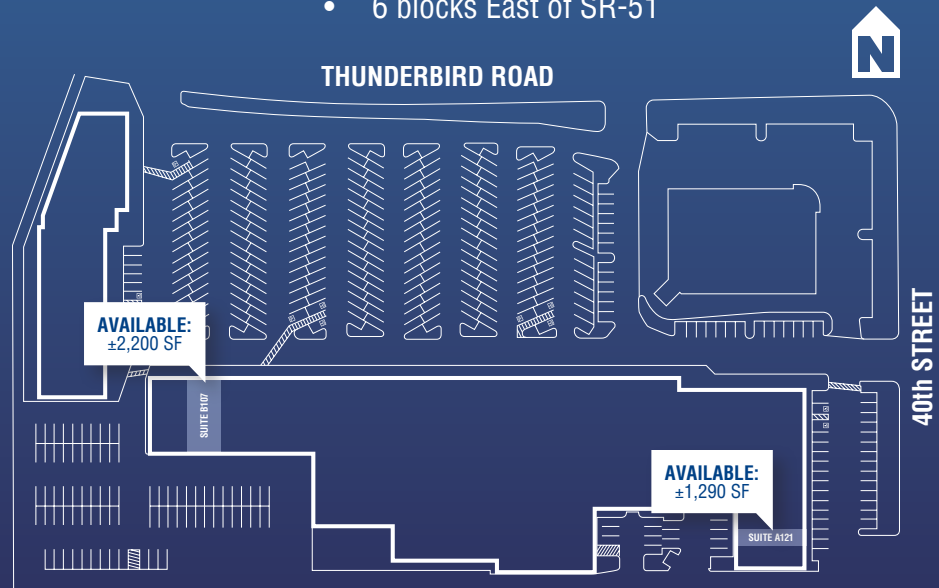

PARADISE SQUARE

FLOORPLANS

Space offered at:

\$19/sf NNN

SUITE B107 2,200 SF

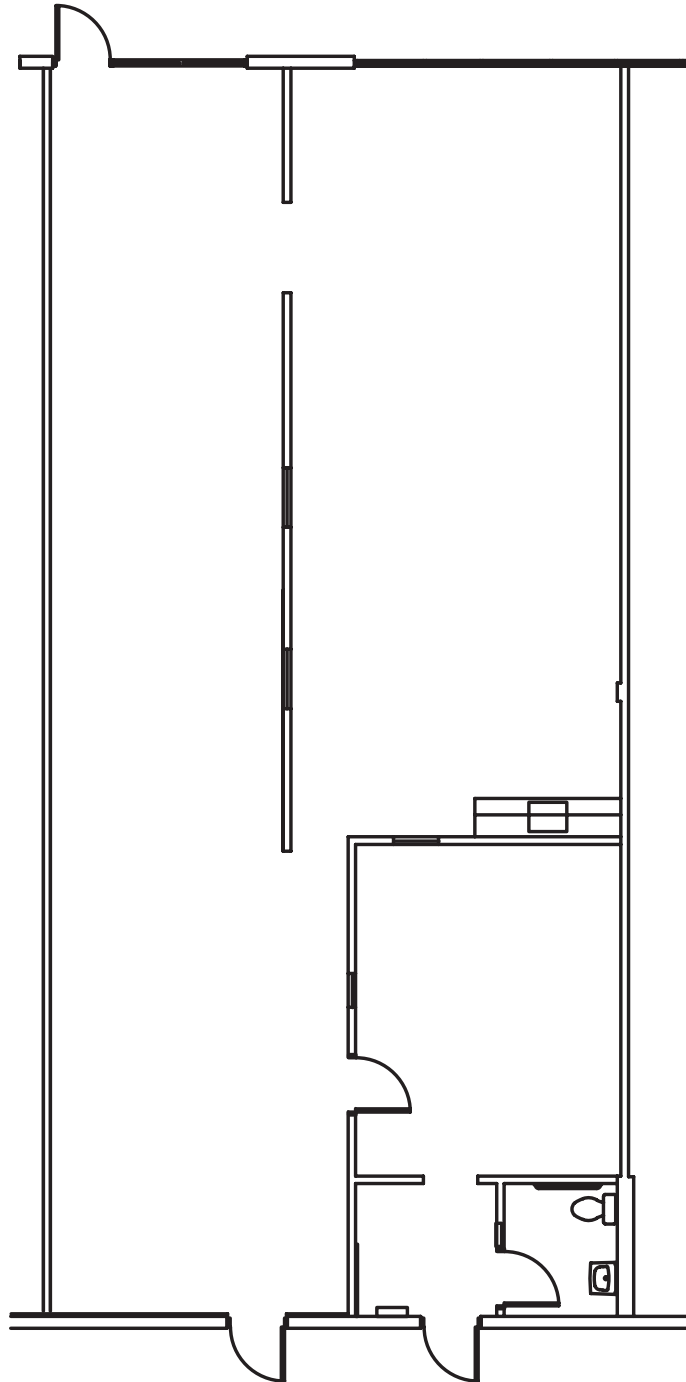

www.casehuff.com

DISCLAIMER: No warranty or representation, express or implied, is made to the accuracy of the information contained herein and same is submitted subject to errors, omissions, change of price, rental or other conditions, withdrawal without notice and to any special listing conditions imposed by our principals.

PARADISE SQUARE

SUITE PHOTOS

SUITE B107 2,200 SF

Space offered at:
\$19/sf NNN



www.casehuff.com

DISCLAIMER: No warranty or representation, express or implied, is made to the accuracy of the information contained herein and same is submitted subject to errors, omissions, change of price, rental or other conditions, withdrawal without notice and to any special listing conditions imposed by our principals.

PARADISE SQUARE

SUITE PLAN

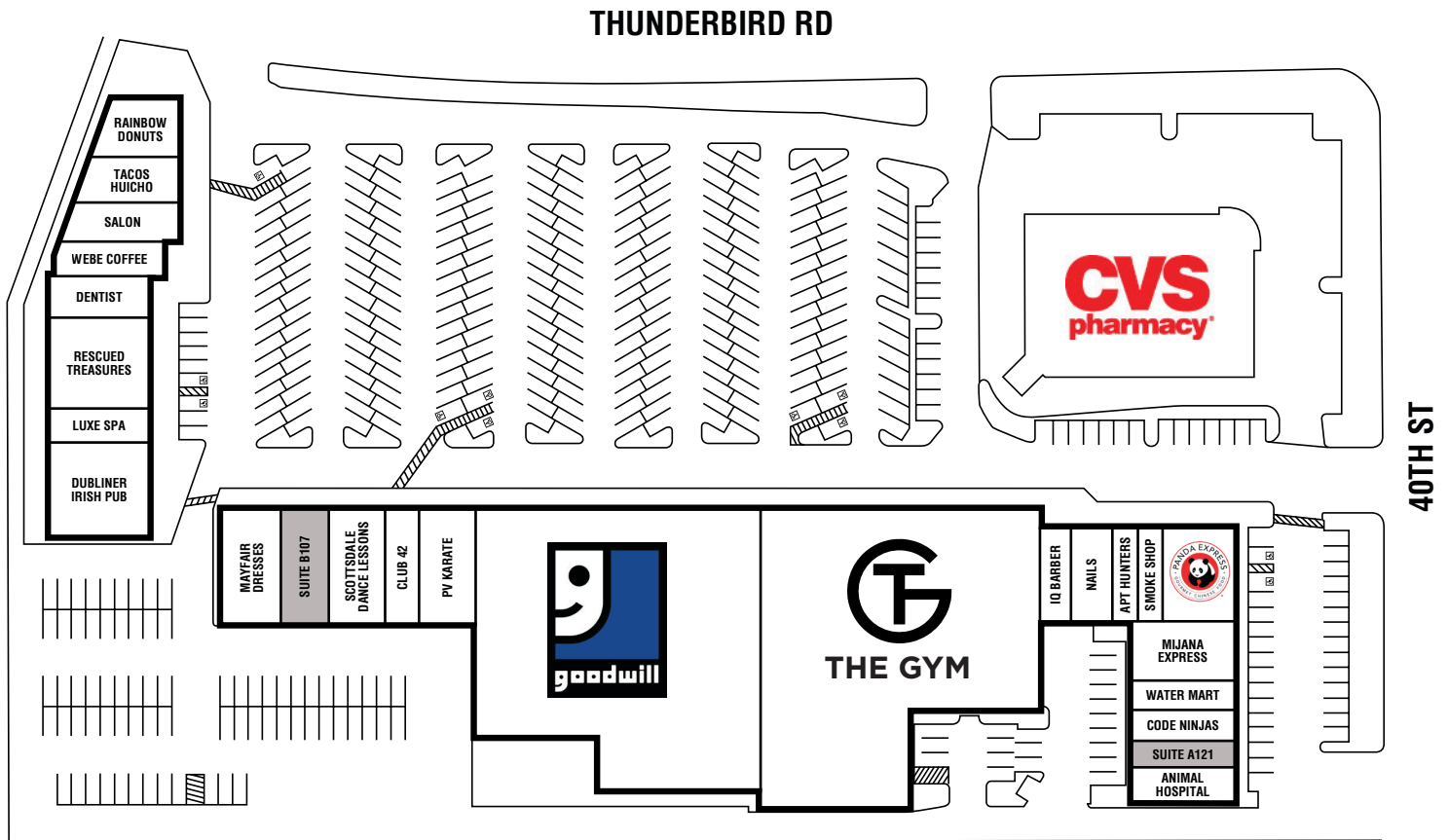

Space Available for Lease:

Suite A121	1,290 SqFt
Suite B107	2,200 SqFt

AVAILABLE SPACE
 OCCUPIED SPACE

For more information please contact:

Space offered at: **\$19/sf NNN**

Ryan Banks
Property Manager

602.252.9300 | ryanb@casehuff.com

Professionally Managed & Leased by



www.casehuff.com

DISCLAIMER: No warranty or representation, express or implied, is made to the accuracy of the information contained herein and same is submitted subject to errors, omissions, change of price, rental or other conditions, withdrawal without notice and to any special listing conditions imposed by our principals.