

# 6663-6669 E. State St. Rockford, IL



## Property Highlights

- + Available
  - 9,391 SF end cap
  - 12,480 SF in line
- + Located at the center of Rockford's primary retail corridor
- + Access provided via signalized intersection at E. State St. and Mill Rd. and right in/right out at MidAmerica Dr.
- + Under 5 minutes to I-90/E. State St. interchange
- + State St. pylon signage available
- + E. State St. traffic count: 24,900 VPD
- + **Now under \$11.00/SF NNN**



## Aerial

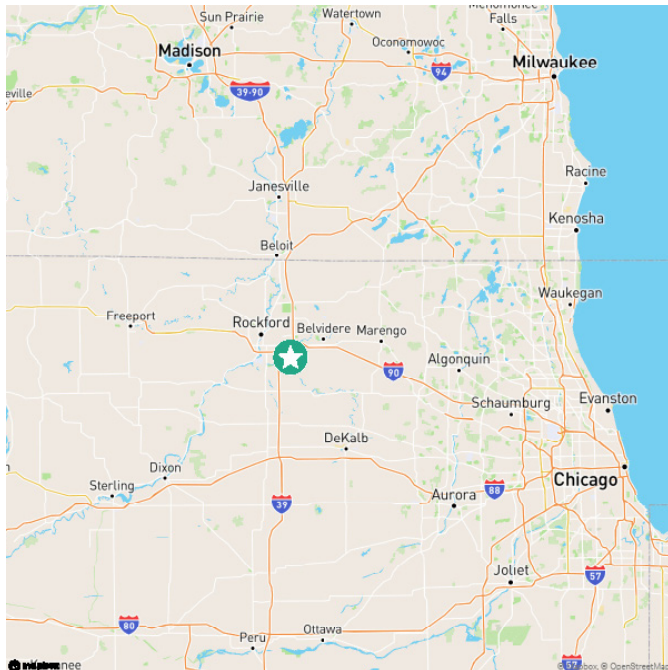

## Floor Plan

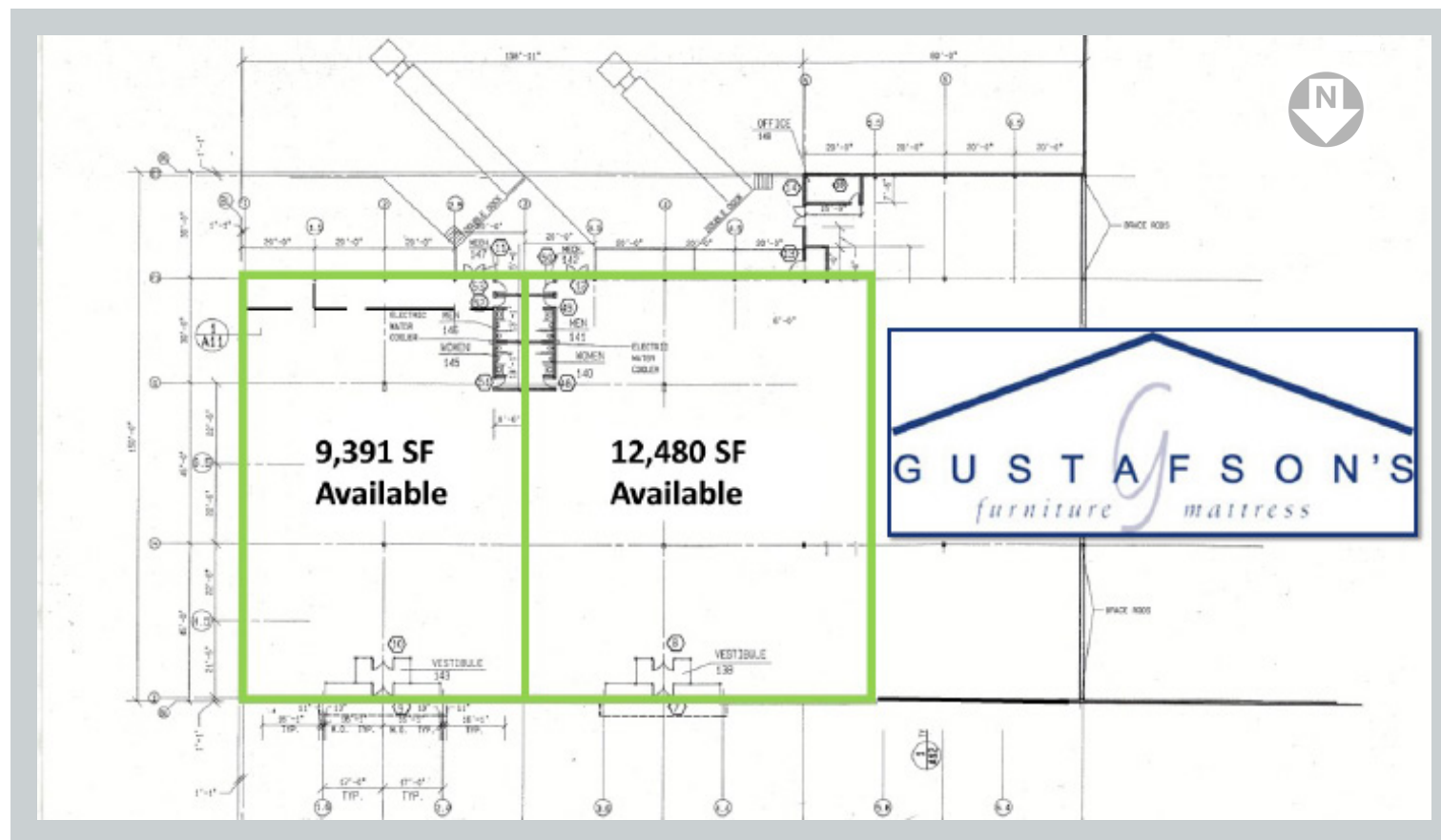







## Contact Us

Senior Vice President  
+1 815 218 3438  
Karen.Walsh@cbre.com

© 2024 CBRE, Inc. All rights reserved. This information has been obtained from sources believed reliable, but has not been verified for accuracy or completeness. You should conduct a careful, independent investigation of the property and verify all information. Any reliance on this information is solely at your own risk. CBRE and the CBRE logo are service marks of CBRE, Inc. All other marks displayed on this document are the property of their respective owners, and the use of such logos does not imply any affiliation with or endorsement of CBRE. Photos herein are the property of their respective owners. Use of these images without the express written consent of the owner is prohibited.

## Demographics

 POPULATION	1 MILE	3 MILES	5 MILES
2023 Population - Current Year Estimate	6,133	48,087	128,473
2028 Population - Five Year Projection	6,151	48,399	129,233
2020 Population - Census	6,284	49,199	130,332
2010 Population - Census	6,281	48,114	130,779
2020-2023 Annual Population Growth Rate	-0.75%	-0.70%	-0.44%
2023-2028 Annual Population Growth Rate	0.06%	0.13%	0.12%
 HOUSEHOLDS			
2023 Households - Current Year Estimate	2,792	20,364	54,265
2028 Households - Five Year Projection	2,787	20,406	54,325
2020 Households - Census	2,729	20,059	53,935
2020 Households - Census	2,829 95.2%	20,496 94.5%	54,490 93.3%
2020-2023 Compound Annual Household Growth Rate	-0.40%	-0.20%	-0.13%
2023-2028 Annual Household Growth Rate	-0.04%	0.04%	0.02%
2023 Average Household Size	2.10	2.30	2.33
 HOUSEHOLD INCOME			
2023 Average Household Income	\$89,546	\$91,850	\$85,325
2028 Average Household Income	\$100,483	\$103,293	\$96,196
2023 Median Household Income	\$58,079	\$65,139	\$58,495
2028 Median Household Income	\$64,313	\$73,502	\$65,021
2023 Per Capita Income	\$40,774	\$38,629	\$36,143
2028 Per Capita Income	\$45,571	\$43,235	\$40,546
 HOUSING UNITS			
2023 Housing Units	2,954	21,641	58,417
2023 Vacant Housing Units	162 5.5%	1,277 5.9%	4,152 7.1%
2023 Occupied Housing Units	2,792 94.5%	20,364 94.1%	54,265 92.9%
2023 Owner Occupied Housing Units	1,647 55.8%	14,491 67.0%	36,110 61.8%
2023 Renter Occupied Housing Units	1,145 38.8%	5,873 27.1%	18,155 31.1%
 EDUCATION			
2023 Population 25 and Over	4,626	35,681	91,739
HS and Associates Degrees	2,753 59.5%	20,401 57.2%	55,736 60.8%
Bachelor's Degree or Higher	1,627 35.2%	12,335 34.6%	27,361 29.8%
 PLACE OF WORK			
2023 Businesses	644	2,375	4,624
2023 Employees	12,832	38,017	79,707

