

1
E1
FIRST FLOOR POWER PLAN
SCALE: 1/4" = 1'-0"

- Legend
- 2' x 4' PARABOLIC FLUORESCENT FIXTURE 2EP3MX SURFACE MOUNTED OR EQUAL
 - FLUORESCENT STRIP LIGHT BY ELLIPTIPAR 3000 STACK LIGHT OR EQUAL
 - FLUORESCENT STRIP LIGHT 8 TWO BULB
 - FLUORESCENT STRIP LIGHT 4 TWO BULB
 - TECH MULTI HEAD MONORAIL HEAD TYPE SUPPLIED BY TENANT. LOW VOLTAGE
 - DECROITIVE FIXTURE PROVIDED BY OWNER
 - RECESSED INCANDESCENT FIXTURE W/ CLEAR ALZAK TRIM
 - BATTERY BACK-UP EMERGENCY LIGHT - DUAL HEAD - SURELITE AA1
 - LED EXIT SIGN - SURELITE AP70R
 - LED EXIT SIGN W/ DUAL HEAD EMERG. LIGHTS - SURELITE ABT RHOM COMBO.
 - LED EXIT SIGN WITH REMOTE EMERG. HEAD - SURELITE AP70R
 - HORN STROBE ALARM - SYSTEM SENSOR P 1224MC
 - STROBE ALARM
 - FIRE ALARM PULL STATION - FIRELITE BG12
 - EXTERIOR HORN STROBE ALARM - SYSTEM SENSOR P 1224MC OUTDOOR
 - SMOKE DETECTOR - SYSTEM SENSOR 2W8
 - HEAT DETECTOR - EDWARDS 284B-PL
 - COMMERCIAL GRADE 20A RECEPTACLE - LEVITON CR20WE
 - COMMERCIAL GRADE DOUBLE DUPLEX 20A RECEPTACLE - (2) LEVITON CR20WE
 - DEDICATED 20A DUPLEX OUTLET
 - GFI OUTLET - LEVITON 8899WE
 - COMMERCIAL GRADE DEDICATED COPIER RECEPTACLE
 - THERMOSTAT - PROVIDED BY OTHERS
 - CAT 6 PHONE JACK
 - CAT 6 DATA JACK
 - SWITCH - LEVITON 5424 2WIC LE (3 WAY = 5423 2WE)
 - H.C. ALARM - ALUTH HJ110 WITH SURELITE 120W12WWH
 - EXHAUST FAN - DUCTLESS, BROAN OR EQUAL
 - 175 WATT WALL PACK - METAL HALIDE
 - CABLE TV JACK
 - DATA / TEL FLOOR BOX WIREMOULD FLUSH IN SLAB

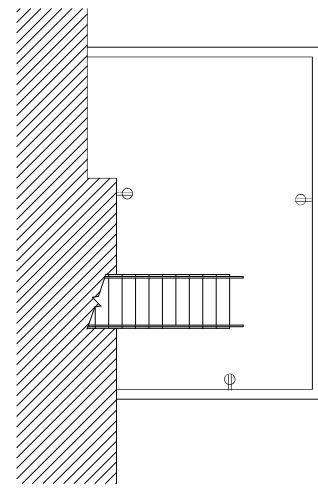

2
E1
BASEMENT POWER PLAN
SCALE: 1/4" = 1'-0"

THIS DRAWING IS THE PROPERTY OF CLARIS CONSTRUCTION. HAS BEEN PREPARED SPECIFICALLY FOR THE OWNER FOR THIS PROJECT AT THIS SITE, AND IS NOT TO BE USED FOR ANY OTHER PURPOSE, LOCATION, OR OWNER WITHOUT WRITTEN CONSENT OF CLARIS.

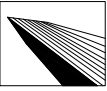

CLARIS
CONSTRUCTION INC.
Tel. 203.264.6400
Fax. 203.264.6405
www.clarisconstruction.com
133 South Main Street
Newtown, Connecticut
06470

PROJECT:
DEER HILL PARTNERS
158 DEER HILL AVENUE
DANBURY, CONNECTICUT
FIRST FLOOR POWER PLAN

DATE:
05/13/08
DRAWN BY:
JWK
SCALE:
1/8" = 1'-0"

REVISION:
07/01/08
E1

