

COMMERCIAL PROPERTY FOR SALE

2007 - 2015 E. 11th St. - Tulsa, OK 74104



- **2007 E. 11th St. ± 25,626 SF** (Source: Tulsa County Assessor)
 Building is currently being used as an Automotive showroom/service facility. The Commercial High Intensity Zoning allows for a broad mix of commercial uses.
 - Office - Showroom: 3,410 sf | 2nd Floor Office: 476 sf
 - Total Office Space: ± 3,886 sf (Source: Tulsa County Assessor)
 - Built 1970
 - One 12' x 12' grade level door
 - One 17' x 12' grade level door
 - 10' - 14' to 16' clear height

- **2015 E. 11th St. ± 1,200 SF** (Source: Tulsa County Assessor)
 Building is leased to a cannabis dispensary through June 30, 2028.
 - Built 1965
 - Two 10' x 8' grade level doors
 - 10' clear height

- **TOTAL BUILDING IMPROVEMENTS: ± 26,826 sf**
 - Site: ± 62,120 SF / ± 1.43 Acres (Source: Tulsa County Assessor)
 - Site is Fenced
 - Concrete-paved Parking (60 Spaces)

- **ZONING: CH (Commercial High Intensity)**



DOUG BAUER, CCIM
 Office: 918-665-1210



Traffic Count

INCOG 2024

7,143 Vehicles per day	E. 11th St.
11,789 Vehicles per day	S. Utica Ave.
11,667 Vehicles per day	S. Lewis Ave.



2024 Demographics

Source: ESRI

	1 Mile	3 Miles	5 Miles
Population	12,546	92,358	187,159
Households	5,177	40,055	81,197
Average HH Income	\$86,959	\$104,466	\$95,237

BAUER & ASSOCIATES, REALTORS®

"A LEADER IN TULSA COMMERCIAL REAL ESTATE SINCE 1979"

Commercial - Industrial - Investment Property - Property Management

6846 S. Canton Ave., Suite 100, Tulsa, OK 74136

All statements herein are for information purposes only and are believed to be reliable; however, no warranty or representation is made as to the accuracy thereof and the same is submitted subject to errors, omissions, change of price, terms, conditions and prior sale or lease.

Office 918-665-1210

Fax 918-665-6462

www.bauertulsa.com

COMMERCIAL PROPERTY FOR SALE

2007 - 2015 E. 11th St. - Tulsa, OK 74104



Site: ± 62,120 SF / ± 1.43 Acres*

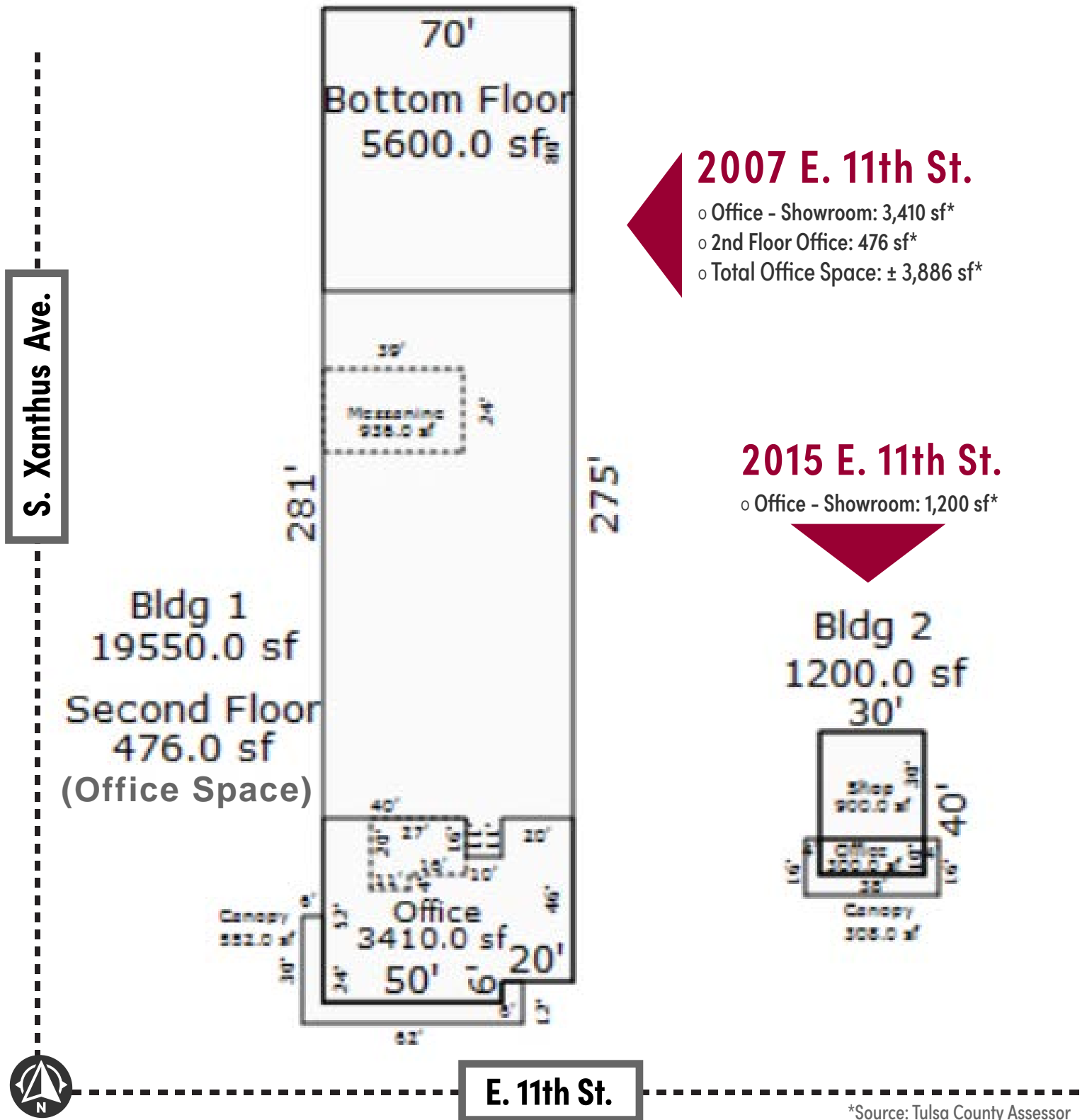

*Source: Tulsa County Assessor

BAUER & ASSOCIATES, REALTORS®

"A LEADER IN TULSA COMMERCIAL REAL ESTATE SINCE 1979"

Commercial - Industrial - Investment Property - Property Management

6846 S. Canton Ave., Suite 100, Tulsa, OK 74136

All statements herein are for information purposes only and are believed to be reliable; however, no warranty or representation is made as to the accuracy thereof and the same is submitted subject to errors, omissions, change of price, terms, conditions and prior sale or lease.

DOUG BAUER, CCIM

Office 918-665-1210

www.bauertulsa.com

COMMERCIAL PROPERTY FOR SALE

2007 - 2015 E. 11th St. - Tulsa, OK 74104

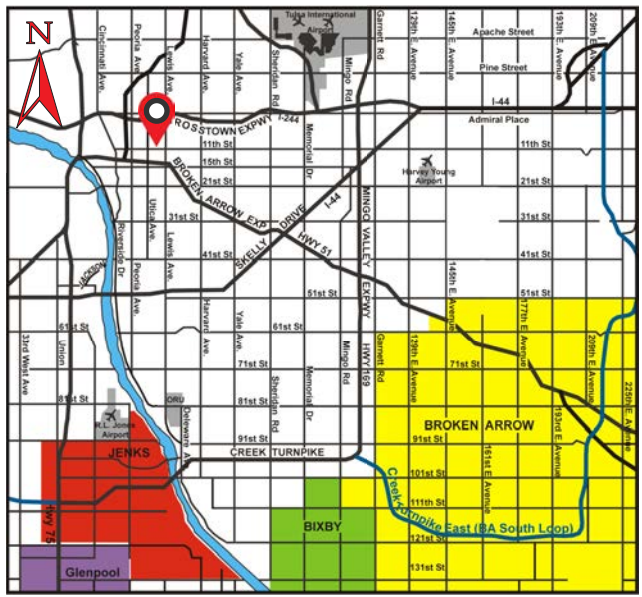
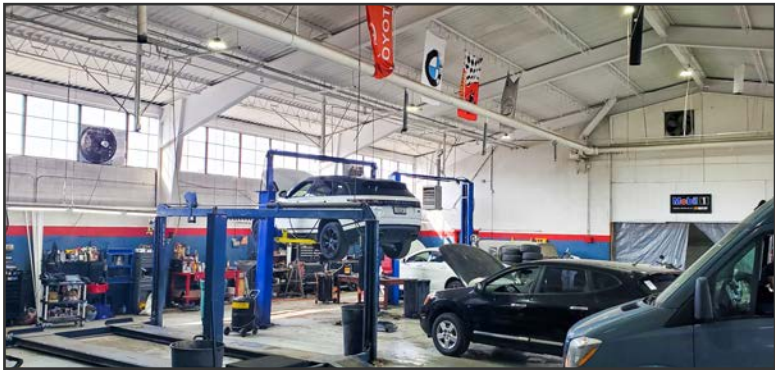

Greater Tulsa Area Map

NEARBY

- EL RANCHO GRANDE MEXICAN FOOD
- HOWDY BURGER
- IKE'S CHILI
- EMPIRE SLICE SHOP PIZZA
- RED LIGHT CHICKEN
- RENAISSANCE BREWING CO.
- TULSAN ATHLETIC CLUB

BAUER & ASSOCIATES, REALTORS®
 "A LEADER IN TULSA COMMERCIAL REAL ESTATE SINCE 1979"
 Commercial - Industrial - Investment Property - Property Management

DOUG BAUER, CCIM
 Office: 918-665-1210
www.bauertulsa.com