



64,324 SF INDUSTRIAL BUILDING FOR SALE

3125 SALEM TURNPIKE

Roanoke, Virginia 24017



CUSHMAN &
WAKEFIELD

THALHIMER

3125 SALEM TURNPIKE

Roanoke, Virginia 24017



Property Features

- 64,324 SF Industrial Building
- 3.226 Acres
- 30,000 SF Leased
- Five loading docks
- Plenty of parking
- Presently a multi-tenant warehouse
- Conveniently located
- \$1,975,000

Specifications

Year Built:	1954
Zoning:	I-1
Clear Height:	11'
Loading:	Four Dock Doors
Parking:	50 Surface Spaces

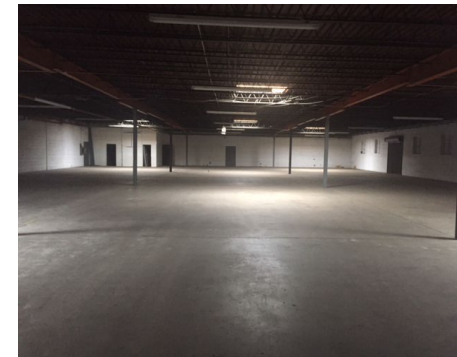

3125 SALEM TURNPIKE

Roanoke, Virginia 24017



3125 SALEM TURNPIKE

Roanoke, Virginia 24017

SITE PLAN

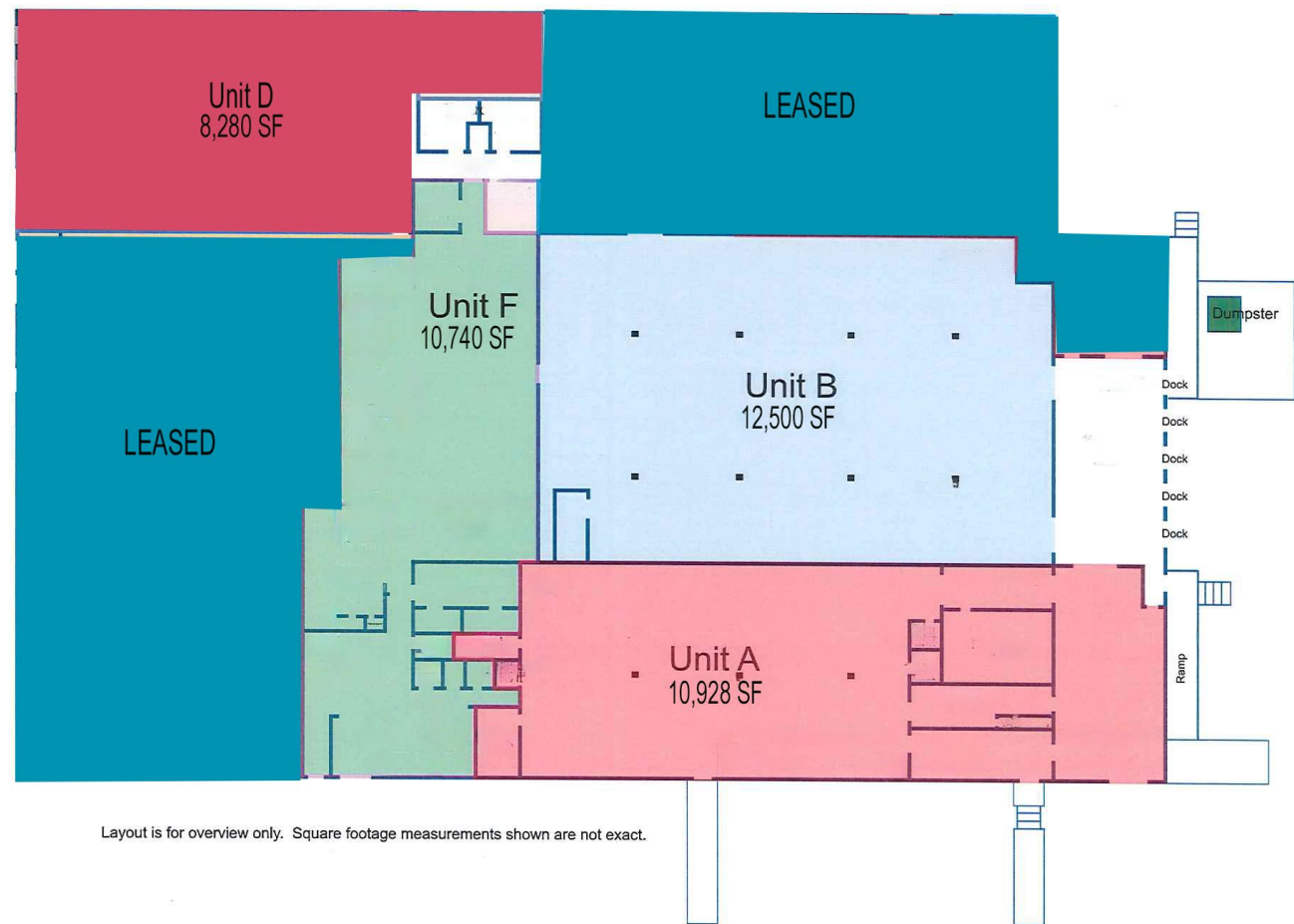

3125 SALEM TURNPIKE

Roanoke, Virginia 24017

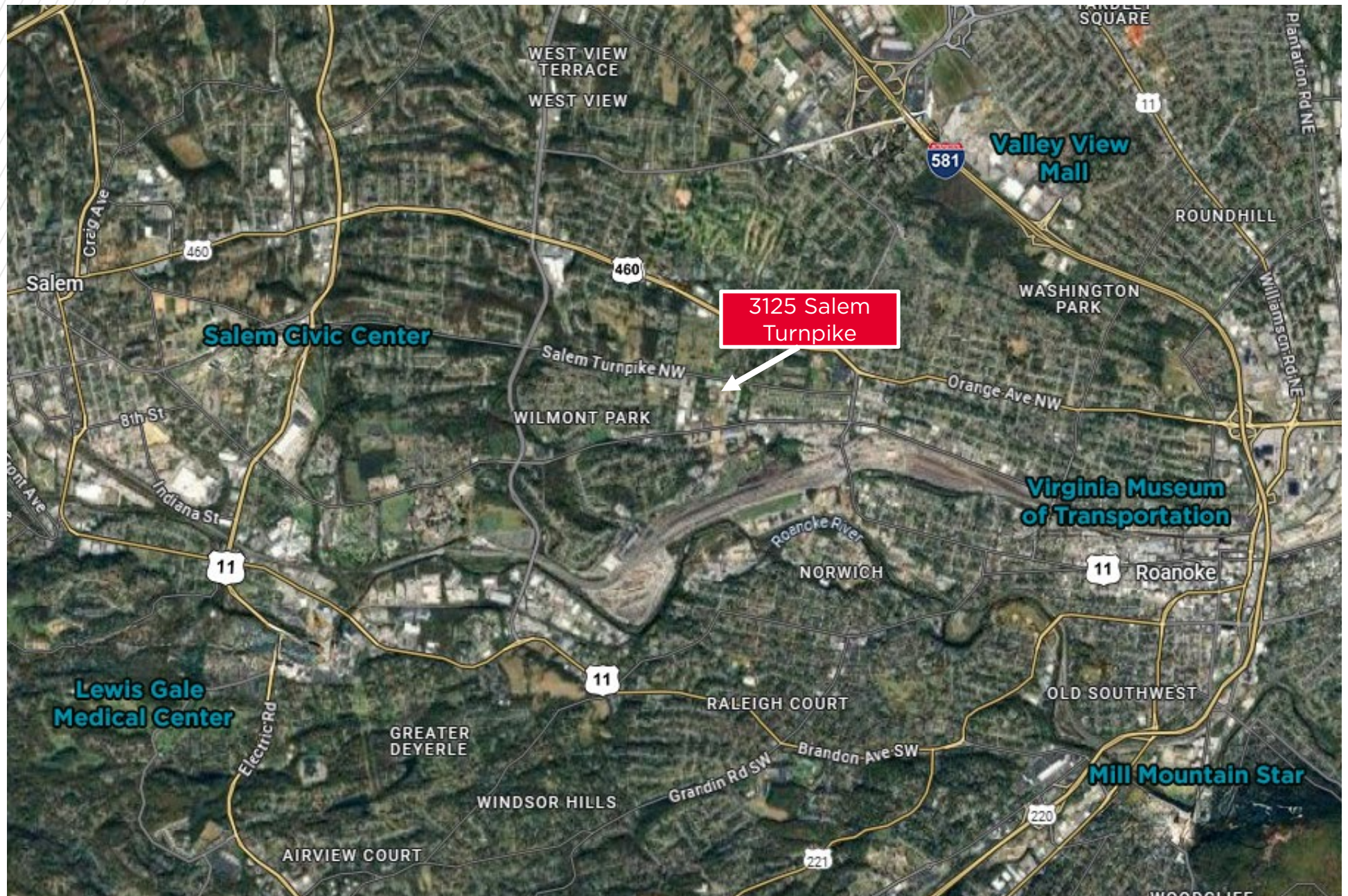



FOR MORE INFORMATION, CONTACT:

Boyd Johnson

Vice President

540 767 3002

boyd.johnson@thalhimer.com

Thalhimer

310 First Street, Suite 300

Roanoke, VA 24011

thalhimer.com

Independently Owned and Operated / A Member of the Cushman & Wakefield Alliance

Cushman & Wakefield | Thalhimer © 2025. No warranty or representation, express or implied, is made to the accuracy or completeness of the information contained herein, and same is submitted subject to errors, omissions, change of price, rental or other conditions, withdrawal without notice, and to any special listing conditions imposed by the property owner(s). As applicable, we make no representation as to the condition of the property (or properties) in question.



**CUSHMAN &
WAKEFIELD**

THALHIMER