



LANDMARK  
COMMERCIAL



**SANDLOT GARAGE CONDOS**

WHERE THE BIG KIDS GO TO PLAY

[www.sandlotcondos.com](http://www.sandlotcondos.com)



# SANDLOT CONDOS AT ABERDEEN

NE CORNER OF 119TH AND 21ST ST. NORTH, WICHITA, KS 67205

[www.landmarkrealestate.net](http://www.landmarkrealestate.net) | 156 North Emporia Ave, Wichita, KS 67202

All information is deemed to be accurate, however, Broker makes no guarantee as to the accuracy of the terms and conditions represented herein.



# PROPERTY SUMMARY

## [CLICK HERE FOR VIDEO TOUR](#)

Address	NE Corner of 119th and 21st St. North, Wichita, KS 67205
Available Space	1,128 - 3,575 sq. ft.
Dimensions	50'-55' deep with varying widths
Year Built	Anticipated completion late summer 2024
Overhead Door	12' wide x 14' tall
Security	24/7 secured fence with gate access
HVAC	Individual heating and cooling systems
Unit Features	3' pedestrian commercial steel door, 5" structural concrete slab, separately metered 125A electric service, conduit for phone, cable and internet
Electrical	125A electrical service, (3) recepticals, ample LED overhead lighting



# FEATURES



SANDLOT GARAGE CONDOS  
WHERE THE BIG KIDS GO TO PLAY

## UNIT FEATURES

- Owner can customize buildout with mezzanine, bathroom, kitchenette, car lifts, epoxy flooring, etc.
- Electric overhead insulated doors with openers (12'w x 14'h) with windows
- Individual heating and cooling systems
- 16' to 17 ½' ceiling height
- Tinted commercial window units
- Rough-in for a bathroom with floor drain
- Water service available in unit
- Sheet rock separation walls ready for paint or panels
- Perfect for a man-cave and storage of cars, boats, motorcycles, etc.
- Fully insulated units

## SITE FEATURES

- Premier location in West Wichita
- On-site common bathrooms
- 24/7 secured fence and gate access
- Wide drive aisle at 60' for convenient unit access
- On-site trash
- HOA office
- Exterior hose water hydrant for washing
- Exterior security cameras
- 10-year roof warranty
- Possible patio





# SITE

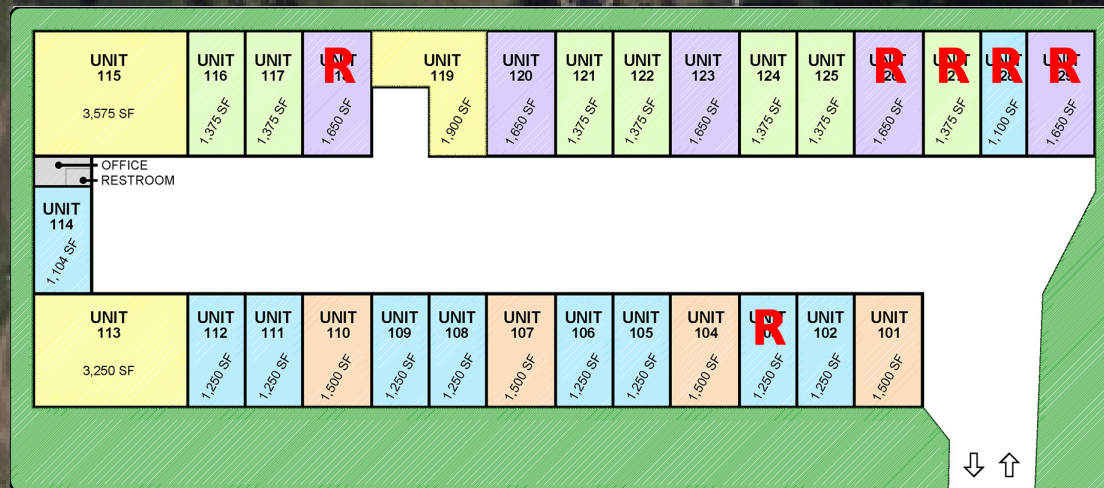

## Sandlot Condos at Aberdeen 21st & 119th





# SITE PLAN



SANDLOT GARAGE CONDOS

WHERE THE BIG KIDS GO TO PLAY

## UNIT SIZES

1,104 SF (24' x 46')  
1,250 SF (25' x 50')  
1,375 SF (25' x 55')

1,500 SF (30' x 50')  
1,650 SF (30' x 55')

3,250 SF (50' x 65')  
3,575 SF (55' x 65')

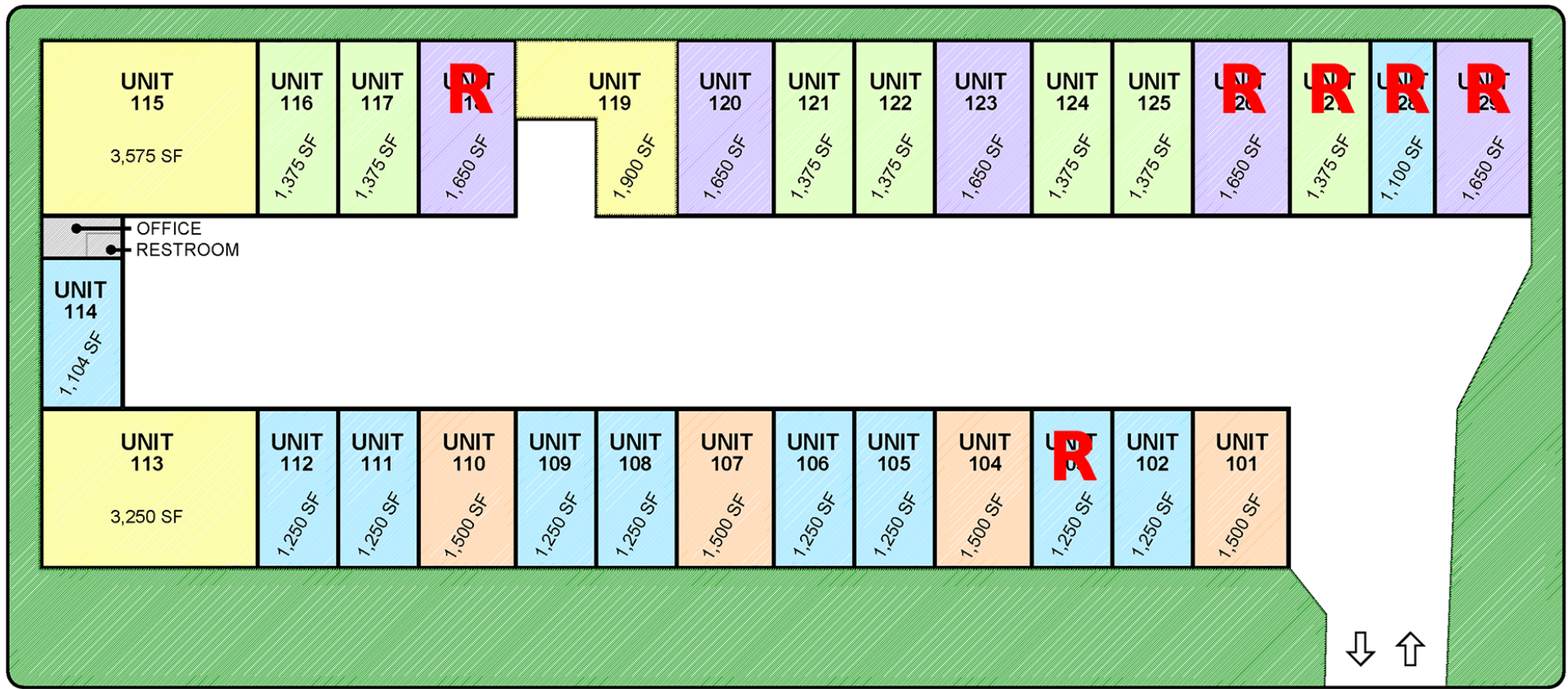



# SITE OUTLINE

## Sandlot Condos Phase 1 & 2 (Sold Out)

33rd and Ridge





**LANDMARK  
COMMERCIAL**  
REAL ESTATE

156 North Emporia  
Wichita, Kansas 67202  
[www.landmarkrealestate.net](http://www.landmarkrealestate.net)

For More Information:

**DON PIROS, CCIM**  
SR. VICE PRESIDENT

Mobile: 316-990-0606  
[dpiros@landmarkrealestate.net](mailto:dpiros@landmarkrealestate.net)

## ABOUT LANDMARK

Landmark Commercial Real Estate, Inc. has extensive experience in the leasing and sales of retail, office, restaurant and industrial properties, as well as property management. We represent both Owners and Tenants/Buyers. Our extensive experience with both sides of the transaction gives us added insight in negotiating transactions that work for both parties. Landmark Commercial Real Estate maintains a large property database, which we utilize to provide Tenants with quick and reliable information. Landmark is also experienced in all phases of commercial real estate development including evaluation, conception, site selection, site planning, developmental services, construction management and leasing.

Landmark prides itself on our success in focusing on leasing and marketing properties for sale, lease and development. Many of the properties we handle are owned by institutional owners, investors and developers, who demand a high level of reporting and results. We are selective in the Listings that we accept, and we provide a commitment to results through implementation of a strategic marketing plan on every property.

## DISCLAIMER

Information included herein was provided by third parties and should only be used for informational purposes. Landmark Commercial Real Estate, Inc and their respective agents, representatives, and employees, (i) make no representations or warranties of any kind, express or implied, with respect to the accuracy or completeness of any information included herein, and (ii) shall have no liability whatsoever arising from any errors or discrepancies between the above listed information and actual documents.