



FOR SALE

1695 & 1697 MAIN ST FERNDAL

- **GENERAL INFORMATION**
- **PHOTOS**
- **AREA DEMOGRAPHICS**



KEVIN GERAGTHY, CCIM

keving@windermere.com

360-319-6351

www.wrecommercial.com

1695 & 1697 MAIN ST, FERNDALE

FOR SALE:
\$1,900,000 per pad

Best location in Ferndale just 10 minutes north of Bellingham, Ferndale is the fastest growing city in Northwest Washington. Located 15 minutes from the 2nd busiest land border crossing to Canada. Over 3 million people in the great Vancouver Metro area. 2 QSR pads at I-5 & Main St exit over 50,000 vehicles a day on I-5 & over 10,000 vehicles a day on Main St. Buy One for \$1.9m of both for \$3.8m. Current property taxes are for both QSR parcels.

Property is being developed into 2 QSR pads buy one for 1.9m or both for 3.8 Active construction site please get prior approval to enter property. Ok to park to observe the property from adjacent WTA parking lot. Please use Lisa S. at Chicago Title. Whatcom County has not assigned separate Tax ID yet.

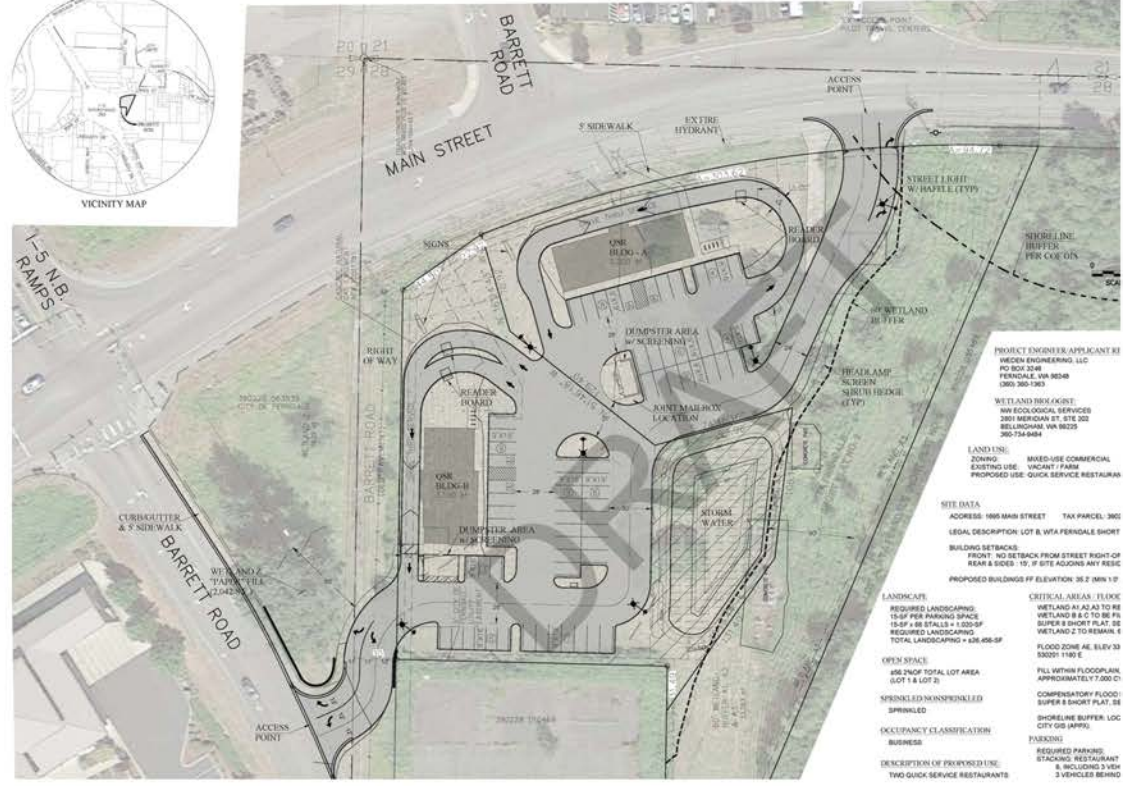

FOR SALE

1695 & 1697 MAIN STREET FERNDALE



ENDEAVOR



FRONT ELEVATION



BACK ELEVATION



SIDE ENTRY ELEVATION



DRIVE-THRU ELEVATION

FOR SALE

1695 & 1697 MAIN STREET FERNDALE



LOCATION & DEMOGRAPHICS

Location Facts & Demographics

Demographics are determined by a 10 minute drive from 1695 Main St, Ferndale, WA 98248

CITY, STATE

Ferndale, WA

POPULATION

42,281

AVG. HHSIZE

2.51

MEDIAN HH INCOME

\$51,481

HOME OWNERSHIP

Renters: **7,393**

Owners: **9,879**

EMPLOYMENT

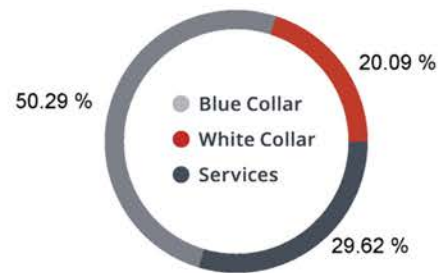

47.90 %
Employed

2.27 %
Unemployed

EDUCATION

High School Grad: **30.86 %**
Some College: **26.27 %**
Associates: **7.11 %**
Bachelors: **22.50 %**

GENDER & AGE

49.13 % 50.87 %

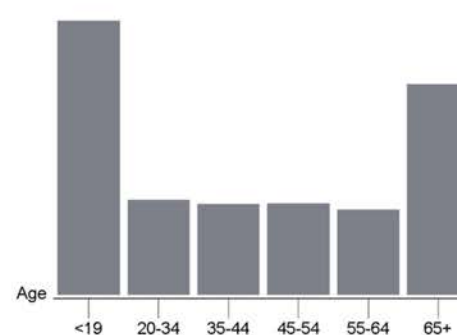

RACE & ETHNICITY

White: **75.51 %**
Asian: **1.87 %**
Native American: **1.18 %**
Pacific Islanders: **0.06 %**
African-American: **0.54 %**
Hispanic: **11.85 %**
Two or More Races: **8.99 %**

MOODY'S

INCOME BY HOUSEHOLD

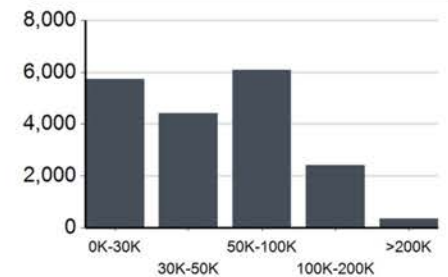

HH SPENDING

