

# THE MARKETPLACE AT PROVIDENCE



## NEW RETAIL DEVELOPMENT PARCELS AVAILABLE

U.S. HIGHWAY 17-92 & KINNEY HARMON ROAD  
DAVENPORT, FLORIDA 33837

**ALEX BISBEE**  
407-864-6444

**PAYTON FOSTER**  
407-461-8080



## PROPERTY HIGHLIGHTS

- Outparcel opportunities available at +/- 23 acre new retail development.
- Across from Loughman Crossing - a high grossing new Publix development.
- Located at the signalized intersection of Hwy 17-92 and Kinney Harmon Rd/Poinciana Parkway - the main artery leading the 80,000 residents from Poinciana to I-4.
- At the entrance to Providence - a gated community with over 9,000 new homes and a championship golf course.

## 2023 DEMOGRAPHICS

	Population	1 Mile	2,473
		3 Mile	17,801
		5 Mile	43,913

	Employees	1 Mile	248
		3 Mile	2,872
		5 Mile	9,519

	Average Household Income	1 Mile	\$85,913
		3 Mile	\$91,830
		5 Mile	\$89,976

	Growth	1 Mile	3.2%
		3 Mile	3.3%
		5 Mile	3.3%



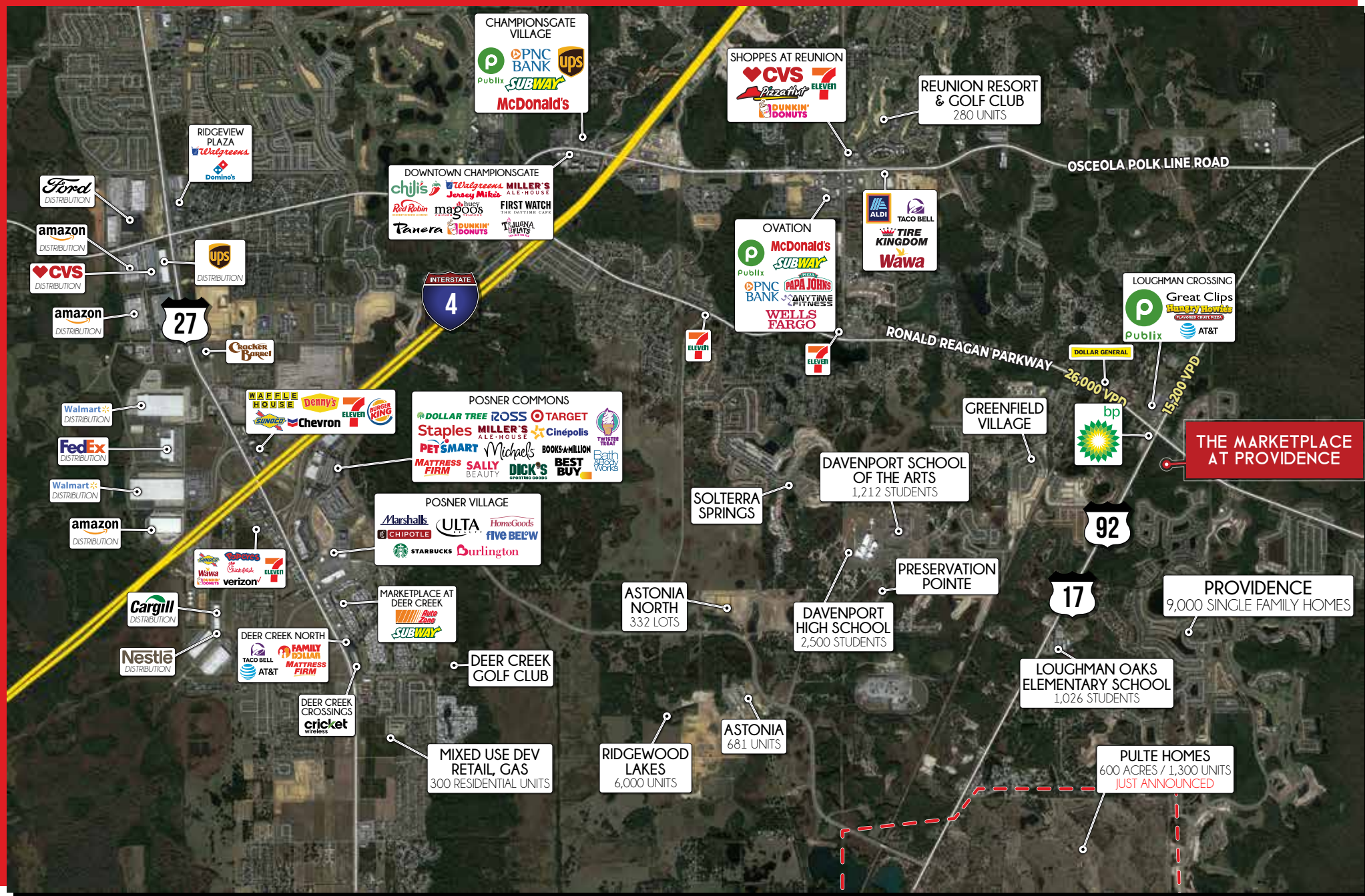

Taylor Morrison's Westview (6,000+ new homes) master planned community has begun

with construction progressing north. This community is located about 9 miles SE from The Marketplace at Providence. Most importantly – The Marketplace at Providence is 'on the way home' side of the road to this community from I-4.

## TAYLOR MORRISON'S WESTVIEW

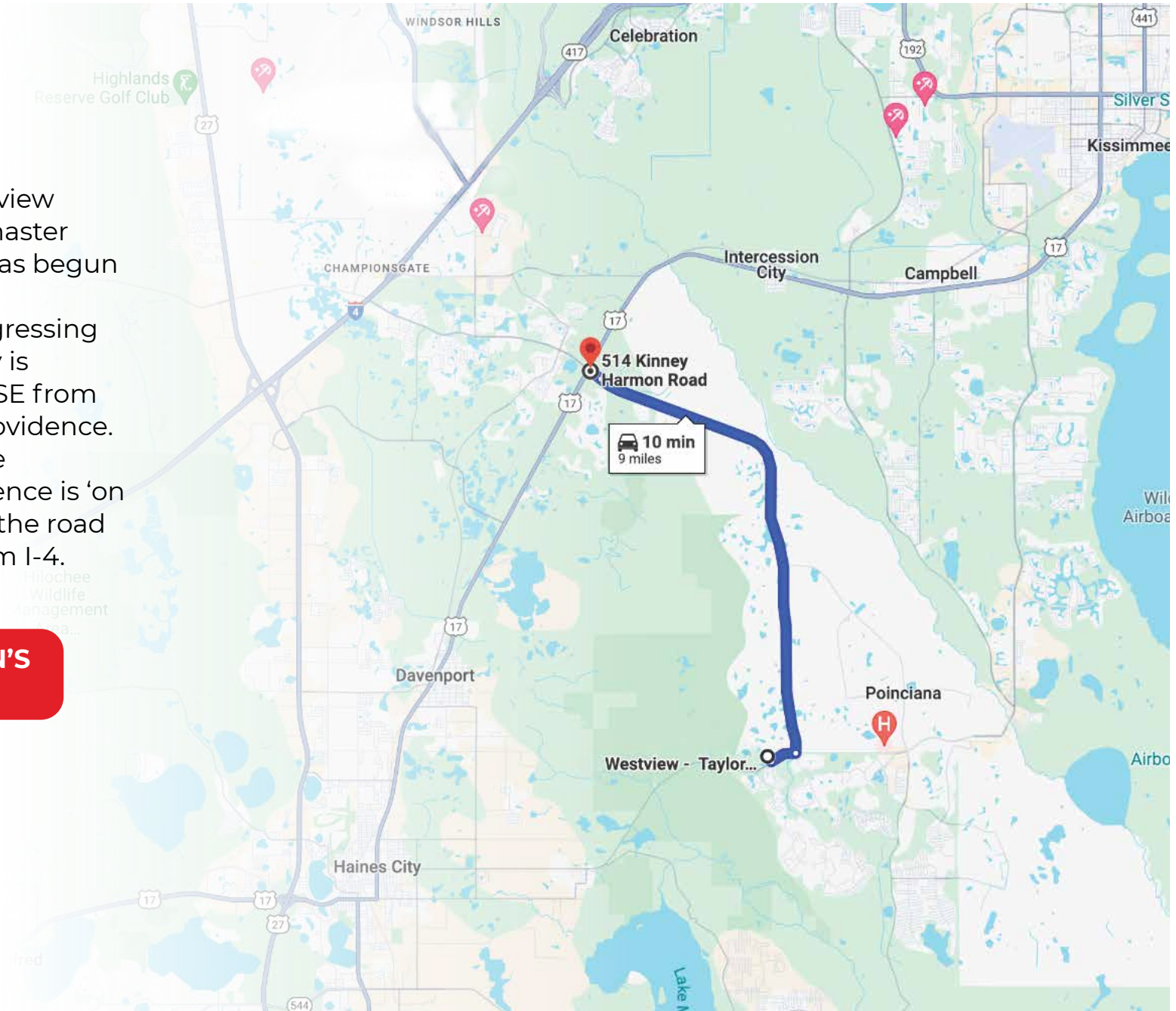

# SITE PLAN



US HWY 17-92 N

29,500 VPD

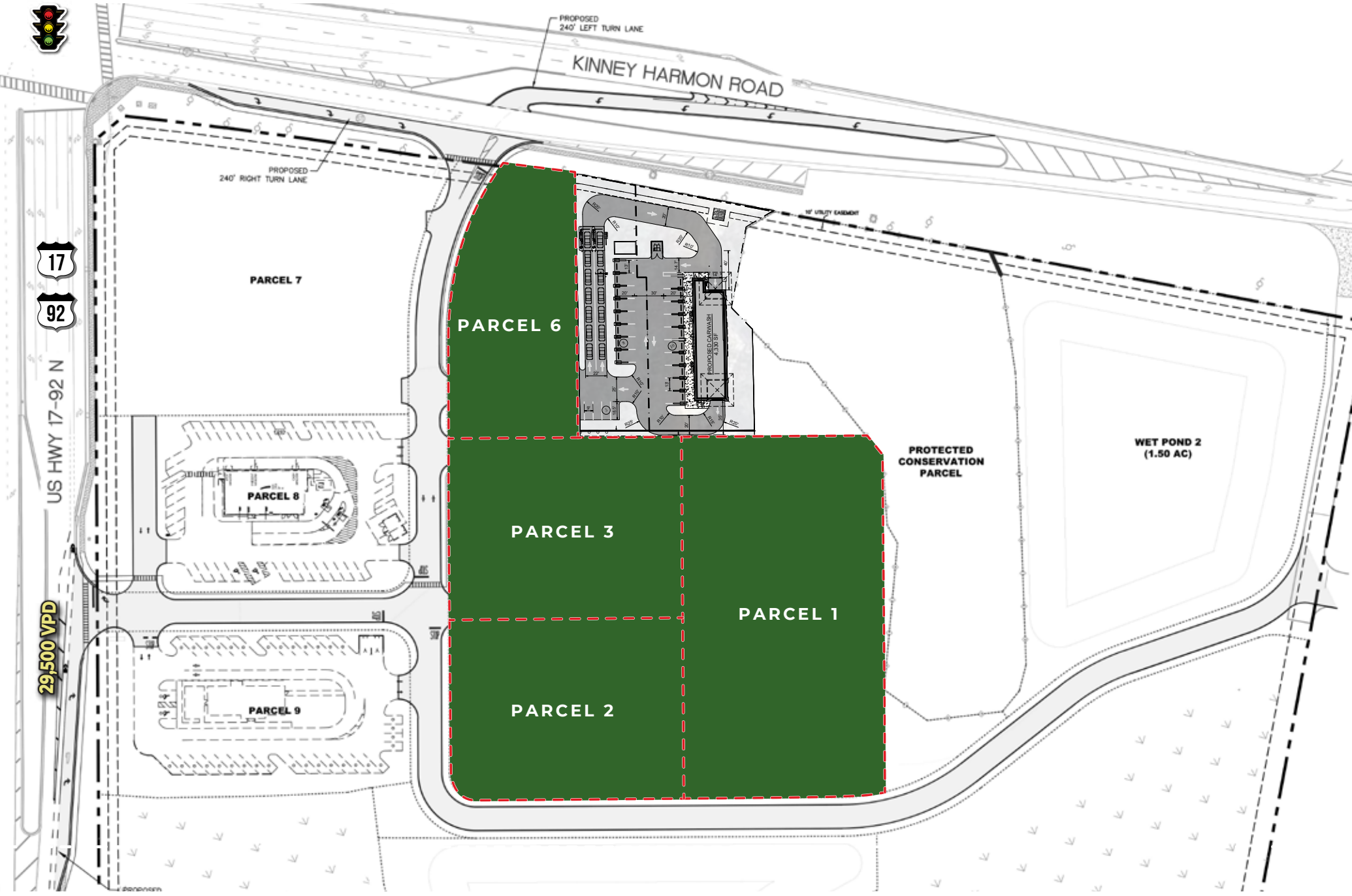

FOR MORE  
INFORMATION  
PLEASE CONTACT

**ALEX BISBEE**

407-864-6444

ABISBEE@INSITEREI.COM

**PAYTON FOSTER**

407-461-8080

PFOSTER@INSITEREI.COM

