



6 LOWES DRIVE | SARATOGA SPRINGS, NY

LOWE'S CENTER

1,633 SF IN-LINE AVAILABLE | FOR LEASE

PROJECT DETAILS

SARATOGA SPRINGS, NY • 1,633 SF AVAILABLE • FOR LEASE

PROPERTY HIGHLIGHTS

- Strategically situated in front of Lowe's and Walmart Supercenter, the center benefits from cross access between properties.
- Lowe's Center is located in the Town of Wilton, less than 3 miles from downtown Saratoga Springs.
- Close proximity to over 2 million sf of retail within 1 mile.
- The 1,633 SF in-line space is available for lease.
- Offers 78 shared parking spaces.
- Cotenants: Mattress Firm, Subway, & Sitwell Dental
- Pylon sign available at corner of Route 50 & Old Gick Road.

OFFERING SUMMARY

LEASE RATE	\$28.00 PSF NNN
AVAILABLE SF	1,633 SF
DIMENSIONS	23' x 70'

DEMOGRAPHICS

TOTAL POPULATION

1 MILE	3 MILES	5 MILES
3,724	29,369	46,653

DAYTIME POPULATION

1 MILE	3 MILES	5 MILES
5,547	40,152	57,836

TOTAL HOUSEHOLD

1 MILE	3 MILES	5 MILES
1,859	12,941	20,329

MEDIAN HH INCOME

1 MILE	3 MILES	5 MILES
\$98,422	\$88,660	\$89,053



SITE PLAN

LOWE'S CENTER • 1,633 SF AVAILABLE • RETAIL

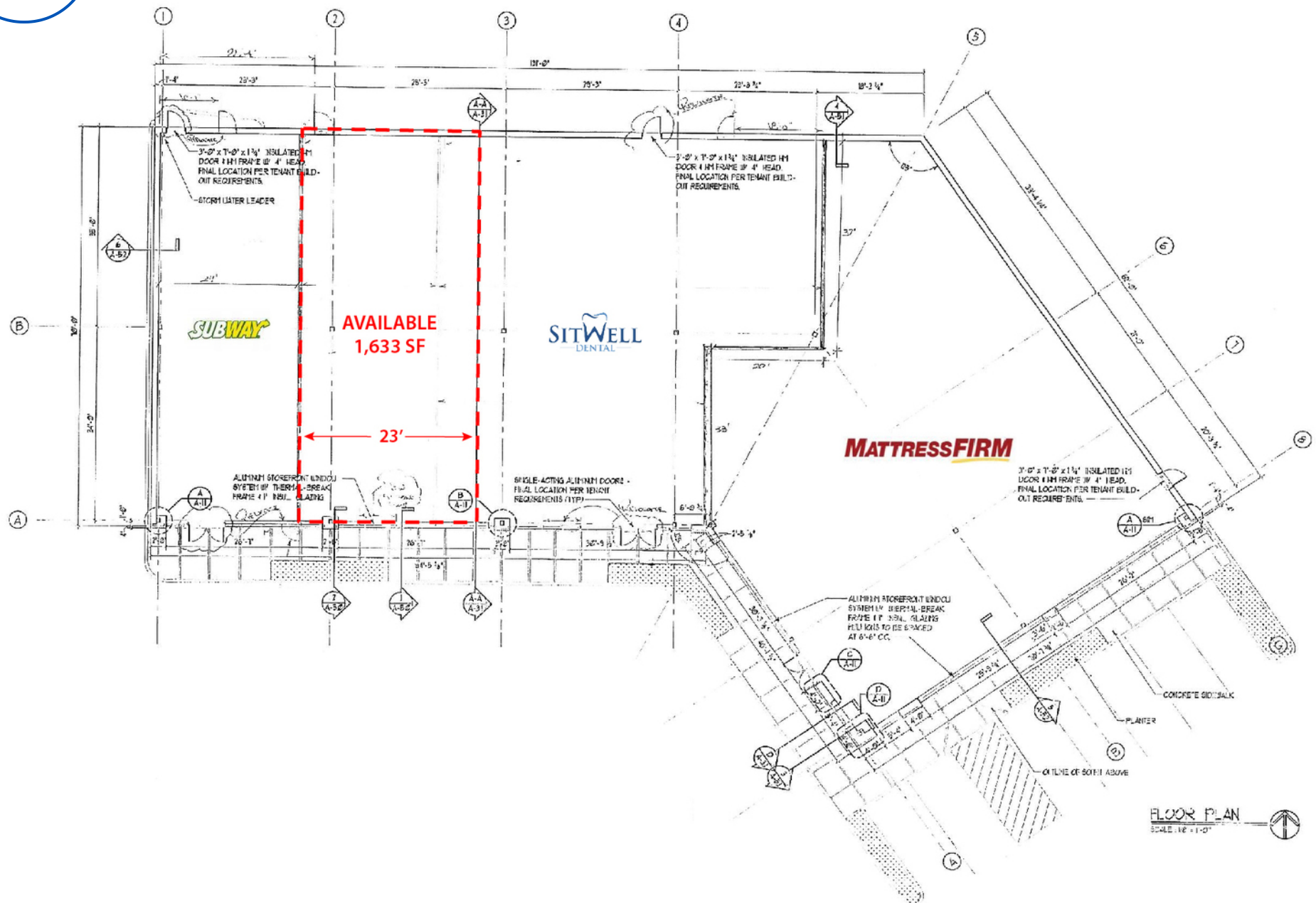

AERIAL

SARATOGA SPRINGS, NY • 1,633 SF AVAILABLE • FOR LEASE



6 LOWES DRIVE | SARATOGA SPRINGS, NY

LOWE'S CENTER

1,633 SF IN-LINE AVAILABLE | FOR LEASE

ALISON BURNSIDE

518.785.8200

ABURNSIDE@ATLANTICRETAIL.COM

AVAILABLE



ALBANY

15A CENTURY HILL DRIVE

518.785.8200

ATLANTA

BOSTON

CHARLOTTE

LOS ANGELES

NEW YORK CITY

ORLANDO

PITTSBURGH

WEST PALM BEACH

WWW.ATLANTICRETAIL.COM

LINKEDIN.COM/COMPANY/ATLANTIC-RETAIL-PROPERTIES

INSTAGRAM.COM/ATLANTIC_RETAIL

REALTY RESOURCES **CHAINLINKS**
RETAIL ADVISORS