

846 HEBRON ROAD

HEATH, OH

LAND FOR SALE OR LEASE

0.78 Acres Available



**SIGNATURE
ASSOCIATES**
KNOW SIGNATURE | KNOW RESULTS

RETAIL PARCEL FOR DEVELOPMENT



PROPERTY FEATURES

- Approximately 0.78 acres available
- Over 30,000 cars per day
- Great for a variety of uses including bank/financial, QSR/fast food, general retail, professional office/medical and more
- Zoned B-3
- Sale Price: \$1,500,000
- Ground Lease: \$125,000/year

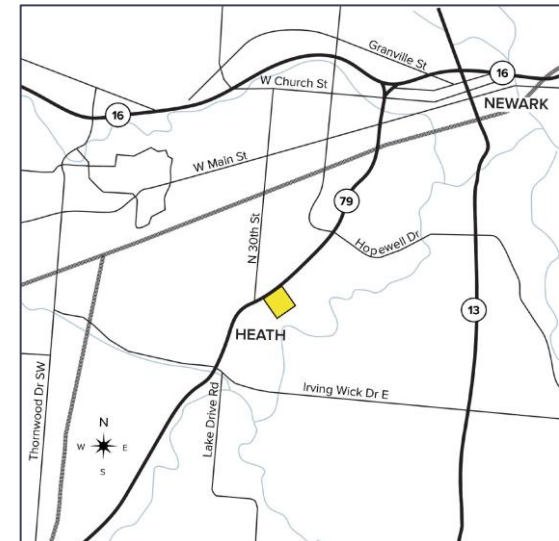

For more information, please contact:

JOE RIZQALLAH

(616) 822 6310

jrizqallah@signatureassociates.com

SIGNATURE ASSOCIATES

1188 East Paris Ave SE, Suite 220

Grand Rapids, MI 49546

www.signatureassociates.com

Information is subject to verification and no liability for errors or omissions is assumed. Price is subject to change and listing withdrawal.

846 Hebron Road – Heath, Ohio

Land For Sale

0.78
Acres
AVAILABLE

Site Plan

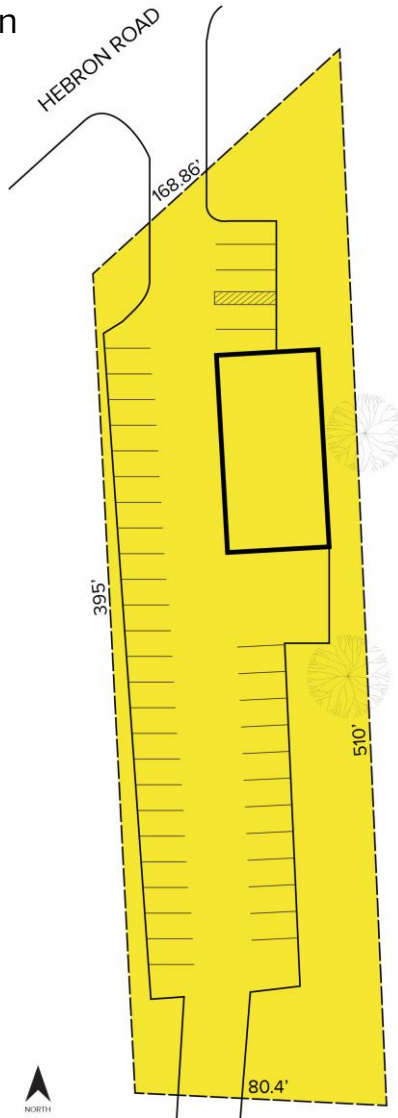

DEMOGRAPHICS

	POPULATION	MED. HH INCOME
1 MILE	5,340	\$70,258
3 MILE	37,038	\$71,555
5 MILE	70,062	\$72,589

TRAFFIC COUNTS (TWO-WAY)

30,382	SR 79 north of S 30 th Street
16,247	SR 79 south of S 30 th Street
4,639	Heath Road west of M-79
2,439	Dorsey Mill Road east of M-79

For more information, please contact:

JOE RIZQALLAH

(616) 822 6310

jrizqallah@signatureassociates.com

SIGNATURE ASSOCIATES
1188 East Paris Ave SE, Suite 220
Grand Rapids, MI 49546
www.signatureassociates.com

Information is subject to verification and no liability for errors or omissions is assumed. Price is subject to change and listing withdrawal.