

1500

OLYMPIC BLVD.
SANTA MONICA, CA

CREATIVE OFFICE BUILDING FOR LEASE

IN THE HEART OF SILICON BEACH

DRASTIC RATE REDUCTION!

YOUR NAME HERE

1500

PRIME SILICON BEACH OFFICE
±7,000 SF AVAILABLE

NAI Capital
COMMERCIAL REAL ESTATE SERVICES, WORLDWIDE

No warranty, express or implied, is made as to the accuracy of the information contained herein. This information is submitted subject to errors, omissions, change of price, rental or other conditions, withdrawal without notice, and is subject to any special listing conditions imposed by our principals. Cooperating brokers, buyers, tenants and other parties who receive this document should not rely on it, but should use it as a starting point of analysis, and should independently confirm the accuracy of the information contained herein through a due diligence review of the books, records, files and documents that constitute reliable sources of the information described herein. NAI Capital CA BRE #01990696

Joseph Gabbaian
Executive Vice President

310.806.6134

jgabbaian@naicapital.com

Cal DRE Lic #01016301

1500

OLYMPIC BLVD.
SANTA MONICA, CA

CREATIVE OFFICE BUILDING FOR LEASE

IN THE HEART OF SILICON BEACH

Property Features

- Drastically reduced rate for short-term leases
- Hard-to-find freestanding building in the heart of the Media District
- Across Olympic Blvd. from the Memorial Park and adjacent to the Buffalo Club
- High ceilings with several large skylights that bring lots of natural light into the interior space
- Potential for prominent signage
- 21 parking spaces and outdoor space in the gated front surface lot
- Within walking distance of the Buffalo Club, Tacos por Favor, DK's Donuts & Bakers, 18th Street Coffee House
- Close to Expo Line Station at 16th & Colorado

Asking Lease Rate

\$2.45/SF, MG

Lease Terms

Two (2) years

Tenant Improvements

Negotiable

Parking

21 spaces at \$100/Space/Mo.

Availability

1st Floor

Three window offices, large window-lined office/conference room, large open area with skylights, separate large open area with roll-up door to the adjacent alley and access to the front open space, two ADA-compatible bathrooms, large open kitchen with access to outdoor space, storage/IT room, high exposed ceilings, concrete floors

2nd Floor

One large window office, conference room, bathroom



1500

OLYMPIC BLVD.
SANTA MONICA, CA

CREATIVE OFFICE BUILDING FOR LEASE

IN THE HEART OF SILICON BEACH

Santa Monica's Leading Economic Sector Snapshot:

Creative Industries + Technology Sector (aka "Silicon Beach")

- 2,656 businesses, employing 25,102 people (28% of the city's total employment) with a total annual payroll of \$3.5 billion (47% of the city's total annual payroll)
- Santa Monica's major tech + creative clusters are: Information (e.g. publishers, motion picture/video production, film distribution, postproduction, telecommunications, sound recording studios), Professional, Scientific + Technical Services (e.g. advertising, graphic design, computer design/programming, R + D in biotechnology) and the Arts, Entertainment and Recreation sectors.
- Examples: Activision Blizzard, Cornerstone On Demand, Edmunds.com, Hulu, Kite Pharma, Lions Gate Entertainment, Miramax Film, Oracle America, Twitter, Uber + Universal Music Group.
- Over 22 Santa Monica Co-Work Spaces and Accelerators (e.g. Cross Campus, Real Office Center, Muckerlab, Science Inc, WeWork).

Source: [www.smgov.net/City of SM Economic Development Team](http://www.smgov.net/City%20of%20SM%20Economic%20Development%20Team)

CITY OF SANTA MONICA ECONOMIC STATS 2017

The City of Santa Monica has a robust and diversified local economy.



92,987
TOTAL POPULATION



88,848
EMPLOYEES



9,515
TOTAL BUSINESSES



458
TOTAL RESTAURANTS



36.5%
EST. BACHELORS DEGREE ONLY

OLYMPIC BLVD.
SANTA MONICA, CA

IN THE HEART OF SILICON BEACH

Site plan of the existing office building and surrounding area. The plan shows a large rectangular building labeled "EXISTING OFFICE BUILDING" with a diagonal hatching pattern. To the left is an "ALLEY" and a "DRIVEWAY" with a "GATE". A "TRASH ENCLOSURE" is located near the driveway. A "CONC WALKWAY" runs along the bottom of the building. A "PARKING LOT" is located to the right of the building. A "CONC SIDEWALK" runs along the bottom of the parking lot. The plan includes various dimensions and labels for "CONC" (concrete) and "LANDSCAPING TYP" (typical landscaping). The building is situated on a lot bounded by "OLYMPIC BLVD" to the south and "ALLEY" to the west.



COMMERCIAL REAL ESTATE SERVICES, WORLDWIDE

Joseph Gabbai
Executive Vice President
310.806.6134
jgabbai@naicapital.com
Cal DRE Lic #01016301

1500

OLYMPIC BLVD.
SANTA MONICA, CA

CREATIVE OFFICE BUILDING FOR LEASE

IN THE HEART OF SILICON BEACH

1st Floor

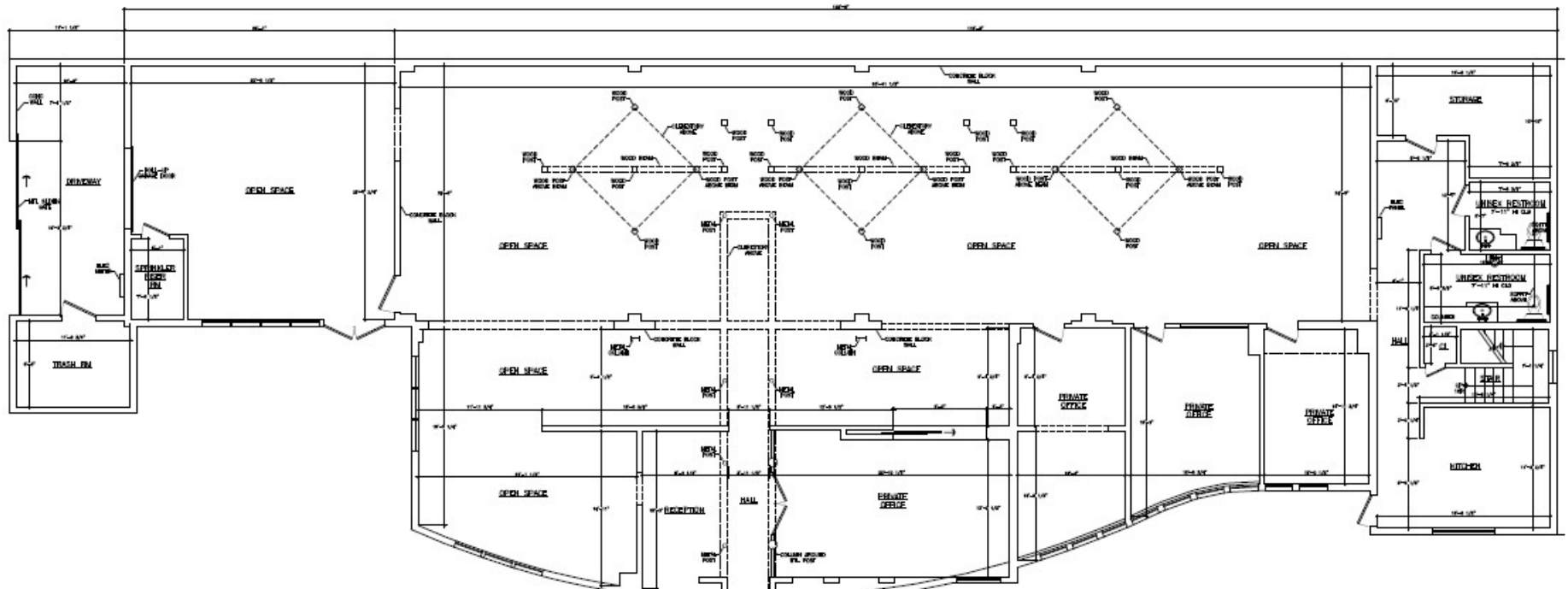

1500

OLYMPIC BLVD.
SANTA MONICA, CA

CREATIVE OFFICE BUILDING FOR LEASE

IN THE HEART OF SILICON BEACH



NAI Capital
COMMERCIAL REAL ESTATE SERVICES, WORLDWIDE

No warranty, express or implied, is made as to the accuracy of the information contained herein. This information is submitted subject to errors, omissions, change of price, rental or other conditions, withdrawal without notice, and is subject to any special listing conditions imposed by our principals. Cooperating brokers, buyers, tenants and other parties who receive this document should not rely on it, but should use it as a starting point of analysis, and should independently confirm the accuracy of the information contained herein through a due diligence review of the books, records, files and documents that constitute reliable sources of the information described herein. NAI Capital CA BRE #01990696

Joseph Gabbaian
Executive Vice President
310.806.6134
jgabbaian@naicapital.com
Cal DRE Lic #01016301

1500

OLYMPIC BLVD.
SANTA MONICA, CA

CREATIVE OFFICE BUILDING FOR LEASE

IN THE HEART OF SILICON BEACH



NAI Capital
COMMERCIAL REAL ESTATE SERVICES, WORLDWIDE

No warranty, express or implied, is made as to the accuracy of the information contained herein. This information is submitted subject to errors, omissions, change of price, rental or other conditions, withdrawal without notice, and is subject to any special listing conditions imposed by our principals. Cooperating brokers, buyers, tenants and other parties who receive this document should not rely on it, but should use it as a starting point of analysis, and should independently confirm the accuracy of the information contained herein through a due diligence review of the books, records, files and documents that constitute reliable sources of the information described herein. NAI Capital CA BRE #01990696

Joseph Gabbaian
Executive Vice President
310.806.6134
jgabbaian@naicapital.com
Cal DRE Lic #01016301

1500

OLYMPIC BLVD.
SANTA MONICA, CA

CREATIVE OFFICE BUILDING FOR SALE OR LEASE

IN THE HEART OF SILICON BEACH

2nd Floor

