

33,149 SF Warehouse with 2+ Acres of Yard

920 South 500 West, Salt Lake City, Ut



Salt Lake Granary District

BUILDING RATE: \$.75 PSF, NNN
LAND RATE: \$6,900.00 PER ACRE

Property Details

Total Size:	33,149 SF
Office:	5,070 SF
Warehouse:	28,079 SF
Covered Dock Storage:	3,585 SF
Doors:	(1) 17'x10' Dock High (3) 12'x10' Dock High
Ceiling:	14'8" - 16'8" Clear
Zoning:	CG (Commercial General)
Land:	Lot 1: 63,500 SF Lot 2: 35,500 SF

-2+ acres of fully fenced and paved outside storage

- Large gates providing great maneuverability
- Recently updated office space with showroom, 10 private offices, 4 restrooms, break area, and a conference room
- Great location with freeway access less than 1 minute from the site
- Abundant natural light in the warehouse
- Fire Sprinkled
- Ready for Occupancy on 03/01/2025



Bob Mills
385.988.6477
bob@adventut.com

Riley Mills
385.988.6478
riley@adventut.com

Advent Property Advisors: 5284 S. Commerce Drive, #C-274, Murray, Ut

33,149 SF Warehouse with 2+ Acres of Yard

920 South 500 West, Salt Lake City, Ut

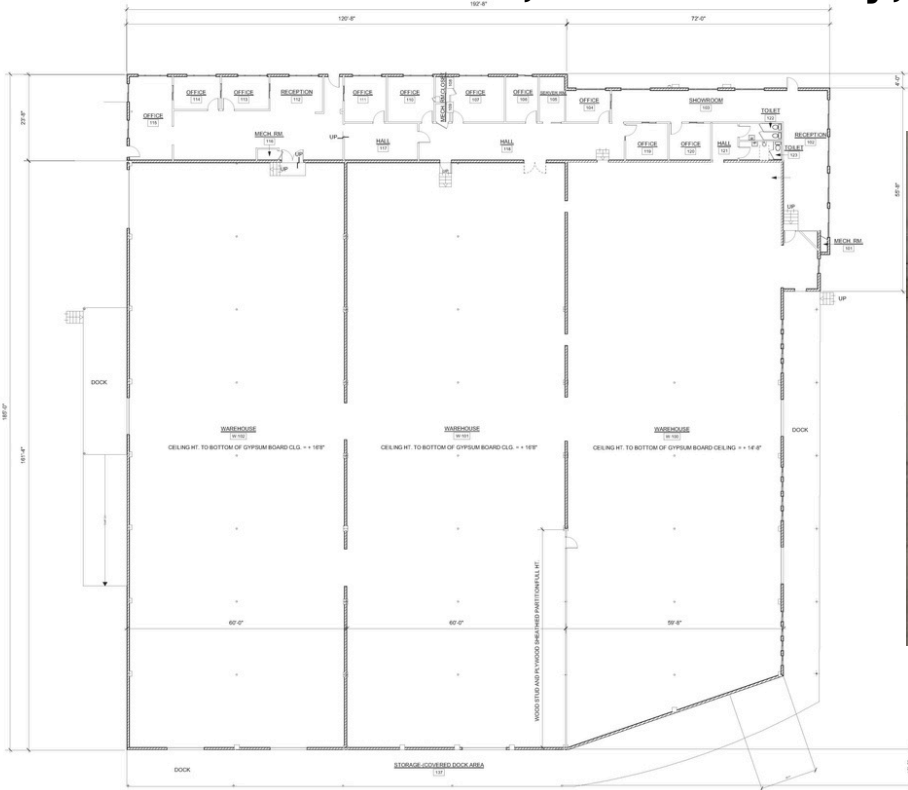

Bob Mills
385.988.6477
bob@adventut.com

Riley Mills
385.988.6478
riley@adventut.com

33,149 SF Warehouse with 2+ Acres of Yard

920 South 500 West, Salt Lake City, Ut

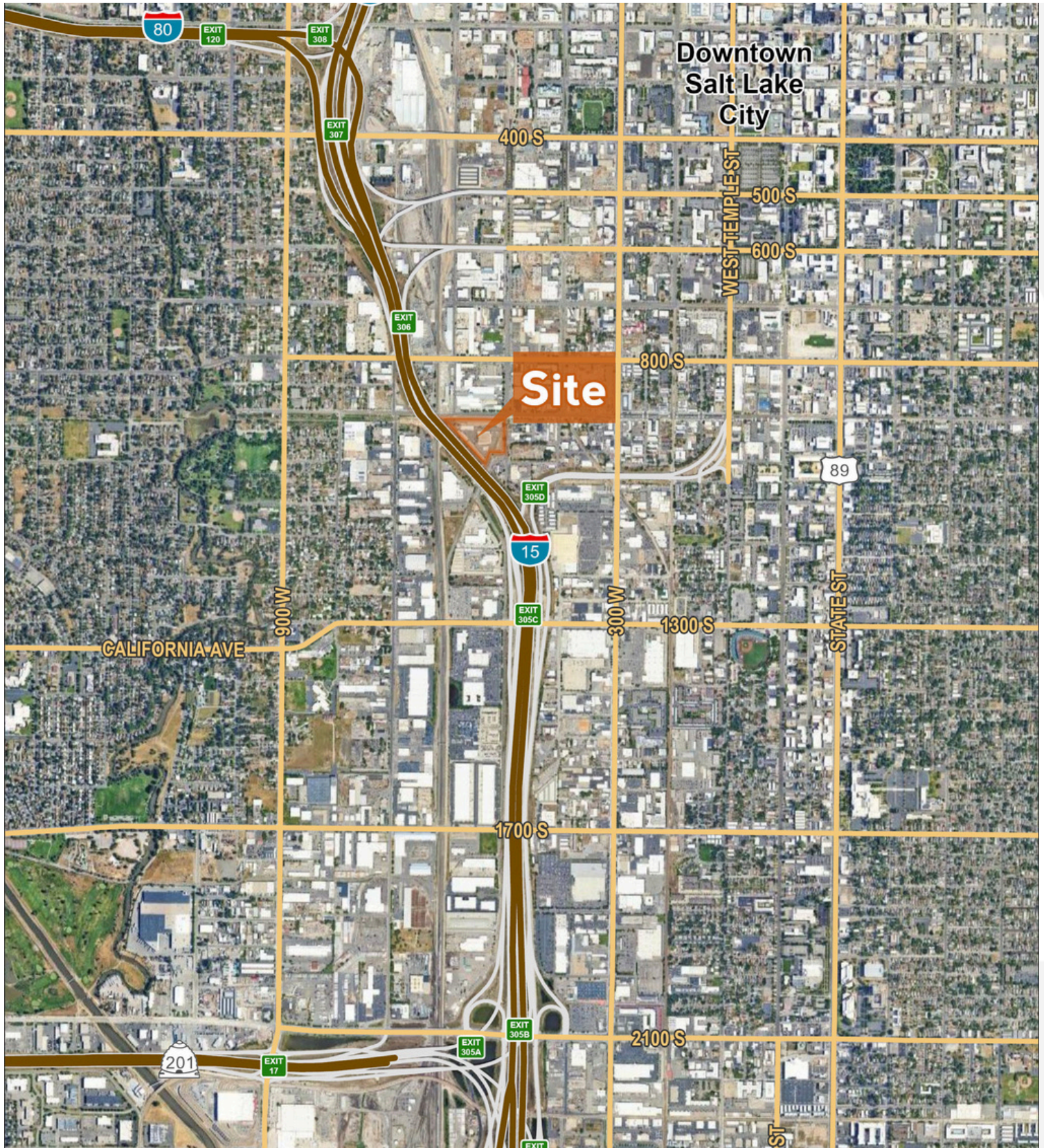

Bob Mills
385.988.6477
bob@adventut.com

Riley Mills
385.988.6478
riley@adventut.com