

FOR LEASE

ASTURIAN CENTER | MEDICAL FACILITY

1665-1675 WEST BROADWAY STREET, OVIEDO, FL 32765



Matt Weinberger

Vice President

Lee & Associates Central Florida

D 321.281.8510

E mweinberger@lee-associates.com

Jason Bantel, CCIM

Senior Vice President | Principal

Lee & Associates Central Florida

D 321.281.8509

E jbantel@lee-associates.com

**CLASS "A" MEDICAL SPACE
FROM 3,050 - 10,386 ± SF AVAILABLE
SIGNALIZED HARD CORNER LOCATION
AVAILABLE FOR IMMEDIATE OCCUPANCY**

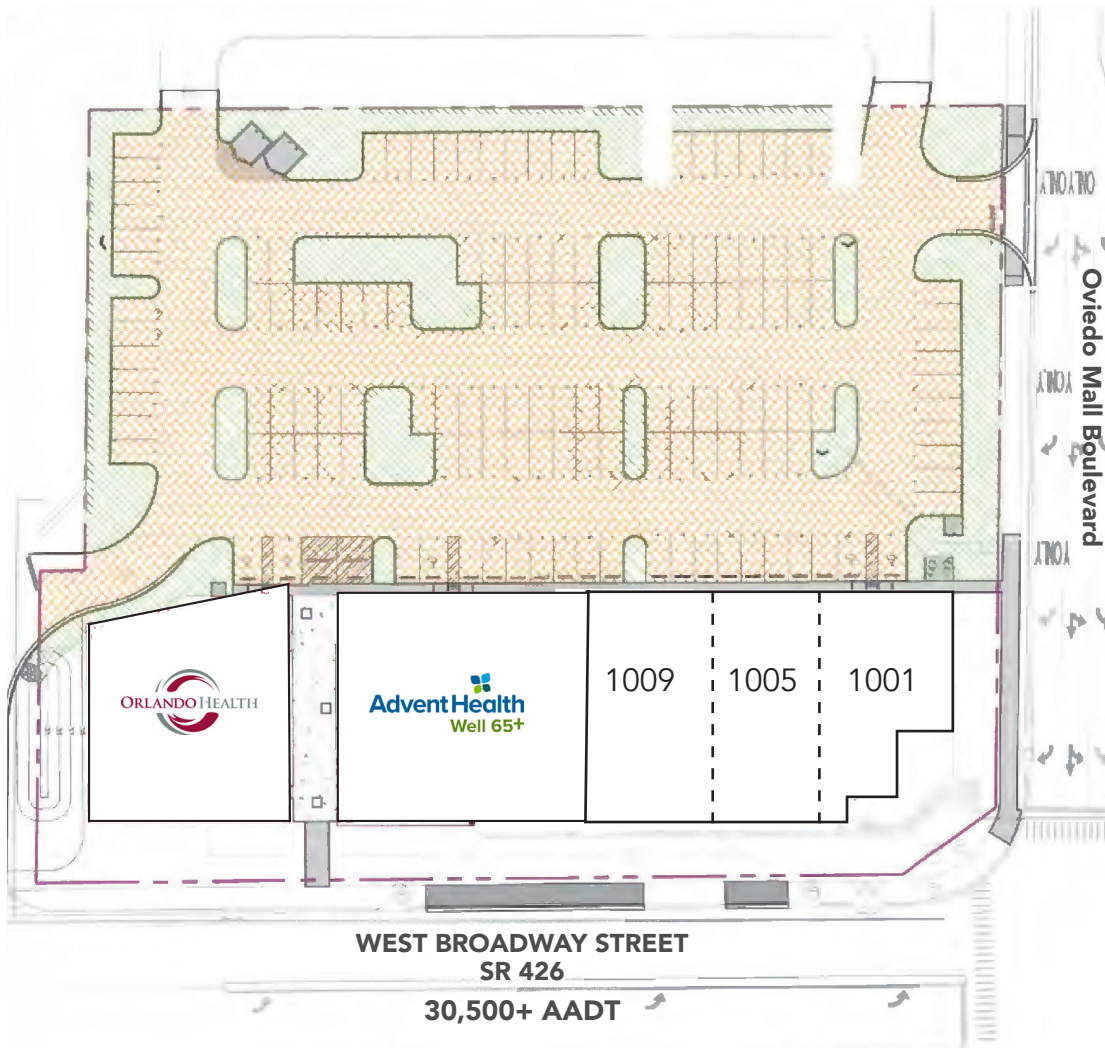

UNIT	TENANT	SF
1001	Available	4,222 SF
1005	Available	3,050 SF
1009	Available	3,114 SF
1025	Well 65+	7,918 SF
1675	Orlando Health	6,500 SF

 **139 PARKING SPACES**
5.23 PER 1,000 SF PARKING RATIO

- From 3,050 sf - 10,386 sf available for lease
- Dense residential trade area - average household income of over \$108,000+ (3-mile radius)
- Located at the signalized hard corner of W. Broadway Street (30,500+ AADT) & Oviedo Mall Blvd.
- Join Orlando Health Imaging Centers & AdventHealth Well65+, which will attract 400+ people per day on site

DEMOGRAPHICS



Population

1 Mile: 3,323
3 Mile: 64,868
5 Mile: 168,955



Daytime Population

1 Mile: 7,632
3 Mile: 54,743
5 Mile: 151,565



Households

1 Mile: 1,189
3 Mile: 21,979
5 Mile: 57,309



Avg Household Income

1 Mile: \$109,231
3 Mile: \$129,263
5 Mile: \$116,758

MEDICAL MAP



RETAIL MAP





For more information, please contact one of the following individuals:

CONTACT

Matt Weinberger

Vice President

Lee & Associates Central Florida

D 321.281.8510

E mweinberger@lee-associates.com

Jason Bantel, CCIM

Senior Vice President

Lee & Associates Central Florida

D 321.281.8509

E jbantel@lee-associates.com