

medical office
for
SUBLEASE

2,244 sf

\$30.00/sf fs

- + sublease expires 8.28.28
- + ample parking

- + **Bulding:** 59,198 sf
- + **Primary:** medical
- + **Parking:** 5.07/1K

828 mercy dr
suites 2 & 3
orlando, fl 32808



buffy gillette
broker associate
(407) 734.7205
buffy@BBDRE.com

Bishop Beale Duncan
COMMERCIAL REAL ESTATE

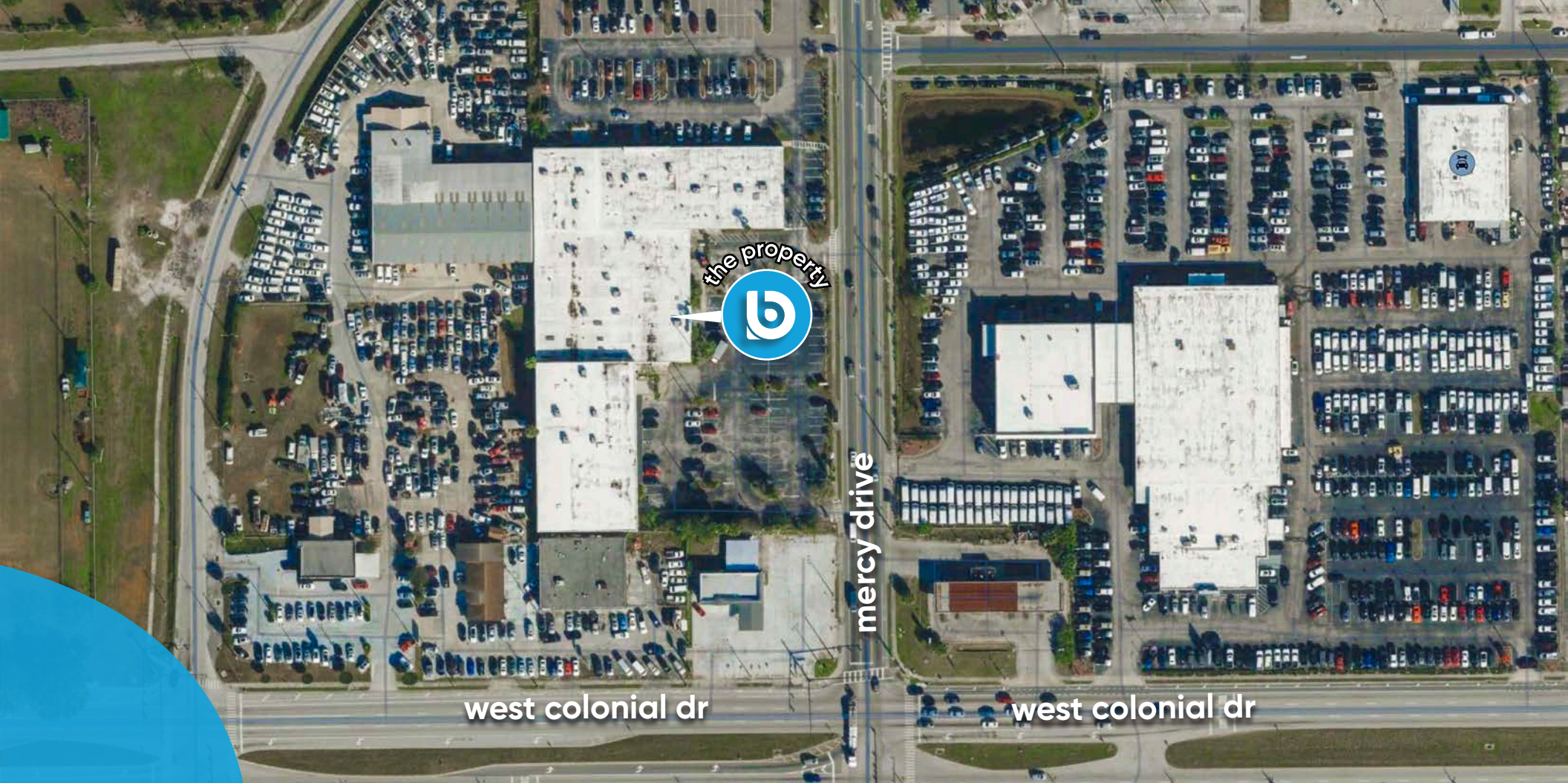

highlights

2nd gen medical space with convenient location and ample parking

- The property is equipped with central security monitoring system inside and outside
- Perimeter and parking lot lighting with security on the walkways
- Sublease expires 8.28.28
- 3 plumbed exam rooms, waiting and reception area. nurses station & work room



250 N. Orange Ave., Ste. 1500
Orlando, FL 32801
+ (407) 426.7702
www.BBDRE.com

This offer is subject to errors, omissions, prior sale or withdrawal without notice.



for more information, contact buffy gillette • (407) 734.7205 • buffy@BBDRE.com

beautiful space recently built-out for medical use



waiting



work room

interiors



reception



exam



for more information, contact buffy gillette • (407) 734.7205 • buffy@BBDRE.com

space layout | 2,244

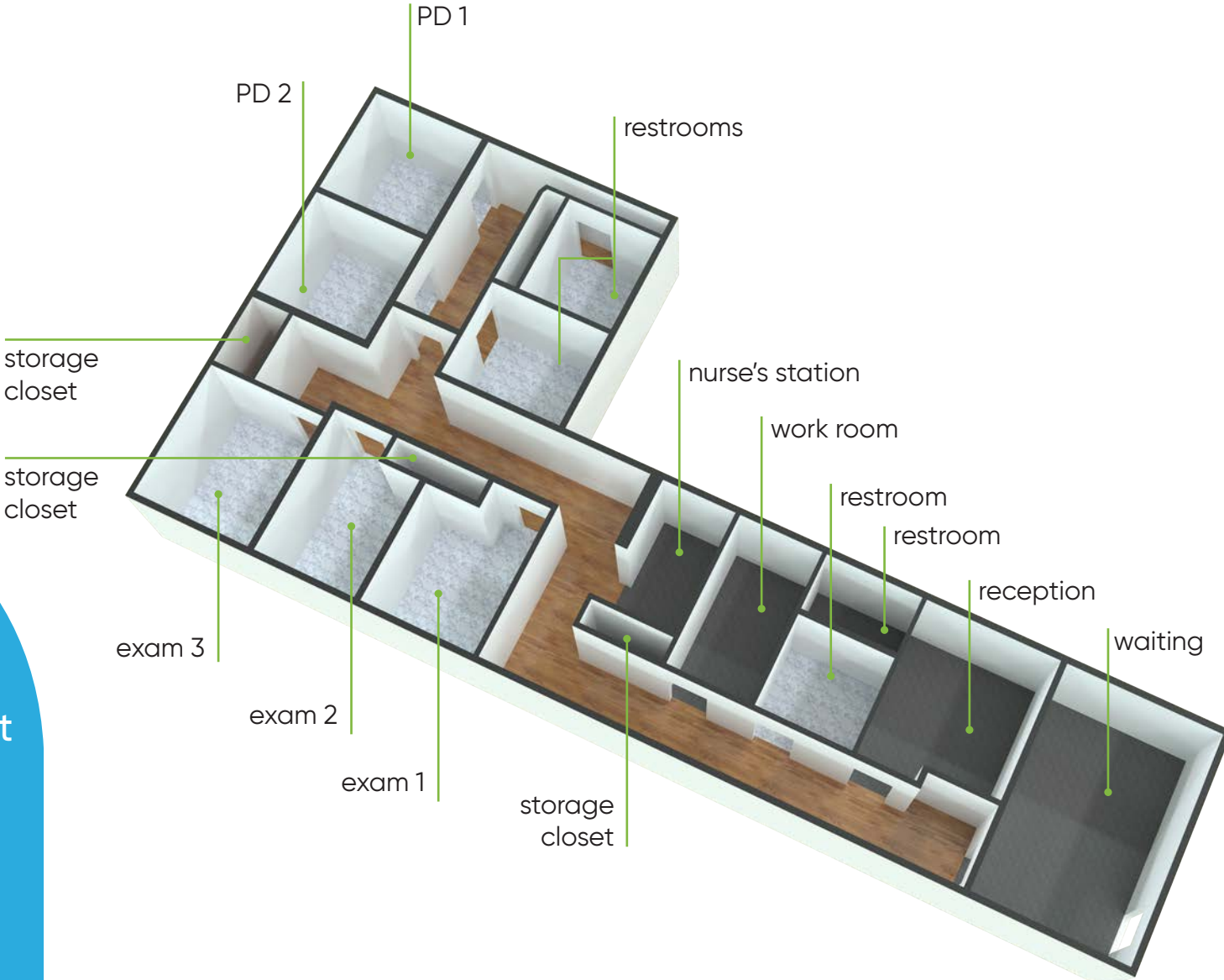

3d layout



floor plan | 2,244 sf

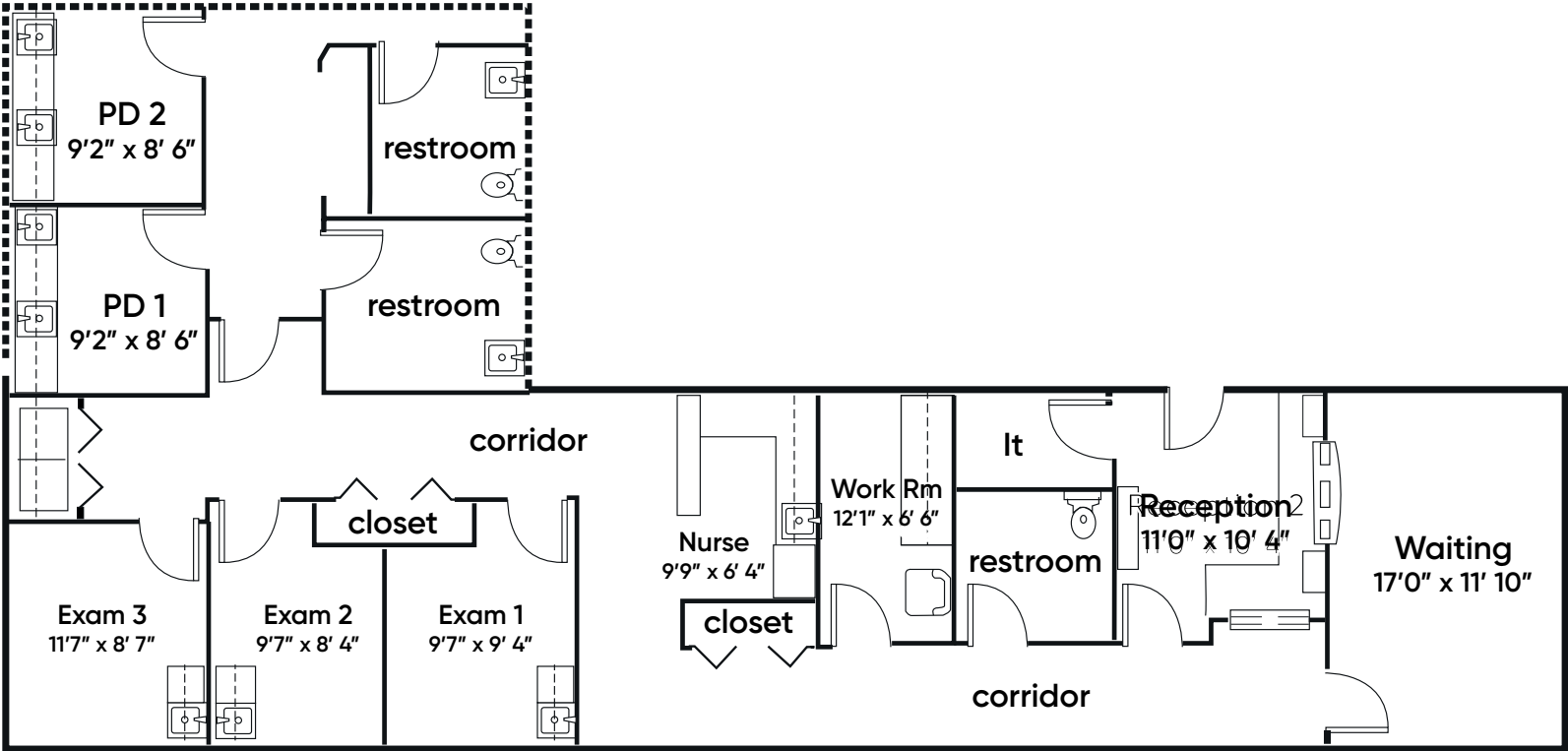

floor plan



location map + demographics

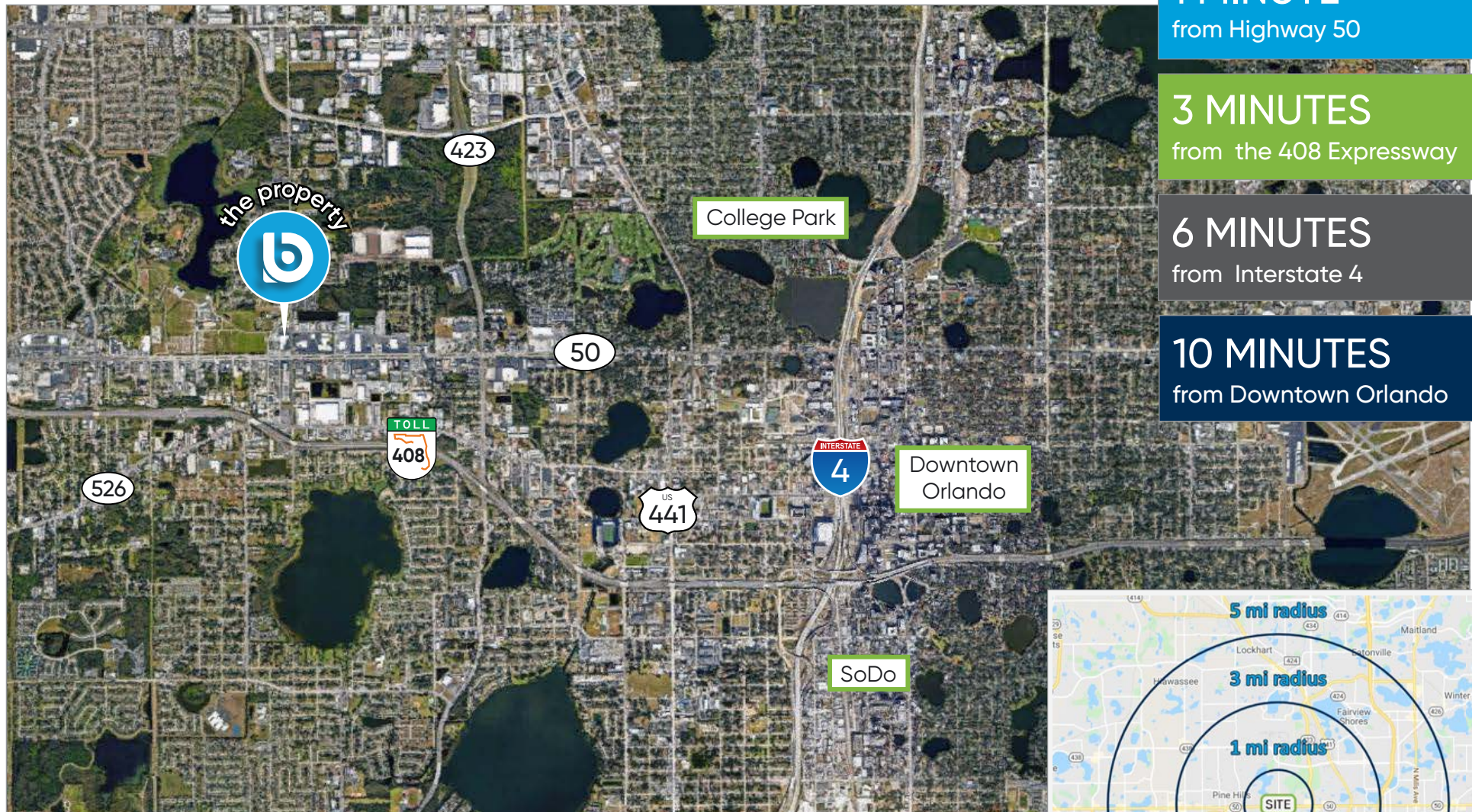

Radius	Population	HH Income	Businesses	Employees
1-Mile	7,146	\$43,393	625	5,278
3-Mile	101,604	\$58,121	5,824	50,844
5-Mile	326,881	\$67,536	24,611	261,708

