





2023 DEMOGRAPHICS
 1 Mile | 3 Miles | 5 Miles



Population
 3,530 | 29,651 | 61,282

Daytime Population
 1,660 | 10,372 | 26,648

Median Household Income
 \$77,570 | \$81,679 | \$85,556

RETAIL FOR LEASE

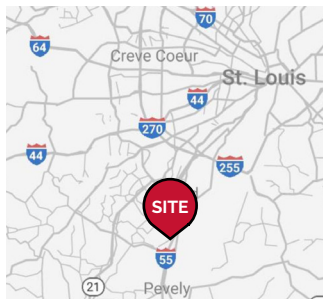
Imperial Grove | 1238-1280 Main Street, Imperial, Missouri 63052
 1,283 SF | \$15.00/SF | Triple Nets: \$6.63/SF
 Land Available: 1.175 AC | \$55,000 - \$60,000/Year



PROPERTY DETAILS

Excellent visibility from I-55 & Imperial Main
 Small shop space and outlots available

I-55 - 90,723 VPD
 Main Street - 6,000 VPD

Ashley Krekovich
 314.785.7613 | akrekovich@paceproperties.com

Kate Grewe
 314.785.7662 | kgrewe@paceproperties.com

Elizabeth Schenk
 314.785.7633 | eschenk@paceproperties.com

Outlot Available

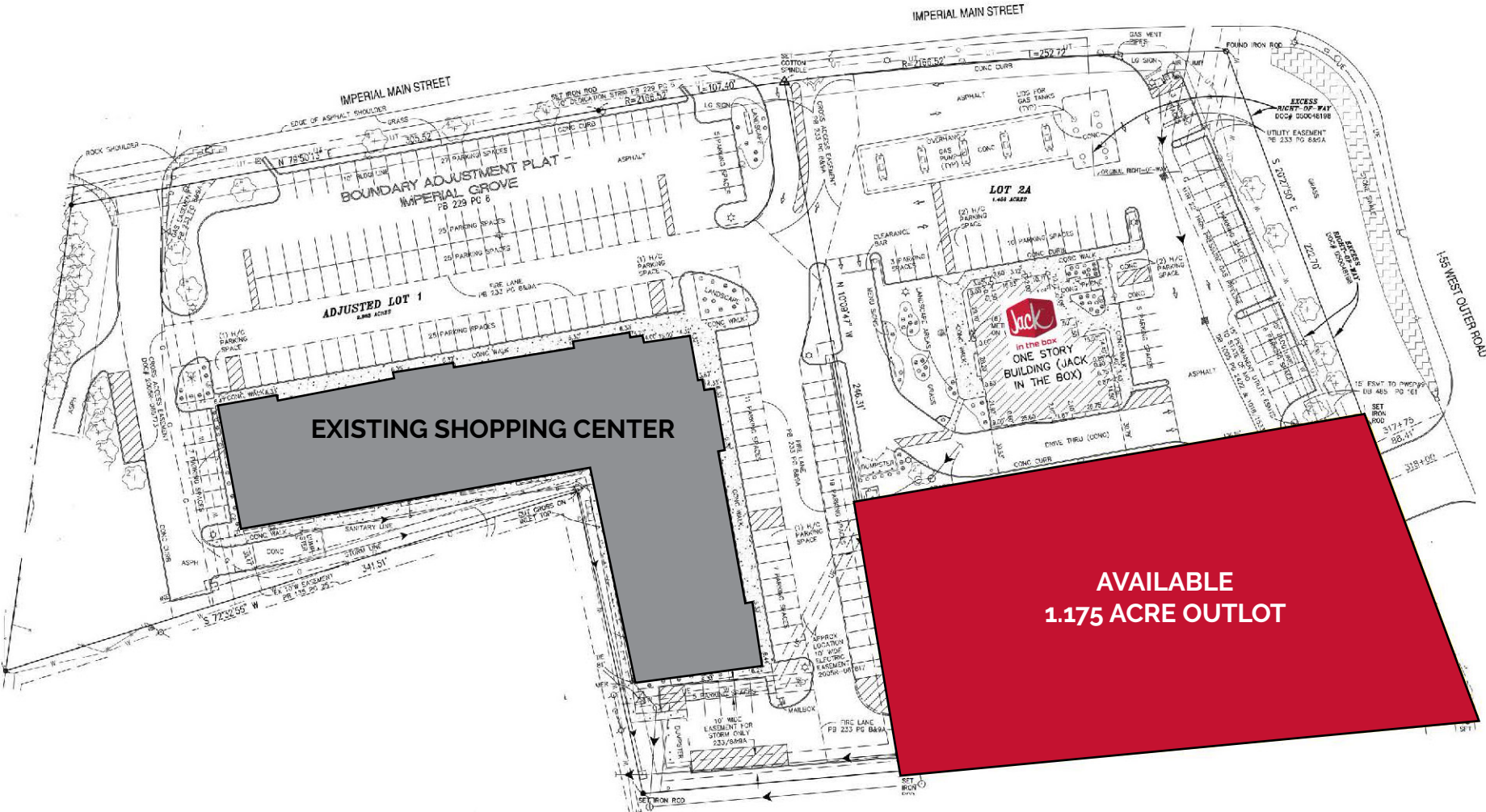

Small Shop Space

Space	Status	SF
1238	License Office	2,468
1242	Realty Executives Mid-America	1,167
1244	AVAILABLE	1,283
1246	510 Vapers Storage	1,540
1248-1250	Mercy Physical Therapy	2,329
1254	Mercy Primary Care	4,311
1258	Elite Collectibles	1,798
1260-1262	510 Vapers	2,379
1264	MK Nails	1,167
1266	Guild Mortgage	2,119
1270	Papa John's	1,615
1272	PrimeTime Sports Bar	1,260
1274-1276	Burgess Orthodontics	2,058
1280	Precision Dental Care	2,697

