

DORCHESTER COMMERCE CENTER



132 & 130 HODGE ROAD, SUMMERVILLE, SC 29483



Building 2: 317,376 SF

Building 1: 216,705 SF

132 Hodge Rd

130 Hodge Rd

AVAILABLE IMMEDIATELY

FOR MORE INFORMATION:

PETER FENNELLY, SIOR, MCR, SLCR
+1 843 425 0186
peter.fennelly@bridge-commercial.com

SIMONS JOHNSON, SIOR, MCR, CCIM
+1 843 557 4047
simons.johnson@bridge-commercial.com

WILL CROWELL, SIOR
+1 504 975 1099
will.crowell@bridge-commercial.com

DORCHESTER COMMERCE CENTER

132 & 130 HODGE ROAD, SUMMERVILLE, SC 29483



EXIT 194

Jedburg Rd

Hodge Rd

BUILDING 1 | 216,705 SF
132 HODGE RD, SUMMERVILLE SC

BUILDING 2 | 317,376 SF
130 HODGE RD, SUMMERVILLE SC

DORCHESTER COMMERCE CENTER LOCATION

132 & 130 HODGE ROAD, SUMMERVILLE, SC 29483



EXIT 194



EXIT 197

2 MILES TO I-26



DORCHESTER COMMERCE CENTER
Available Immediately

Bridge Commercial makes no guarantees, representations or warranties of any kind, expressed or implied, regarding the information including, but not limited to, warranties of content, accuracy and reliability. This publication is the copyrighted property of Bridge Commercial and/or its licensor(s). ©2023. All rights reserved.

BUILDING 1

- ADDRESS 132 Hodge Road, Summerville, SC
- AVAILABLE SF 216,705 SF
- SPEC OFFICE ±1,800 SF (Each End)
- BUILDING DIMENSIONS 260' x 832'
- INTERIOR BAYS 52' x 50'
- LOADING BAYS 52' x 56'
- INTERIOR BAY SIZE ±13,520
- DRIVE-IN DOORS (2) 14' X 16'
- DOCK DOORS (44) 9' x 10'
- BUILDING CLEAR HEIGHT 32'
- SPRINKLER ESFR
- AUTO PARKING 226 Spaces
- SLAB 6" Unreinforced
- LIGHTING LED
- CONSTRUCTION Tilt-Up Concrete
- POWER 2000AMP, 277/480v, 3Phase

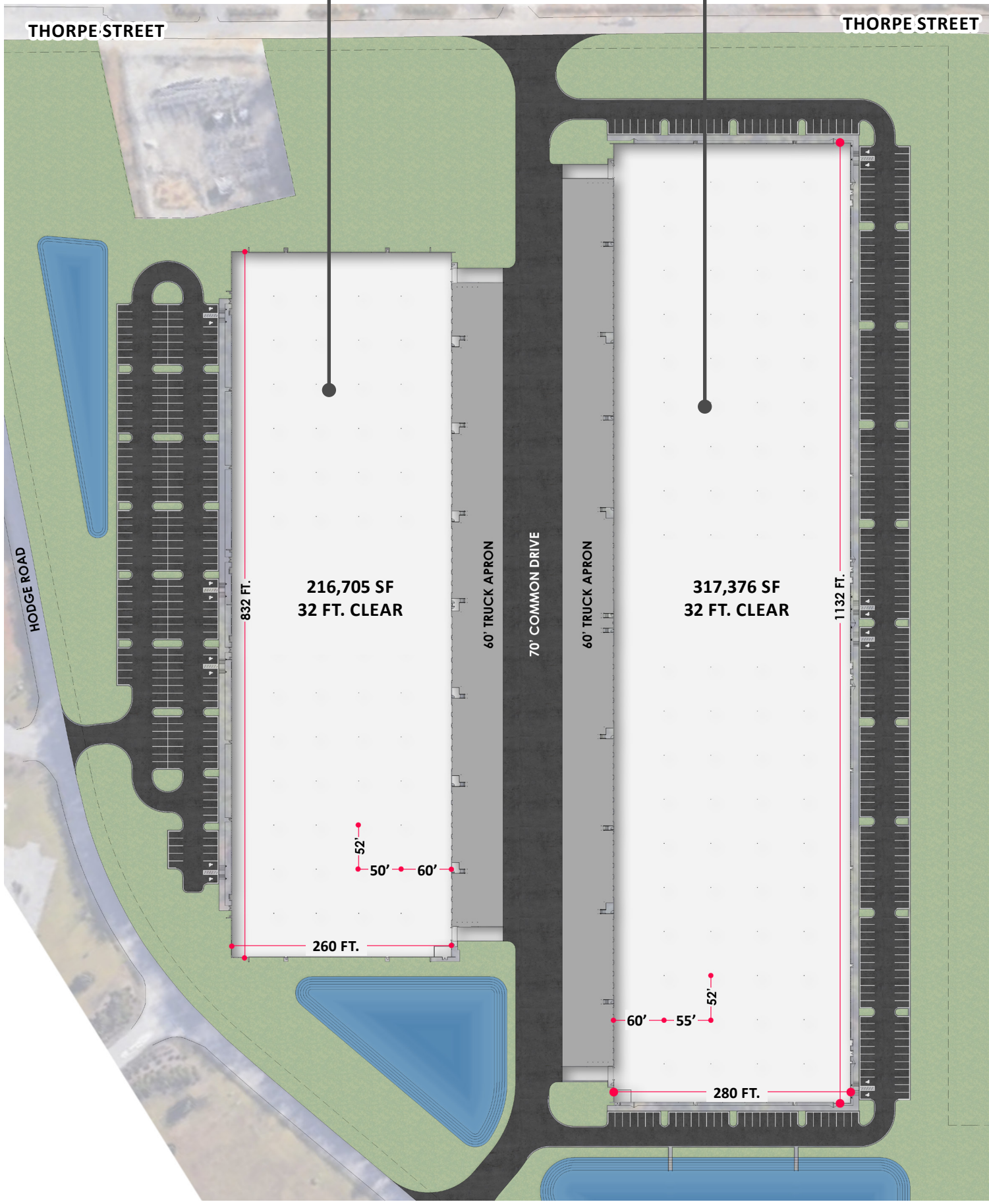

BUILDING 2

- ADDRESS 130 Hodge Road, Summerville, SC
- AVAILABLE SF 317,376 SF
- SPEC OFFICE ±1,800 (Each End)
- BUILDING DIMENSIONS 280' x 1,132'
- INTERIOR BAYS 52' x 55'
- LOADING BAYS 52' x 60'
- INTERIOR BAY SIZE ±14,560
- DRIVE-IN DOORS (2) 14' X 16'
- DOCK DOORS (64) 9' x 10'
- BUILDING CLEAR HEIGHT 32'
- SPRINKLER ESFR
- AUTO PARKING 288 Spaces
- SLAB 6" Unreinforced
- LIGHTING LED
- CONSTRUCTION Tilt-Up Concrete
- POWER 2000AMP, 277/480v, 3Phase

Bridge Commercial makes no guarantees, representations or warranties of any kind, expressed or implied, including warranties of content, accuracy and reliability. Any interested party should do their own research as to the accuracy of the information. Bridge Commercial excludes warranties arising out of this document and excludes all liability for loss and damages arising out of this document.

SPEC OFFICE PLAN

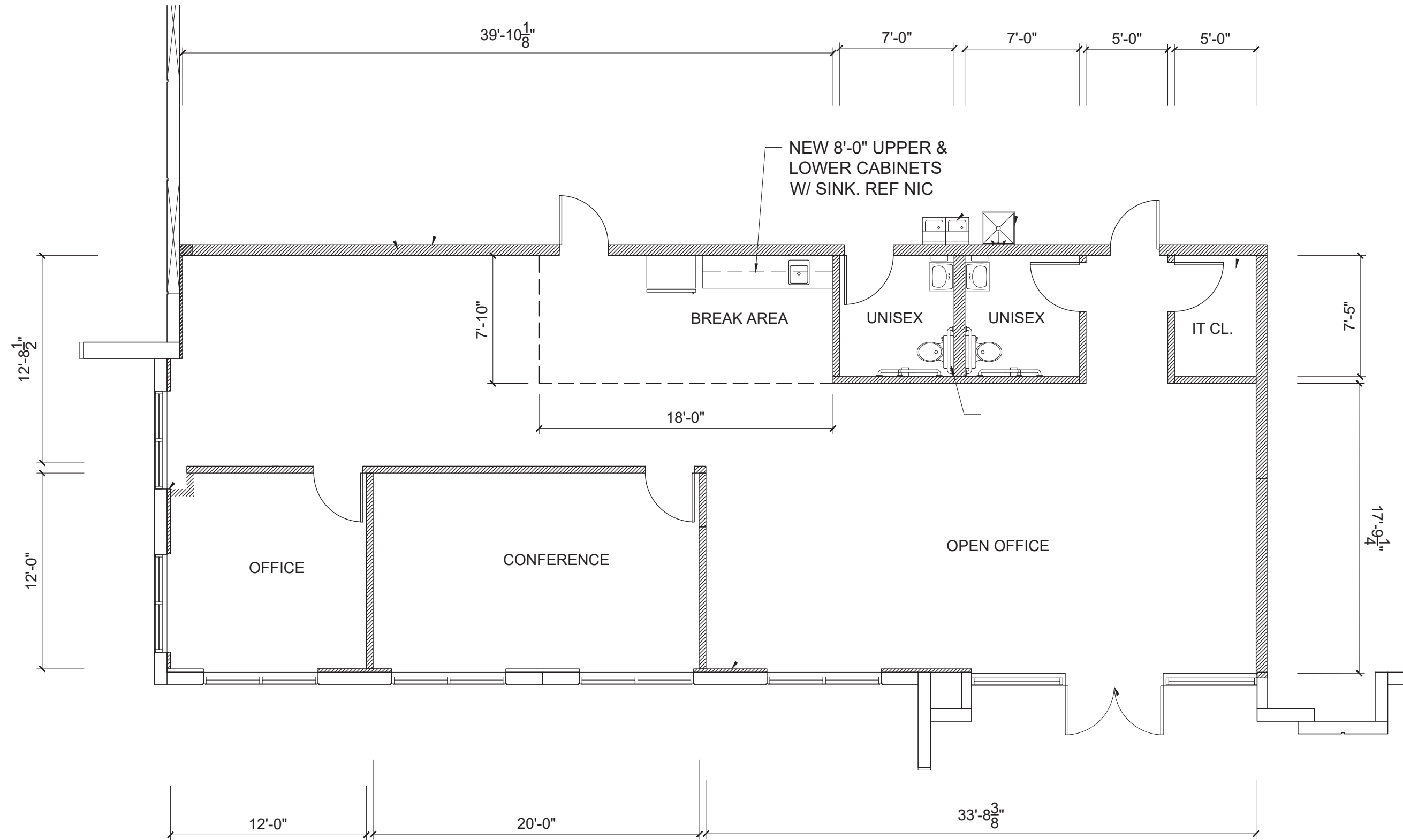



DORCHESTER COMMERCE CENTER
Available Immediately

CENTRALLY LOCATED

	MILES	MINUTES*
I-26	2	3
I-526	20	20
I-95	27.9	25
N. CHARLESTON TERMINAL	23.7	25
CHS INTERNATIONAL AIRPORT	23.2	26
HUGH K. LEATHERMAN, SR. TERMINAL	26.6	27
WANDO WELCH TERMINAL	32.2	35
NAVAL INFORMATION WARFARE CENTER	24	12.6

*Google Maps drive time during business hours



CHARLESTON PORT TERMINALS



Bridge Commercial makes no guarantees, representations or warranties of any kind, expressed or implied, including warranties of content, accuracy and reliability. Any interested party should do their own research as to the accuracy of the information. Bridge Commercial excludes warranties arising out of this document and excludes all liability for loss and damages arising out of this document.

DORCHESTER COMMERCE CENTER

132 & 130 HODGE ROAD, SUMMERVILLE, SC 29483



DEVELOPED BY:



MARKETED BY:



FOR MORE INFORMATION

PETER FENNELLY, SIOR, MCR, SLCR
+1 843 425 0186
peter.fennelly@bridge-commercial.com

SIMONS JOHNSON, SIOR, MCR, CCIM
+1 843 557 4047
simons.johnson@bridge-commercial.com

WILL CROWELL, SIOR
+1 504 975 1099
will.crowell@bridge-commercial.com

Bridge Commercial makes no guarantees, representations or warranties of any kind, expressed or implied, including warranties of content, accuracy and reliability. Any interested party should do their own research as to the accuracy of the information. Bridge Commercial excludes warranties arising out of this document and excludes all liability for loss and damages arising out of this document.