

**MOVE-IN SPECIAL
FIRST 2 MONTHS FREE!**
*AS-IS LAYOUTS AND TERMS 3 YEARS OR MORE.

2290
N FIRST ST

SAN JOSE, CA



OFFICE FOR LEASE
8 Flexible Size Configurations ±1,050 SF - 9,208 SF

NEWMARK

Gabe Regalado
408.455.4913
gabe.regalado@nrmk.com
CA RE LIC. #02008286

Luke Allard
408.982.8492
luke.allard@nrmk.com
CA RE LIC. #01910058



Roger Fields
650.207.1610
Peninsula Land
and Capital

MARKET READY STANDARD SUITE



2290
N FIRST ST



NEWMARK



2290 N FIRST STREET, SAN JOSE | 2

CURRENT AVAILABILITY

Suite 102	±9,208 SF	Building Signage
Suite 202B	±2,039 SF	
Suite 202C	±2,099 SF	
Suite 209	±1,050 SF	
Suite 208	±3,696 SF	Can be combined to ±6,036 SF
Suite 204	±2,340 SF	
Suite 300	±3,008 SF	LEASED



2290
N FIRST ST



PROPERTY HIGHLIGHTS



Prominent Corner
Location in North
San Jose



Abundant
Amenities within
Walking Distance



±3.8/1,000
Parking



Immediate Access to
Highways 101, 87 &
San Jose Airport



VTA Light Rail Station
Immediately in Front of
the Building



AT&T Fiber Lit
Sean Mendez
sm503w@att.com | 925.487.2127
Comcast Fiber Lit
Scott Yee
Scott_Yee@comcast.com | 925.967.1260

FLOOR PLAN 1ST FLOOR

SUITE 102: ±9,208 SF (HYPOTHETICAL LAYOUT)

2290
N FIRST ST

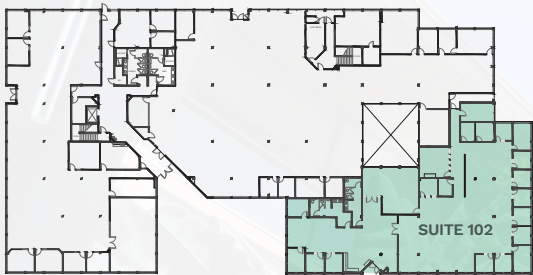

FEATURES

- 8 PRIVATE OFFICES
- 1 CONFERENCE ROOMS
- IT/SERVER ROOM
- BUILDING SIGNAGE
- Dry Lab
- ATRIUM VIEW
- BREAK ROOM
- ALL HANDS ROOM
- COPY/SUPPLY ROOM
- AMPLE WINDOW LINE
- PRIVATE RESTROOMS
- ±250 AMPS POWER
- HYPOTHETICAL LAYOUT

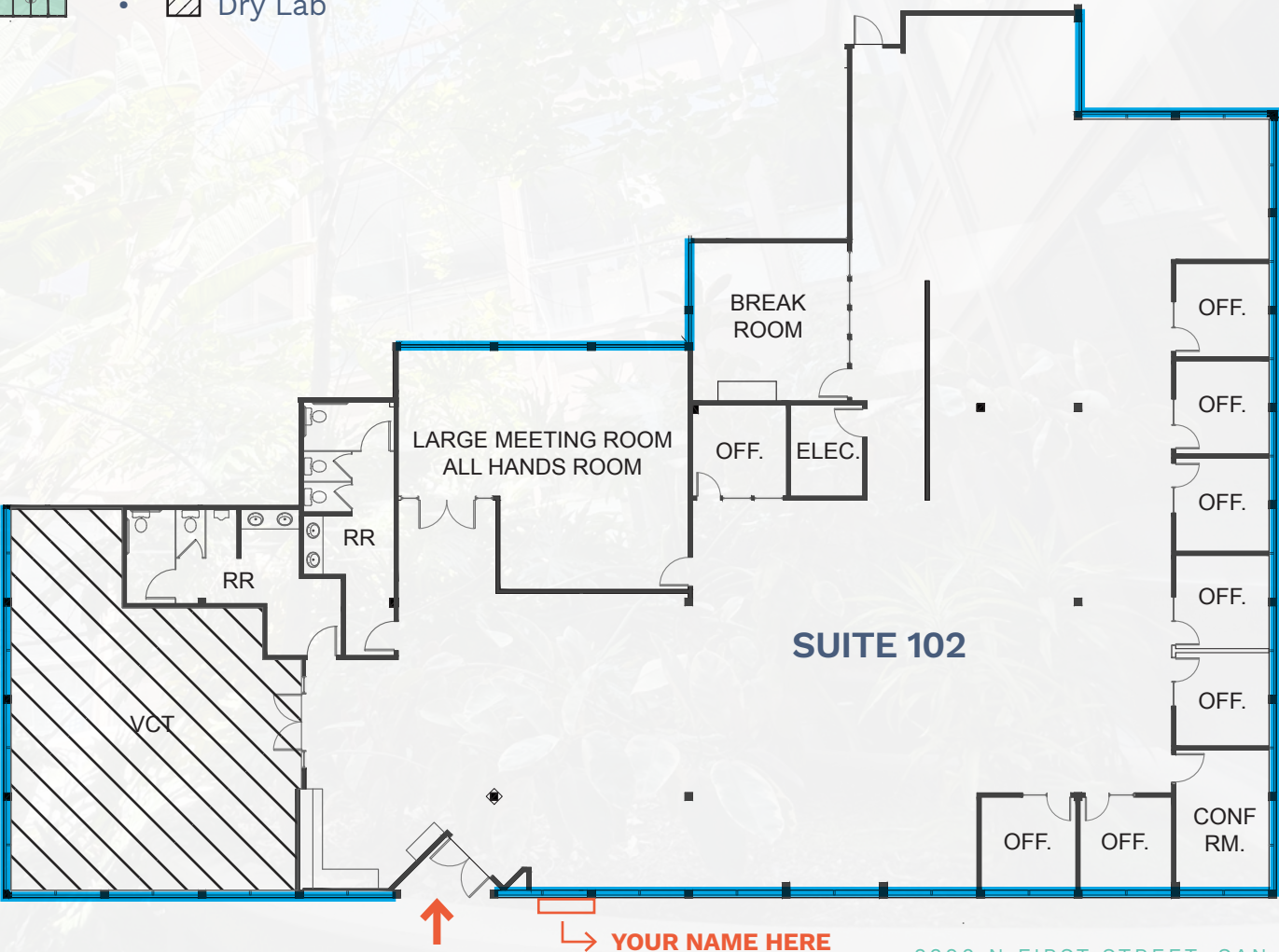

FLOOR PLAN 1ST FLOOR

SUITE 102: ±9,208 SF (CURRENT LAYOUT)

2290
N FIRST ST



FEATURES

- 13 PRIVATE OFFICES
- 4 CONFERENCE ROOMS
- IT/SERVER ROOM
- BUILDING SIGNAGE
- ATRIUM VIEW
- BREAK ROOM
- ALL HANDS ROOM
- COPY/SUPPLY ROOM
- AMPLE WINDOW LINE
- PRIVATE RESTROOMS
- 250 AMPS POWER
- HYPOTHETICAL LAYOUT

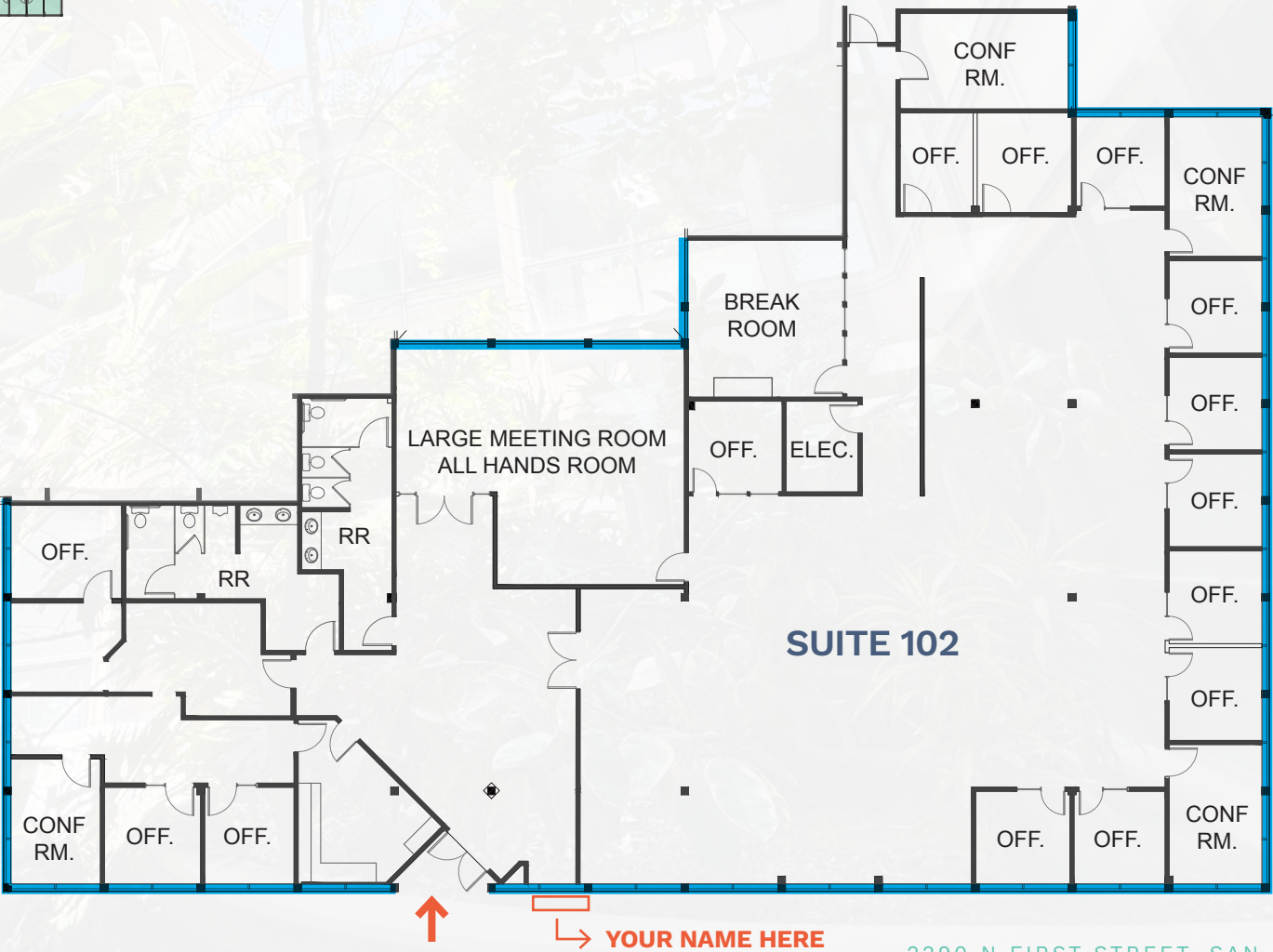

FLOOR PLAN 2ND FLOOR

SUITE 202B: ±2,039 SF

2290
N FIRST ST

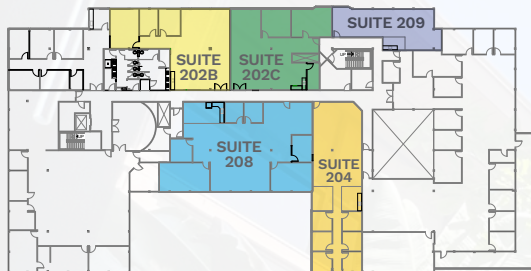

FEATURES

- 2 PRIVATE OFFICES
- 1 CONFERENCE ROOM
- OPEN KITCHEN
- REMAINDER OPEN OFFICE
- AMPLE WINDOW LINE



FLOOR PLAN 2ND FLOOR

SUITE 202C: ±2,099 SF

2290
N FIRST ST

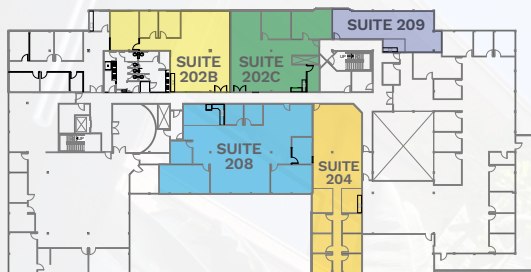

FEATURES

- 1 PRIVATE OFFICE
- 1 CONFERENCE ROOM
- OPEN KITCHEN
- REMAINDER OPEN OFFICE
- AMPLE WINDOW LINE

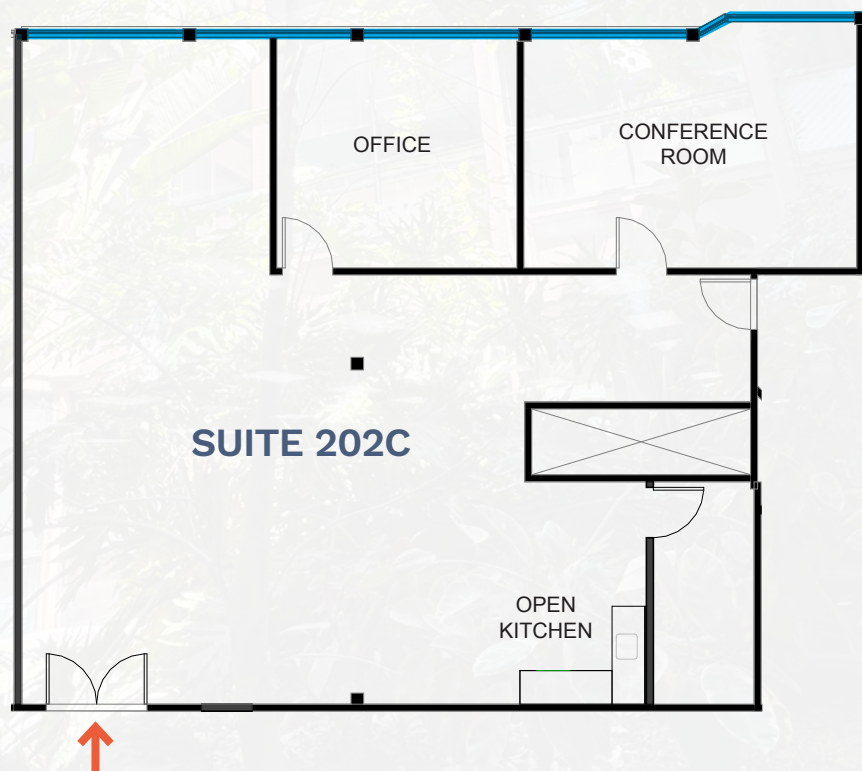

FLOOR PLAN 2ND FLOOR

SUITE 209: ±1,050 SF

2290
N FIRST ST

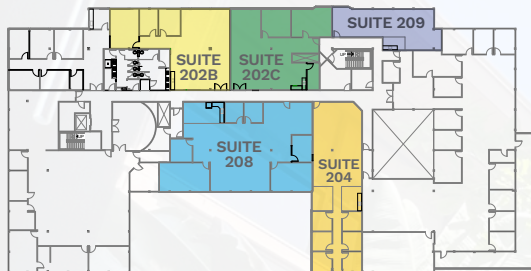

FEATURES

- BREAK AREA
- REMAINDER OPEN OFFICE
- AMPLE WINDOW LINE

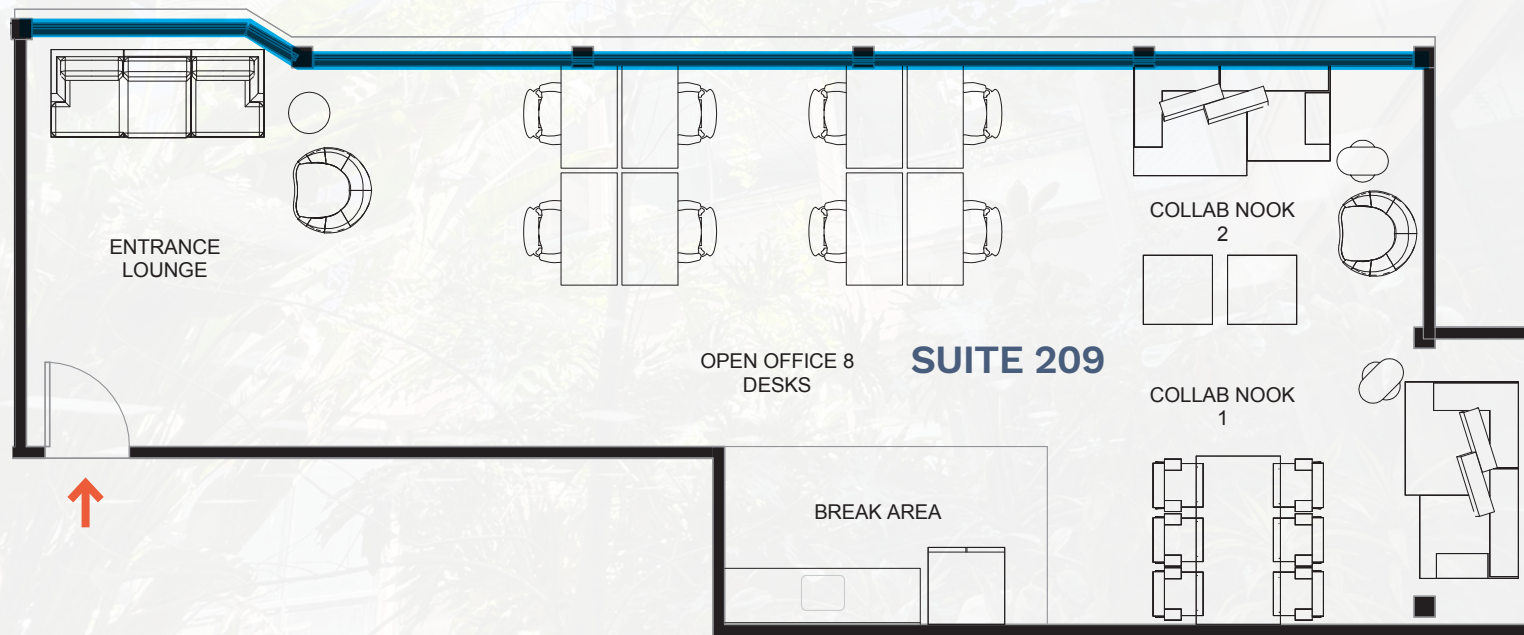

FLOOR PLAN 2ND FLOOR

SUITE 204: ±2,340 SF*

2290
N FIRST ST

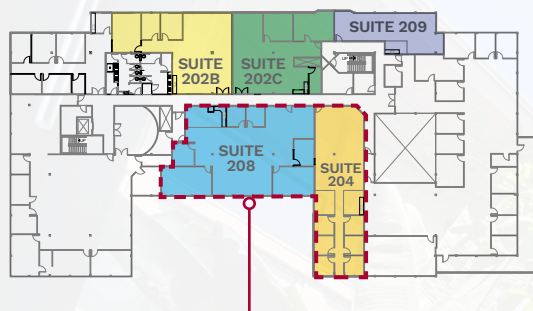

*Can be combined with
Suite 208 to accommodate
±6,036 SF

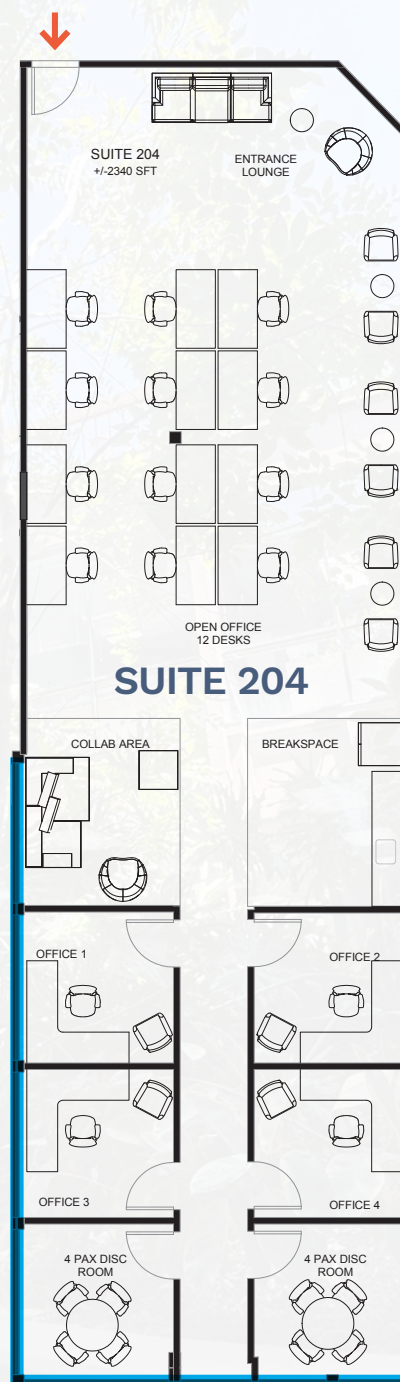

FEATURES

- 4 PRIVATE OFFICES
- 2 SMALL CONFERENCE ROOMS
- BREAK AREA
- REMAINDER OPEN OFFICE
- WINDOW LINE

FLOOR PLAN 2ND FLOOR

SUITE 208: ±3,696 SF*

2290
N FIRST ST

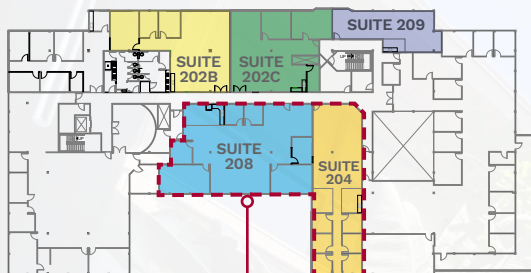

*Can be combined with
Suite 204 to accommodate
±6,036 SF

FEATURES

- 2 PRIVATE OFFICES
- 2 CONFERENCE ROOMS
- 2 HUDDLE ROOMS
- BREAK AREA
- REMAINDER OPEN OFFICE
- AMPLE WINDOW LINE

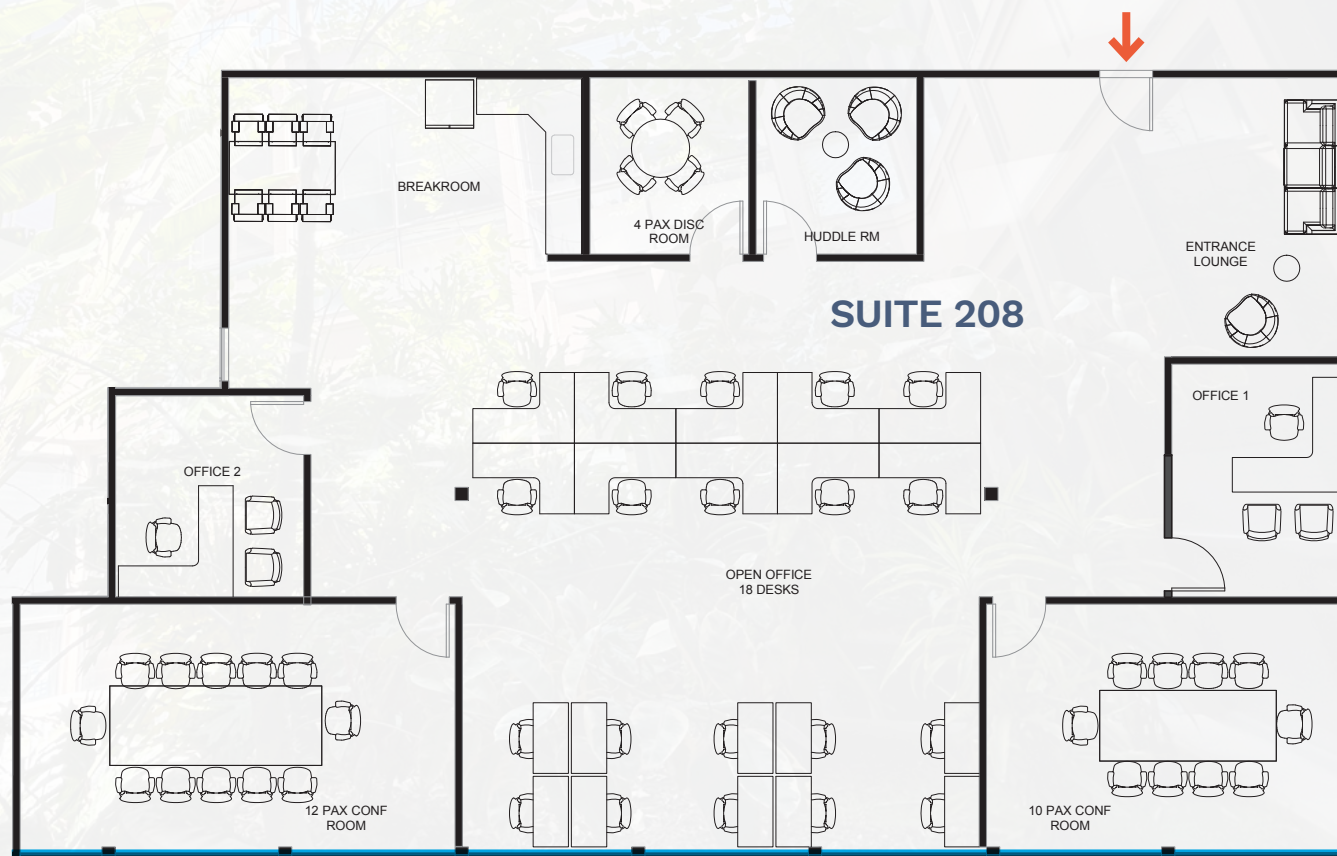

FLOOR PLAN 2ND FLOOR

SUITE 204 & 208: ±6,036 SF

2290
N FIRST ST

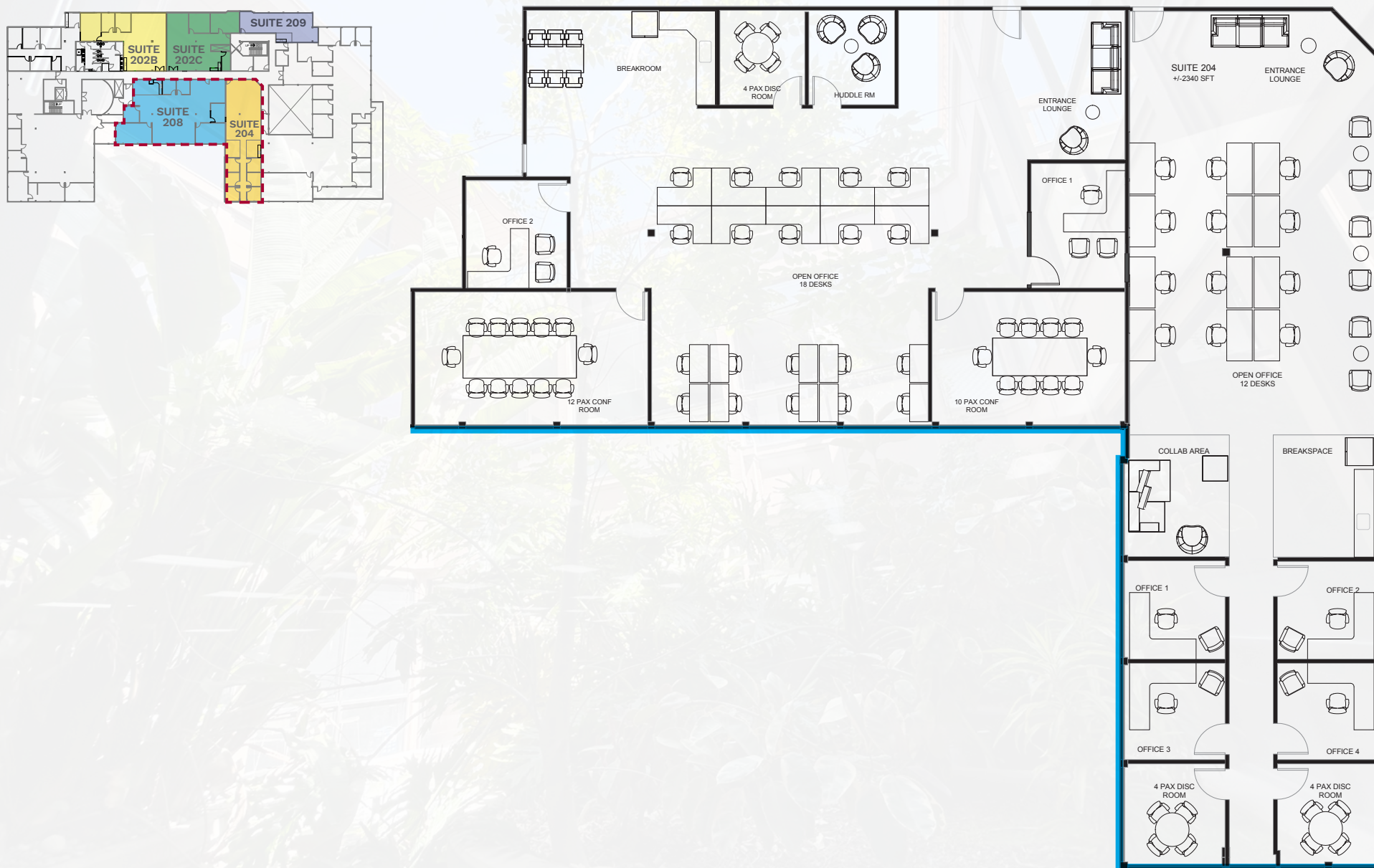

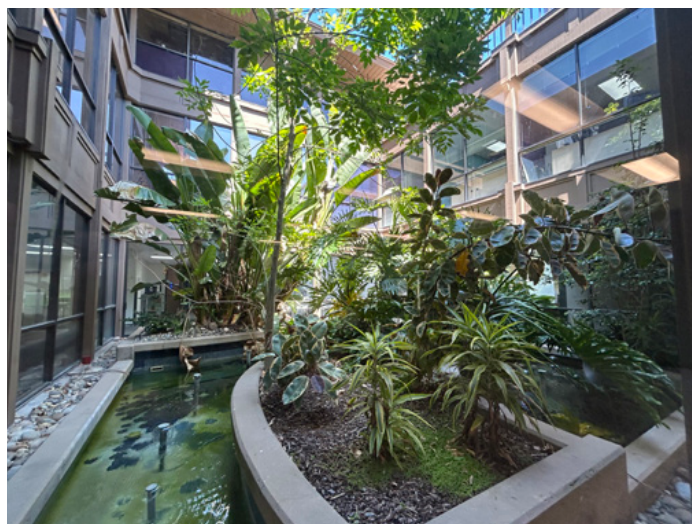

2290
N FIRST ST

NEARBY TRANSIT NETWORK

2290
N FIRST ST



NEARBY AMENITIES

2290
N FIRST ST





2290 N FIRST ST

SAN JOSE, CA

3055 Olin Avenue, Suite 2200, San Jose, CA 95128 | The distributor of this communication is performing acts for which a real estate license is required. The information contained herein has been obtained from sources deemed reliable but has not been verified and no guarantee, warranty or representation, either express or implied, is made with respect to such information. Terms of sale or lease and availability are subject to change or withdrawal without notice. 9975245513 | 10/25

NEWMARK

Gabe Regalado

408.455.4913

gabe.regalado@nmrk.com

CA RE LIC. #02008286

Luke Allard

408.982.8492

luke.allard@nmrk.com

CA RE LIC. #01910058



Roger Fields

650.207.1610

Peninsula Land
and Capital