

FOR LEASE

Free Standing Commercial-Industrial
Building

**George
Thomas Co.**

Commercial • Industrial • Investment Properties

3227 E Woodrow Street, Tulsa, OK 74110



***3,540 SF Free Standing Commercial-Industrial Building with a fenced yard**

***The building includes approx. 500 SF of office space, Two (2) Restrooms**

***Four (4) 10 X 10 overhead doors at grade level**

***Ceiling height is +/-11 feet of clearance**

*** Zoned CS.(Commercial Shopping)**

***Land size +/-9,020 SF.**

For additional information contact:

George Thomas, CCIM

918-697-4400

gt@georgethomasco.com

Susana Hernandez

918-938-8847

Susana@susysokrealty.com

All statements herein are for information purposes only and are believed to be reliable. However, no warranty or representation is made as to the accuracy thereof, and the same is submitted subject to errors, omissions, changes of price, terms, conditions, or prior sale.

FOR LEASE

Free Standing Commercial-Industrial
Building

**George
Thomas Co.** 

Commercial Industrial Investment Properties

**3227 E Woodrow Street,
Tulsa, OK 74110**

Floor Plan

Location Map

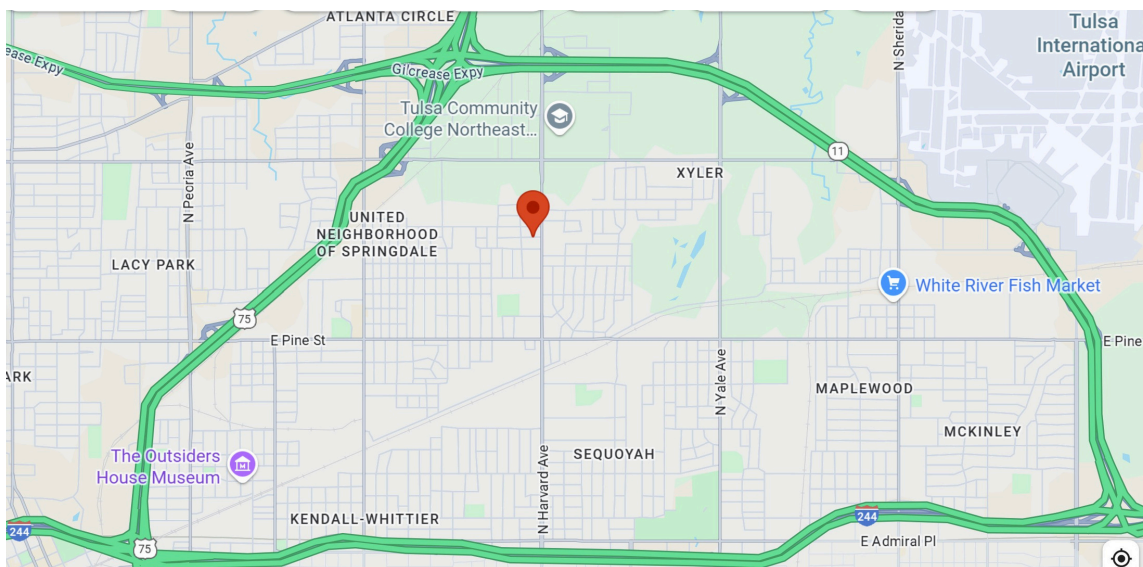

FLOOR PLAN CREATED BY CUBICASA APP. MEASUREMENTS DEEMED HIGHLY RELIABLE BUT NOT GUARANTEED

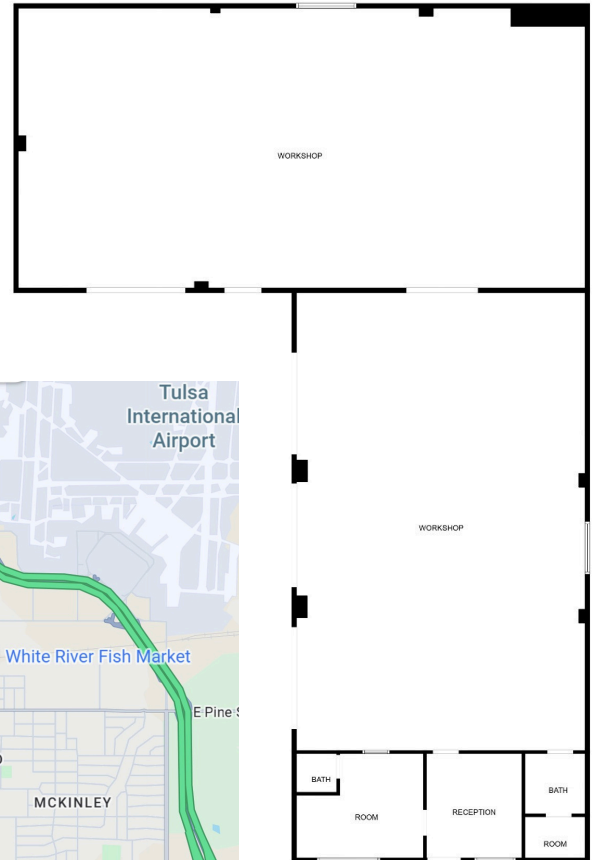

For additional information contact:

George Thomas, CCIM

918-697-4400

gt@georgethomasco.com

Susana Hernandez

918-938-8847

Susana@susysokrealty.com

All statements herein are for information purposes only and are believed to be reliable. However, no warranty or representation is made as to the accuracy thereof, and the same is submitted subject to errors, omissions, changes of price, terms, conditions, or prior sale.