

105

# ZICHA ROAD

SCHOHARIE | NEW YORK



CONCEPTUAL RENDERING



**INDUSTRIAL LAND FOR SALE OPPORTUNITY  
FULLY ENTITLED-APPROVED**

# 105

# ZICHA ROAD

SCHOHARIE | NEW YORK

## FULLY-ENTITLED INDUSTRIAL LAND FOR SALE



**\$1.6M** has been invested in the site  
**Breakdown of cost is available upon request**  
**Fully custom-built warehouse option available**

### \$1,999,000 - LAND ONLY

**PLEASE INQUIRE ABOUT  
A FULLY BUILT WAREHOUSE**

#### PROPERTY INFORMATION:

Address	105 Zicha Road Schoharie, NY 12157
Property Type	Industrial Land
Lot Size	10 Acres
Entitled SF	40,000 SF
Zoning	Commercial / Industrial

#### HIGHLIGHTS:

- Entitled-Approved Land - 40,000 SF
- Ownership has a total of 117 Acres  
Additional land available for purchase  
\$25,000 per acre, please inquire
- IOS Truck parking approved
- Conveniently located directly off I-88
- 18 miles away from I-90
- 36 miles (35 min) to Albany NY

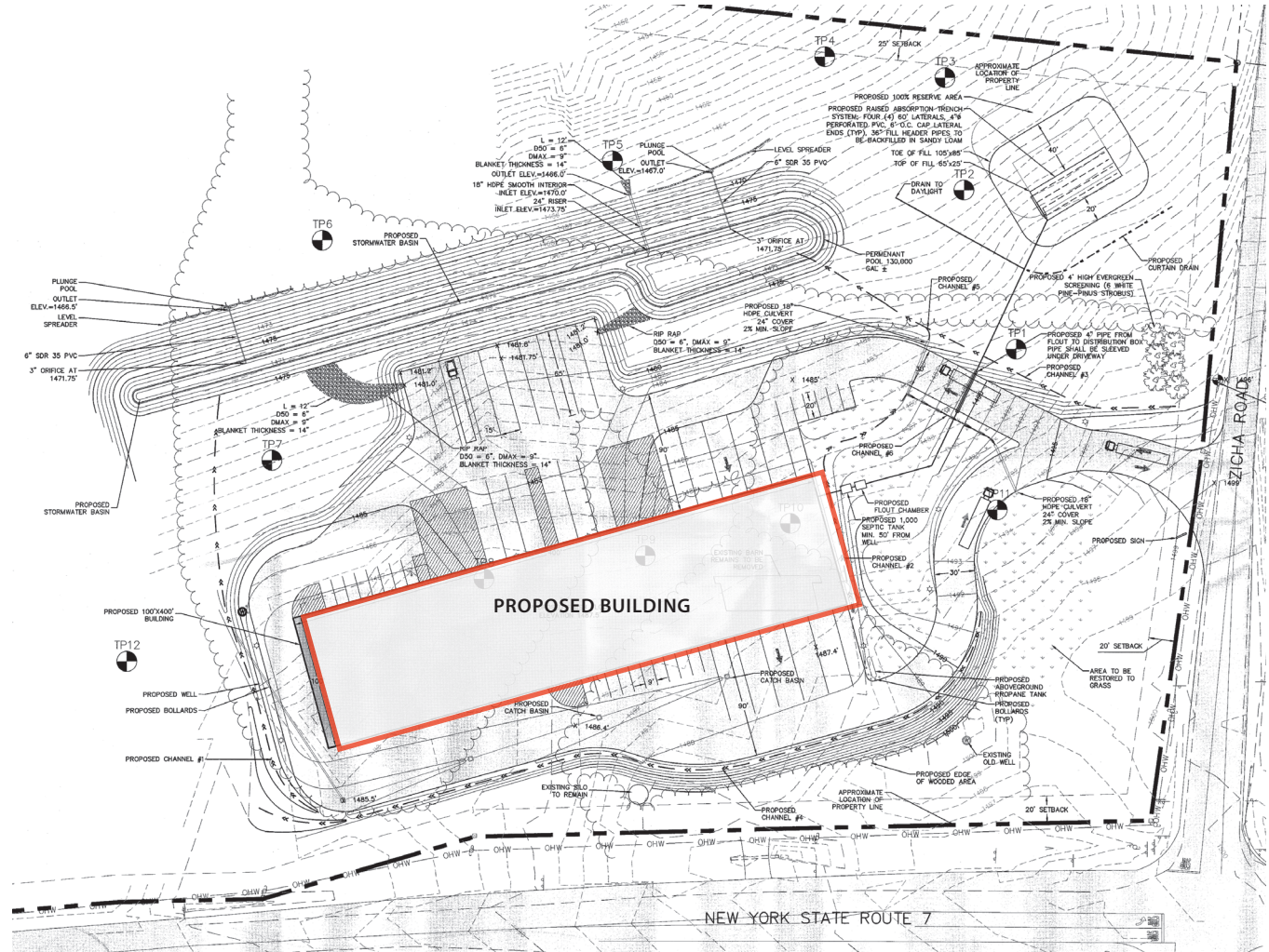

FOR MORE INFORMATION, PLEASE CONTACT:

**LAURA BELOCAS**  
M: 917.502.0647  
LBelocas@ksrny.com

**DAN SHAPIRO**  
M: 917.519.8981  
DShapiro@ksrny.com

