

FOR LEASE | RESTAURANT SPACE

0 Canal Plaza | Portland, ME



1,350± SF FREE STANDING RETAIL

- Concrete and glass circular building offers a superb location for a retail location or café
- Opportunity to join Canal Plaza where significant renovations to the ground and plaza levels will create a variety of dynamic retail options
- Located between Portland's historic Old Port and financial districts, Canal Plaza yields a unique combination of readily accessible transit, highly acclaimed restaurants, national and local retailers, and a thriving business environment

LEASE RATE: \$47.74/SF NNN

FF&E available to purchase



JOE MALONE, CCIM

207.773.2554 D

207.233.8000 C

joem@malonecb.com



JENNIFER SMALL, CCIM

207.772.6871 D

207.233.6872 C

jennifer@malonecb.com

MALONE COMMERCIAL BROKERS

5 Moulton Street • Suite 3

Portland, ME 04101

207.772.2422 • malonecb.com

PROPERTY SUMMARY

0 Canal Plaza | Portland, ME



OWNER: Cow Plaza I LLC

DEED: Book 27480, Page 310

ASSESSOR: Map 32, Block I, Lot 7001

LOT SIZE: 0.42± AC

BUILDING SIZE: 1,350± SF

YEAR BUILT: 2017

SIDING: Concrete & glass

FLOORING: Concrete

CEILING HEIGHT: 10'±

ELECTRICITY: 400 amp total

HVAC: 9 ton unit

UTILITIES: Municipal water & sewer

RESTROOM: Yes, ADA accessible

SIGNAGE: On building

ZONING: B3

CAMS: \$14.56/SF

LEASE RATE: \$47.74/SF NNN
See Broker for details



FLOOR PLAN

0 Canal Plaza | Portland, ME

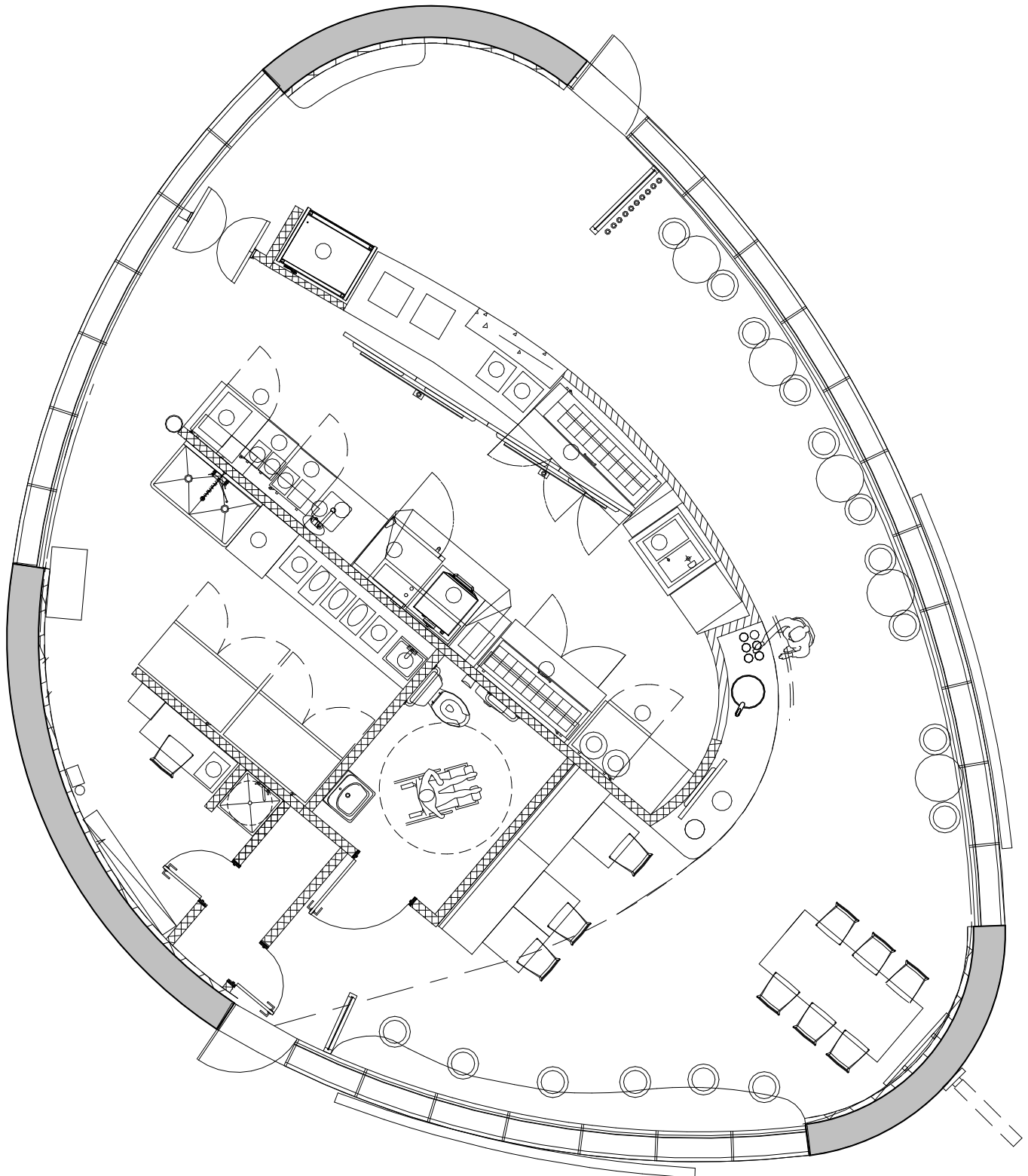

FOR LEASE | RESTAURANT SPACE

0 Canal Plaza | Portland, ME



Data SIO, NOAA, U.S. Navy, NGA, GEBCO

This document has been prepared by Malone Commercial Brokers for advertising and general information only. Malone Commercial Brokers makes no guarantees, representations or warranties of any kind, expressed or implied, regarding, but not limited to, warranties of content, accuracy, and reliability. Any interested party should undertake their own inquiries as to the accuracy of the information. Malone Commercial Brokers excludes unequivocally all informed or implied terms, conditions and warranties arising out of this document and excludes all liability for loss and damages there from. All data is subject to change of price, error, omissions, other conditions or withdrawal without notice. Malone Commercial Brokers is acting as the Seller's/Lessor's agent in the marketing of this property.



JOE MALONE, CCIM

207.773.2554 D

207.233.8000 C

joe@malonecb.com



JENNIFER SMALL, CCIM

207.772.6871 D

207.233.6872 C

jennifer@malonecb.com

MALONE COMMERCIAL BROKERS

5 Moulton Street • Suite 3

Portland, ME 04101

207.772.2422 • malonecb.com