

# SOUTH DOWNTOWN MIXED-USE FOR LEASE | Industrial | Flex Space



**HUGHES**  
CAPITAL  
HOLDINGS



215 W. Grant Street, Orlando, FL 32806

## PROPERTY FEATURES

ASKING RATE: \$12 / SF NNN

### BUILDING #4 : 29,200± SF - AVAILABLE FOR LEASE

- Flex Space / Office / Industrial
- Office: 2,500 SF
- Construction: Block/Metal
- Clear Height: +24' / Clear Span
- Loading:
  - (5) 10' x 10' Dock High Doors
  - (2) Vehicle Ramps into Building
- Surface Parking
- Fire Protection: Wet System

### OVERALL SITE

- No Interior Building Support Columns
- Electrical Service: 3 Phase | 240 Volts
- Utilities: OUC
- Land Size: 6 +/- acres
- Less than 2 miles to downtown
- Easy access to I-4, SR 408, Orange Avenue & Blossom Trail.
- Exterior site lighting, Fully Landscaped, Multiple Access Points.

## CONTACT

Patrick Hughes, Senior Development Manager  
407-770-2581 | [phughes@hughes-capital.com](mailto:phughes@hughes-capital.com)  
1150 Louisiana Ave. Unit 3 | Winter Park, FL 32789 | [www.hughes-capital.com](http://www.hughes-capital.com)

No warranty or representation, express or implied, is made as to the accuracy of the information contained herein, and same is submitted subject to errors, omissions, change of price, rental or other conditions, withdrawal without notice, and to any special listing conditions imposed by our principals.



# SOUTH DOWNTOWN MIXED-USE FOR LEASE | Industrial | Flex Space



**HUGHES**  
CAPITAL  
HOLDINGS

## SITE PLAN

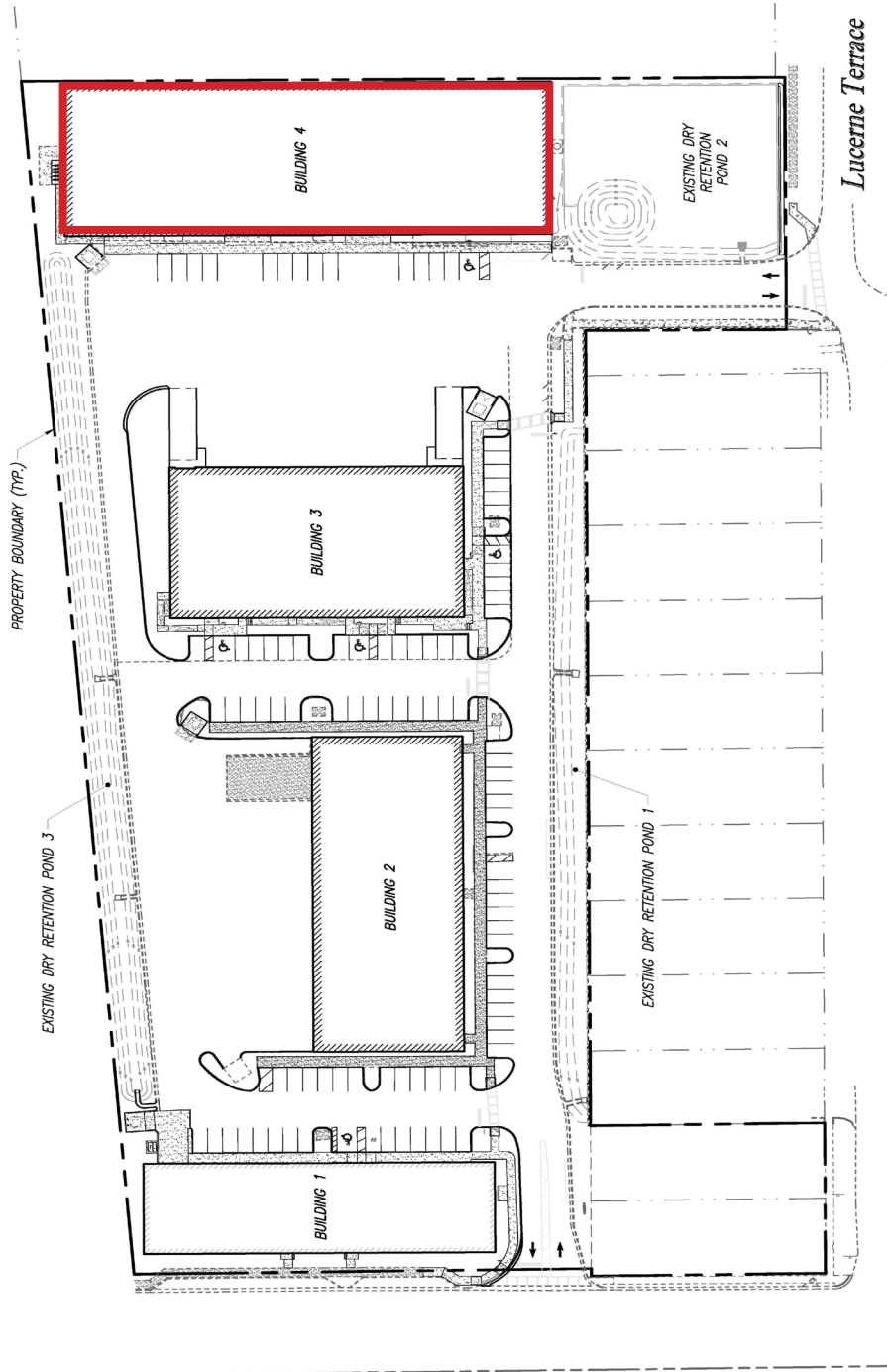

### AVAILABLE FOR LEASE:

#### Building #4:

29,200 SF - Flex / Industrial Space

### FUTURE PHASES:

#### Building #3:

19,000 SF - Flex / Industrial Space

### CURRENTLY LEASED:

#### Building #1:

12,600 SF - Flex / Industrial Space

#### Building #2:

18,900 SF - Flex / Industrial Space

## CONTACT

Patrick Hughes, Senior Development Manager  
407-770-2581 | [phughes@hughes-capital.com](mailto:phughes@hughes-capital.com)  
1150 Louisiana Ave. Unit 3 | Winter Park, FL 32789 | [www.hughes-capital.com](http://www.hughes-capital.com)

No warranty or representation, express or implied, is made as to the accuracy of the information contained herein, and same is submitted subject to errors, omissions, change of price, rental or other conditions, withdrawal without notice, and to any special listing conditions imposed by our principals.



# SOUTH DOWNTOWN MIXED-USE FOR LEASE | Industrial | Flex Space



**HUGHES**  
CAPITAL  
HOLDINGS

## LOCATION AERIAL

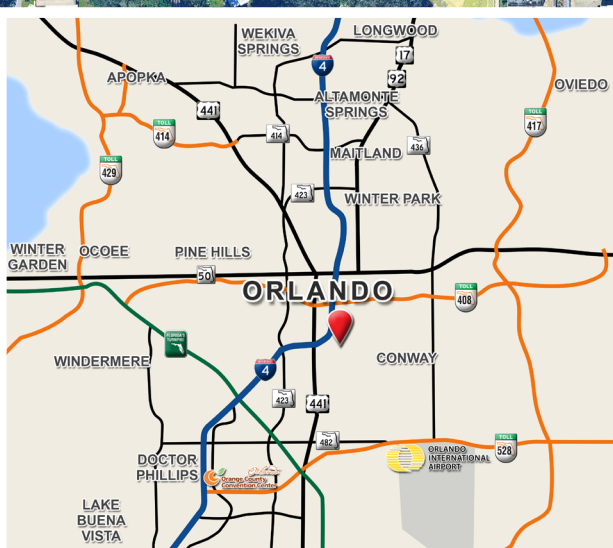
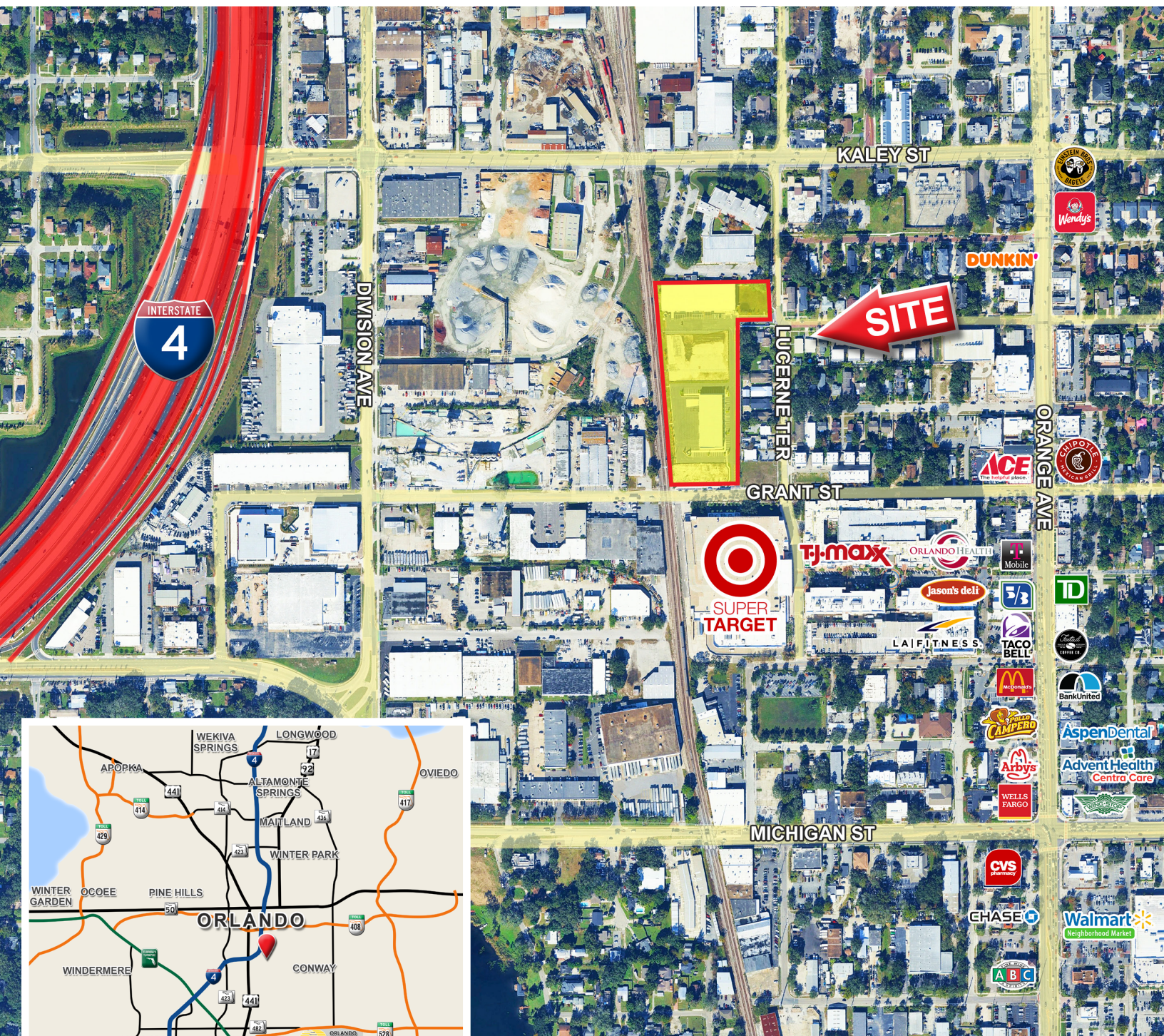

## CONTACT

Patrick Hughes, Senior Development Manager  
407-770-2581 | [phughes@hughes-capital.com](mailto:phughes@hughes-capital.com)  
1150 Louisiana Ave. Unit 3 | Winter Park, FL 32789 | [www.hughes-capital.com](http://www.hughes-capital.com)

No warranty or representation, express or implied, is made as to the accuracy of the information contained herein, and same is submitted subject to errors, omissions, change of price, rental or other conditions, withdrawal without notice, and to any special listing conditions imposed by our principals.



# SOUTH DOWNTOWN MIXED-USE FOR LEASE | Industrial | Flex Space



**HUGHES**  
CAPITAL  
HOLDINGS

## PHOTOS



## CONTACT

Patrick Hughes, Senior Development Manager  
407-770-2581 | [phughes@hughes-capital.com](mailto:phughes@hughes-capital.com)  
1150 Louisiana Ave. Unit 3 | Winter Park, FL 32789 | [www.hughes-capital.com](http://www.hughes-capital.com)

No warranty or representation, express or implied, is made as to the accuracy of the information contained herein, and same is submitted subject to errors, omissions, change of price, rental or other conditions, withdrawal without notice, and to any special listing conditions imposed by our principals.